



CETTE NOTICE EST UNIQUEMENT VALABLE POUR
LE MONTAGE DE LA SERRURE 1 PT – MODÈLE M ET XL

NOTICE DE MONTAGE KIT 3 POINTS ET 1 POINT



JUMPY / EXPERT III (2016 à ce jour)



TOYOTA PROACE II (2016 à ce jour)

OPEL VIVARO (2019 à ce jour)



FIAD SCUDO 2022

ASSA ABLOY

Une marque du Groupe ASSA

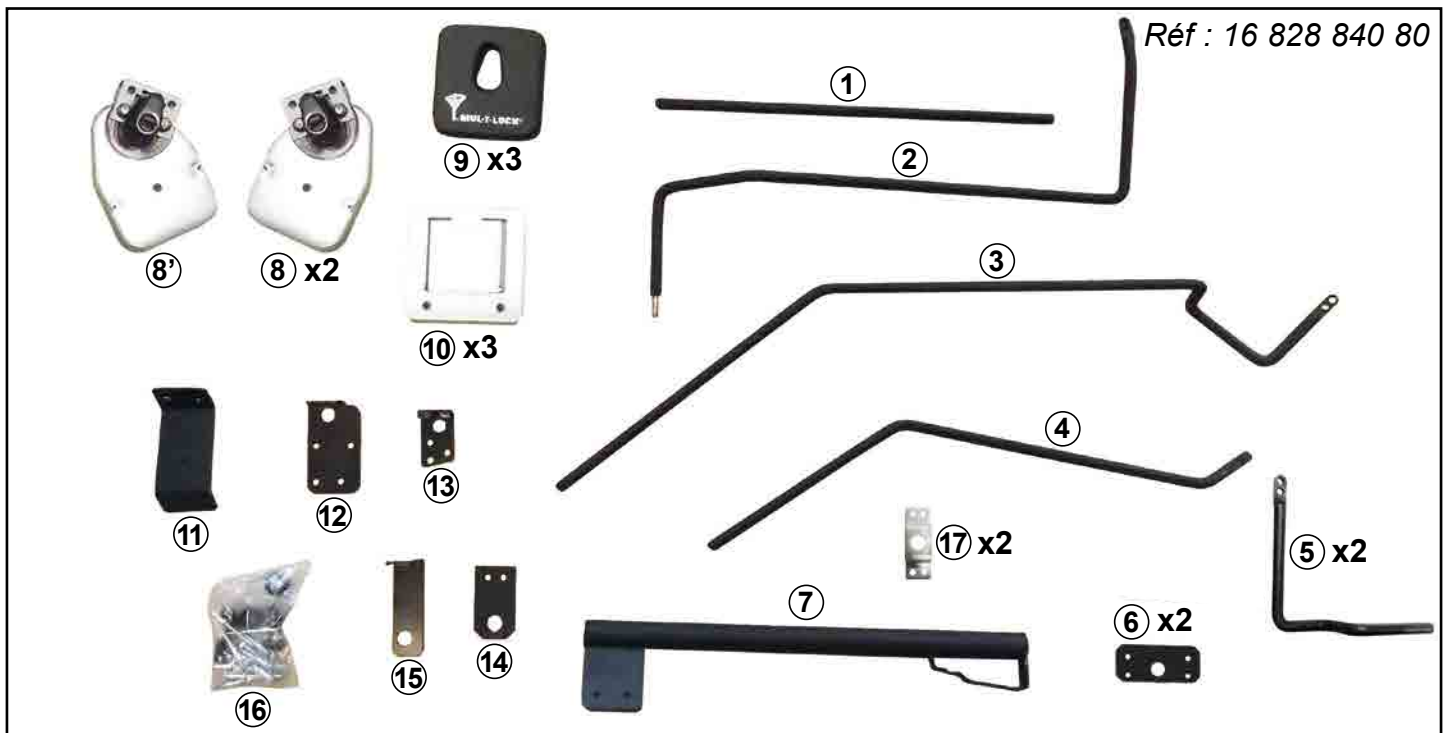
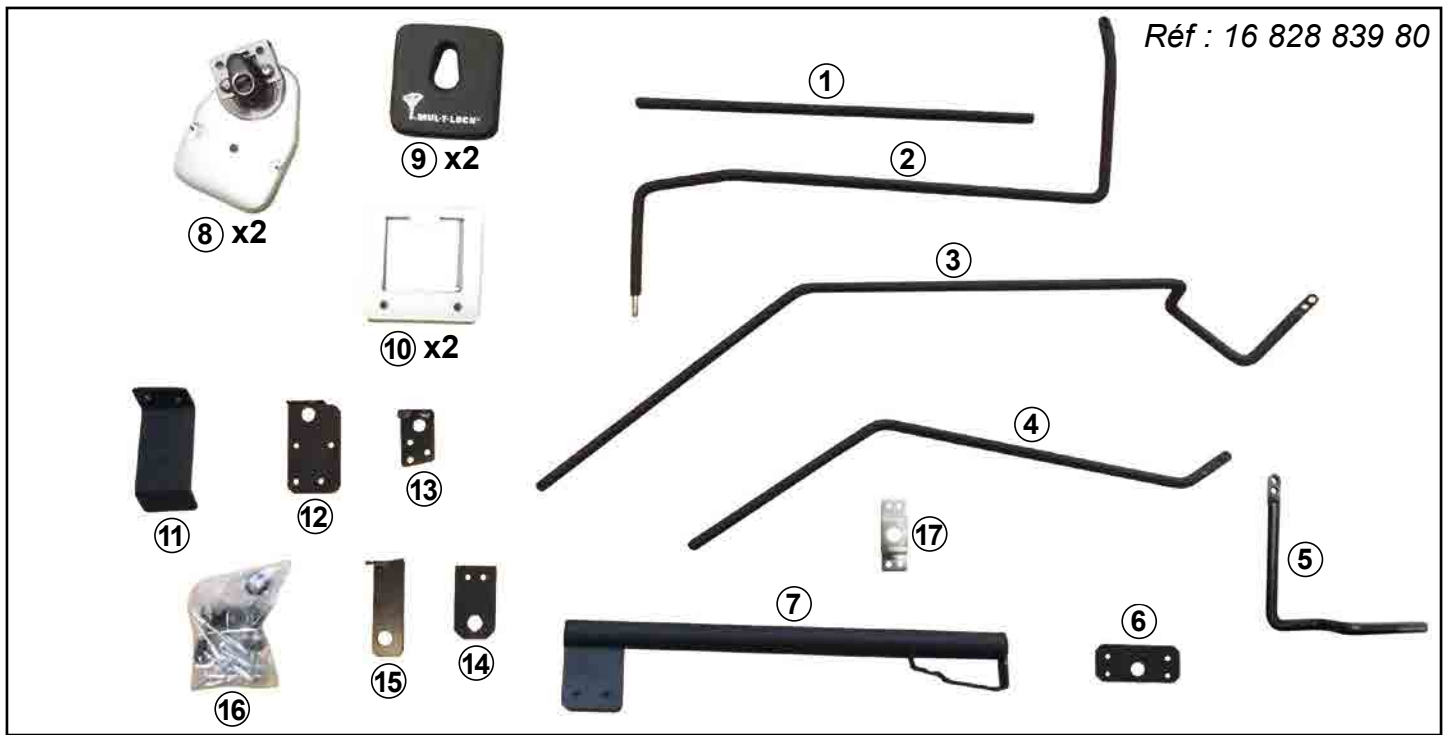

9981.17



9735.CZ

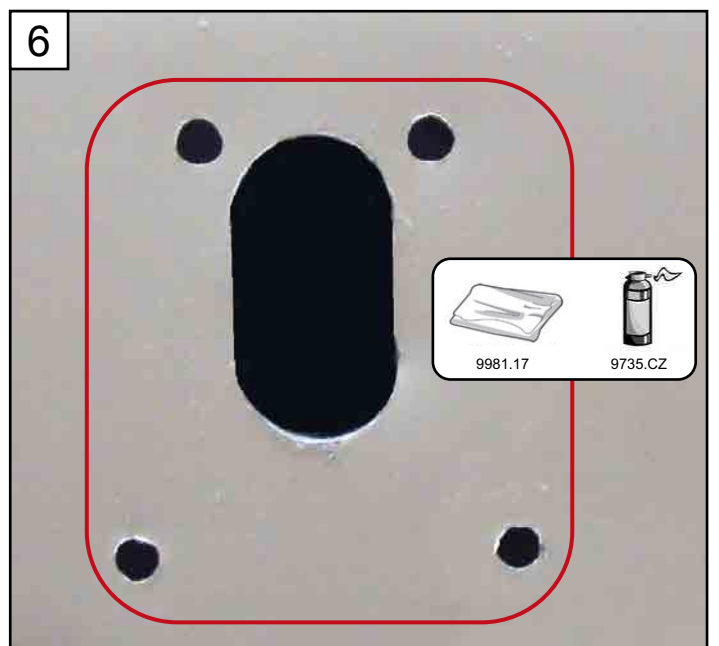
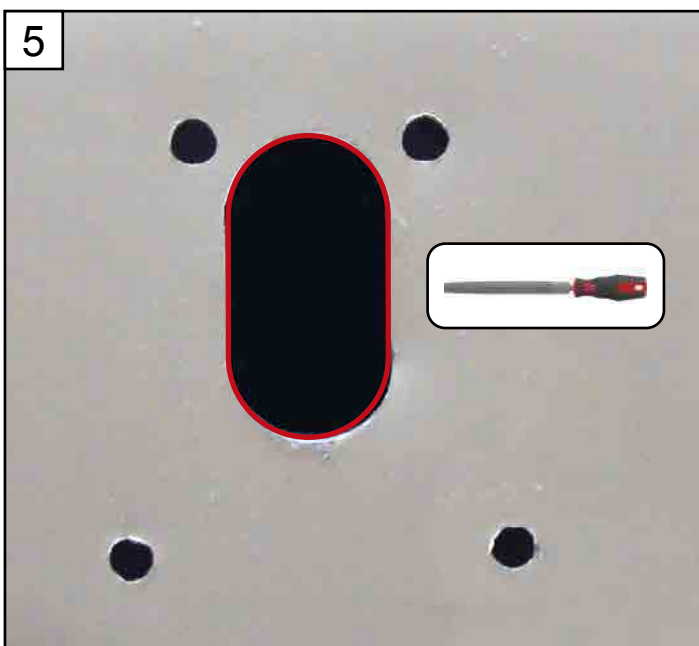
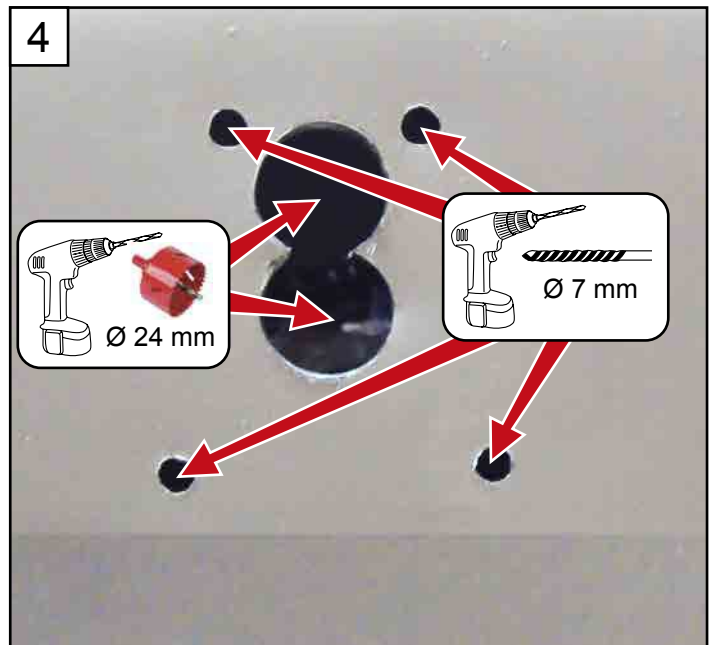
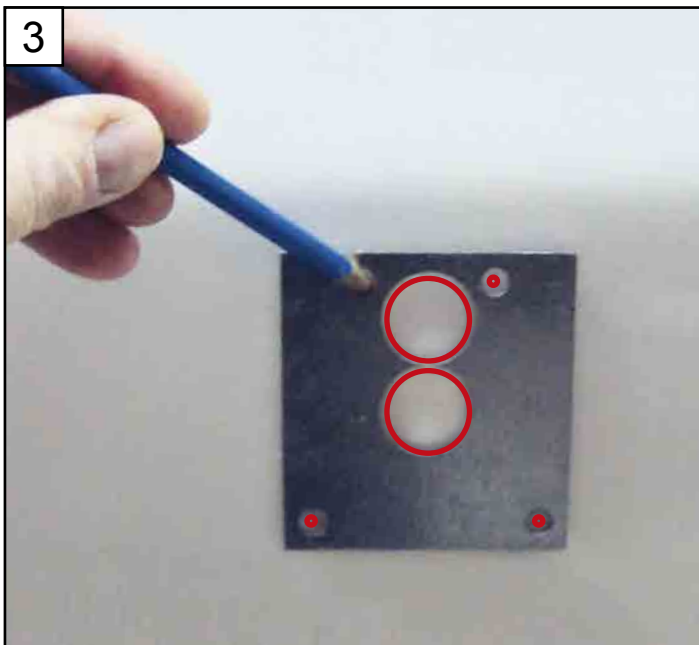
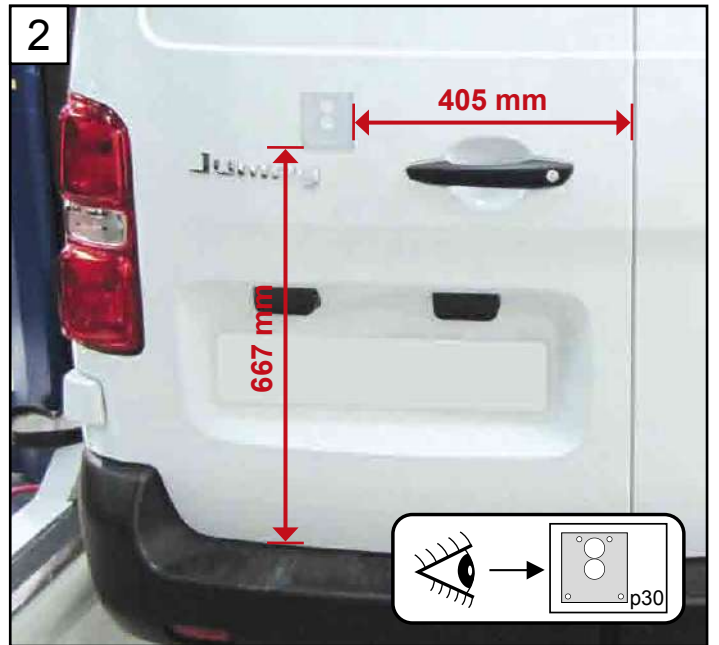
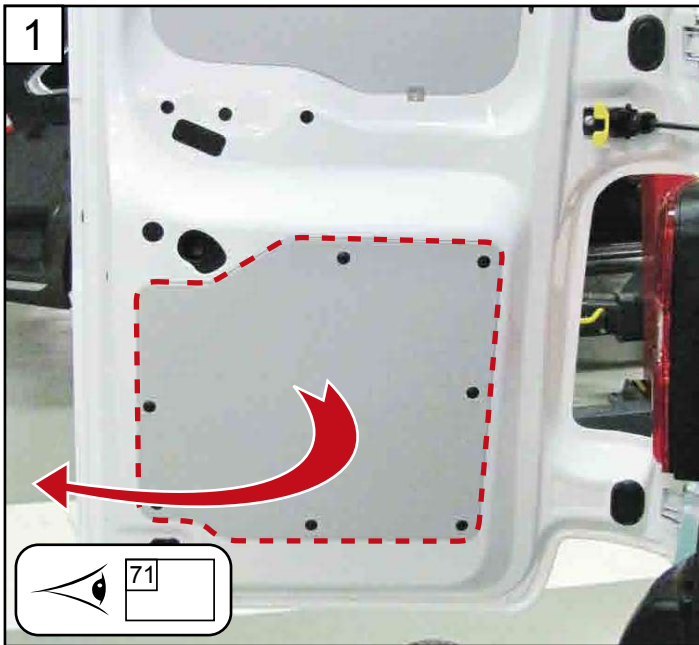

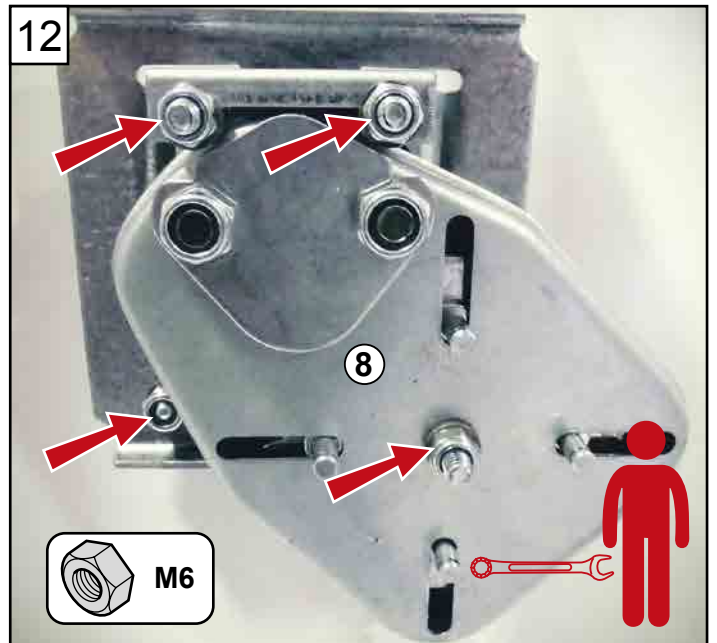
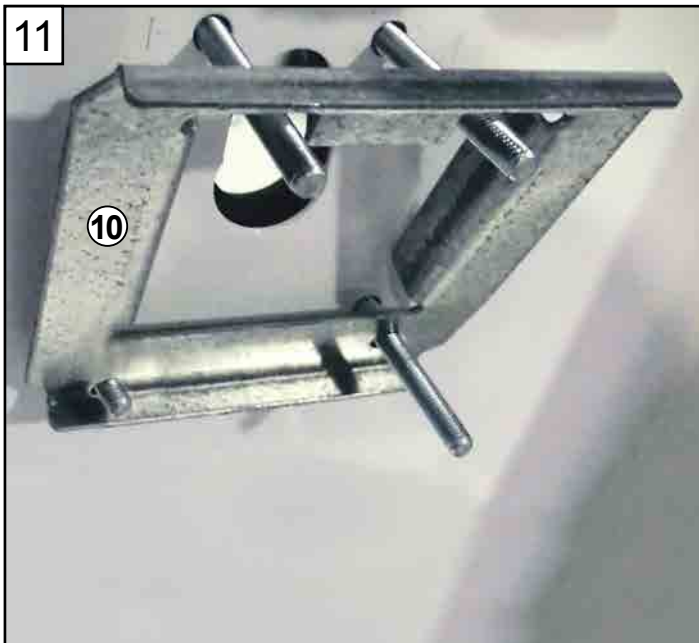
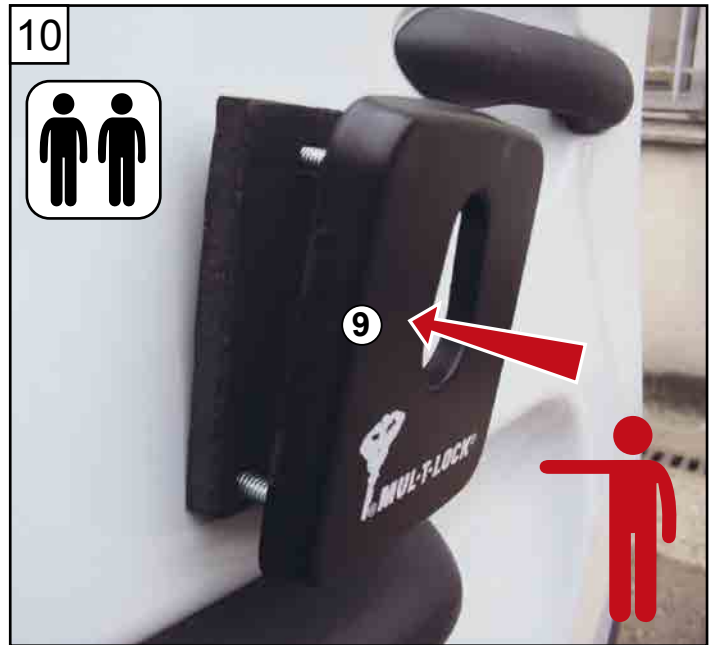
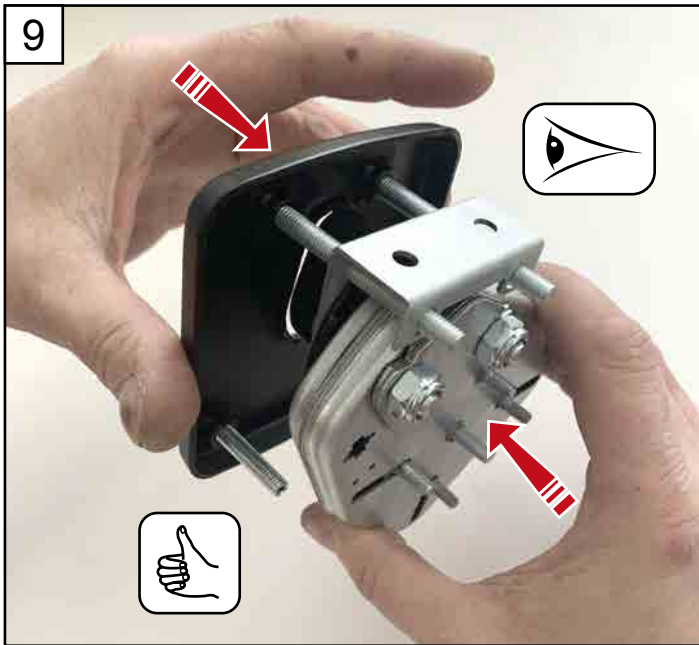
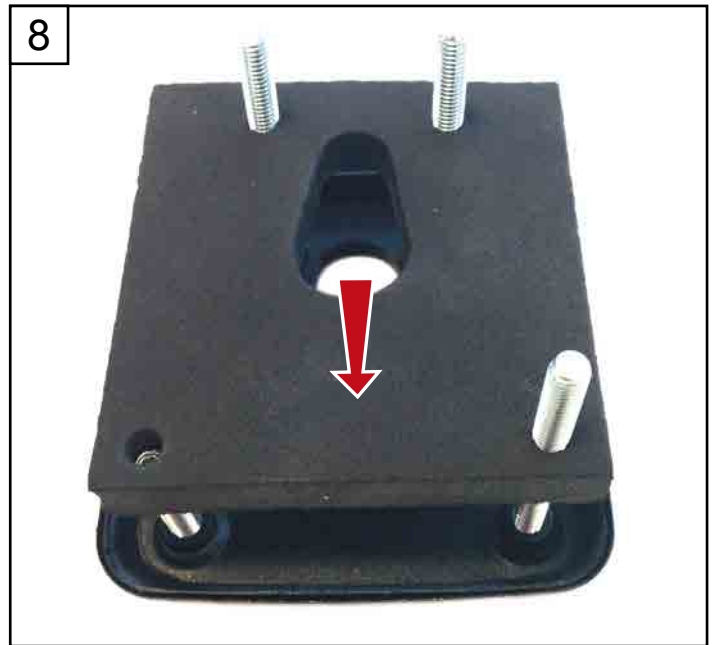
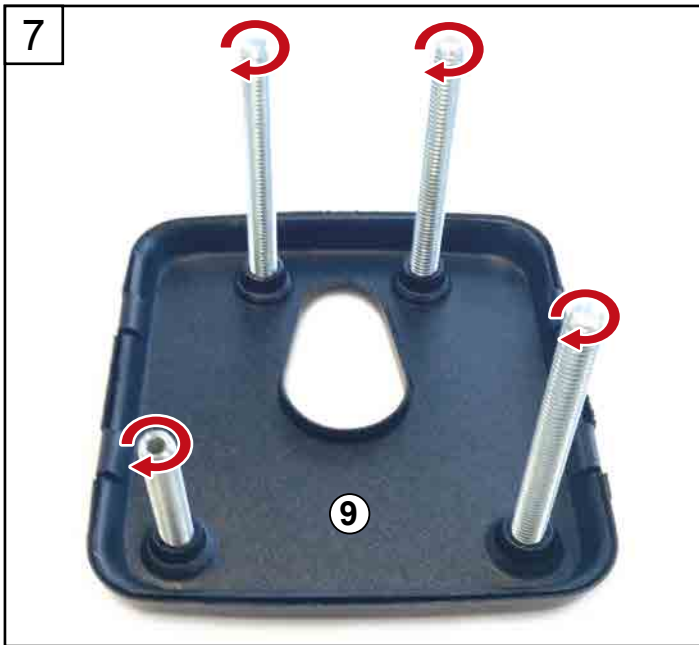

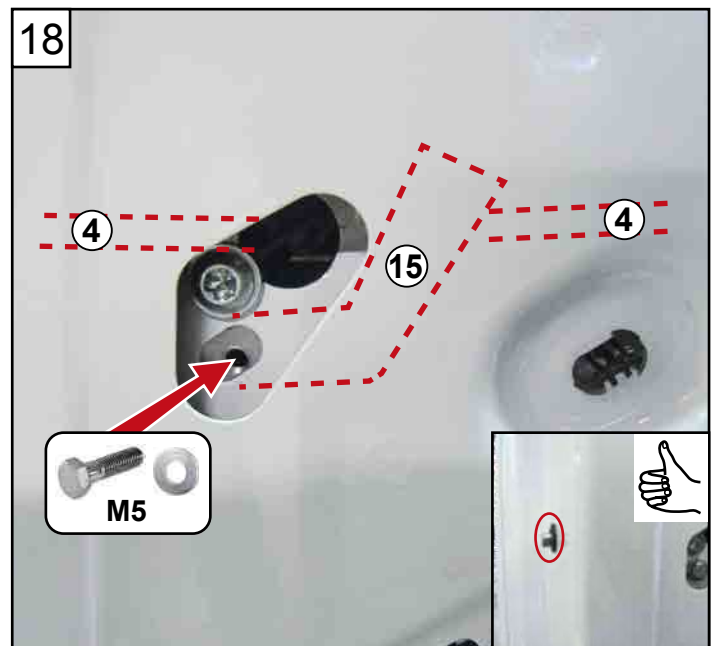
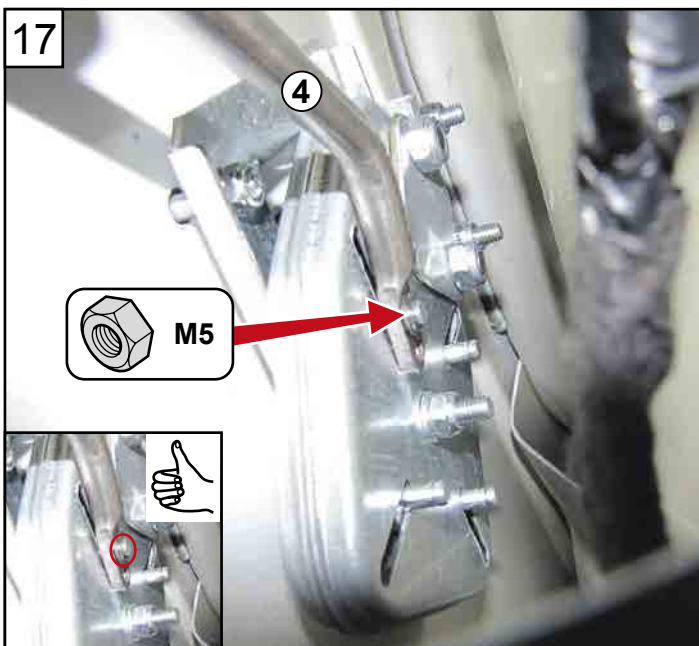
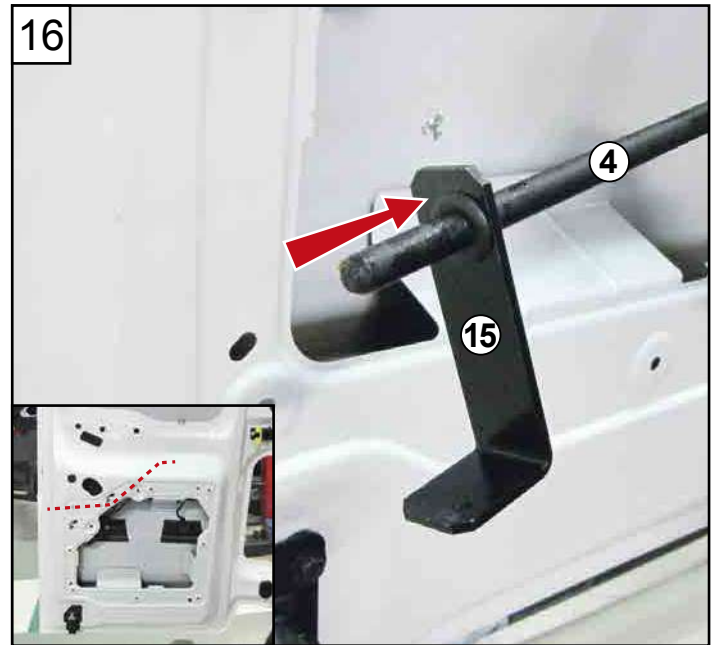
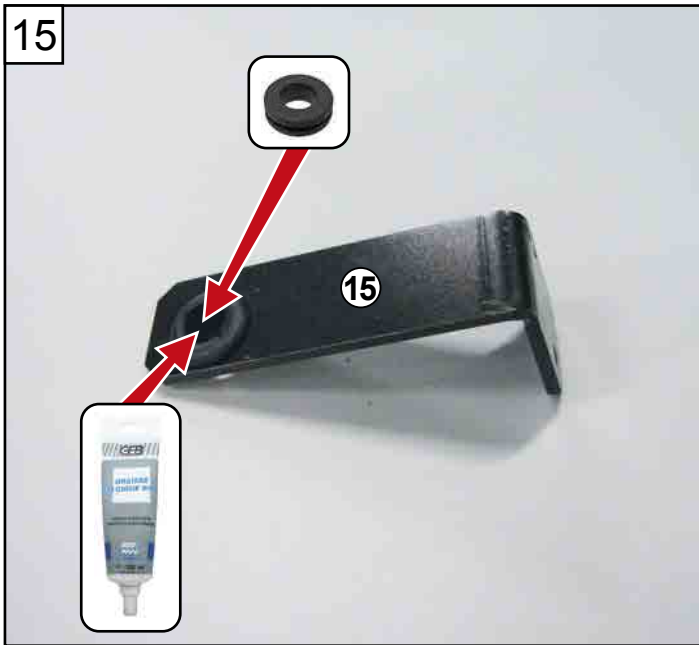
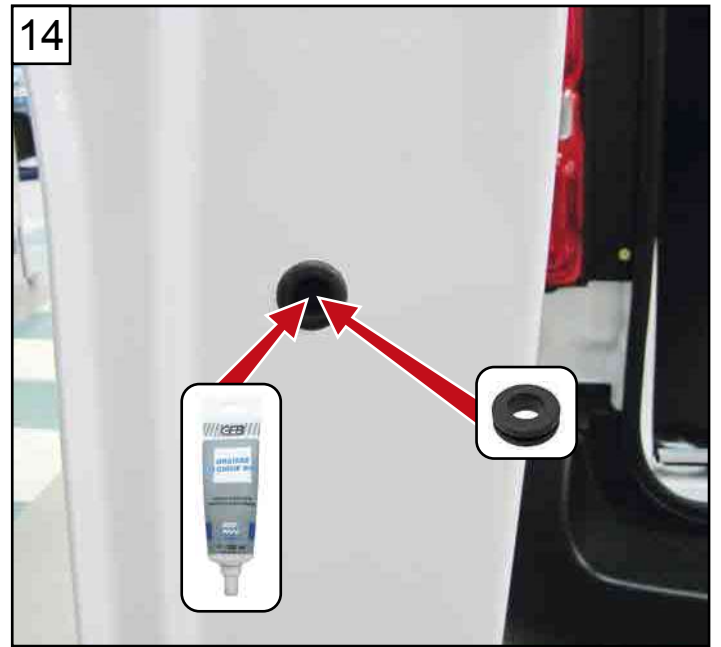
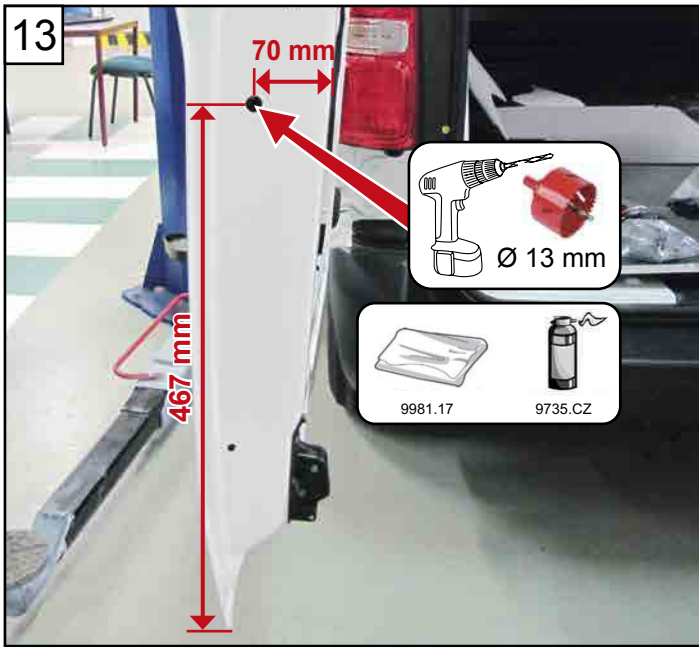

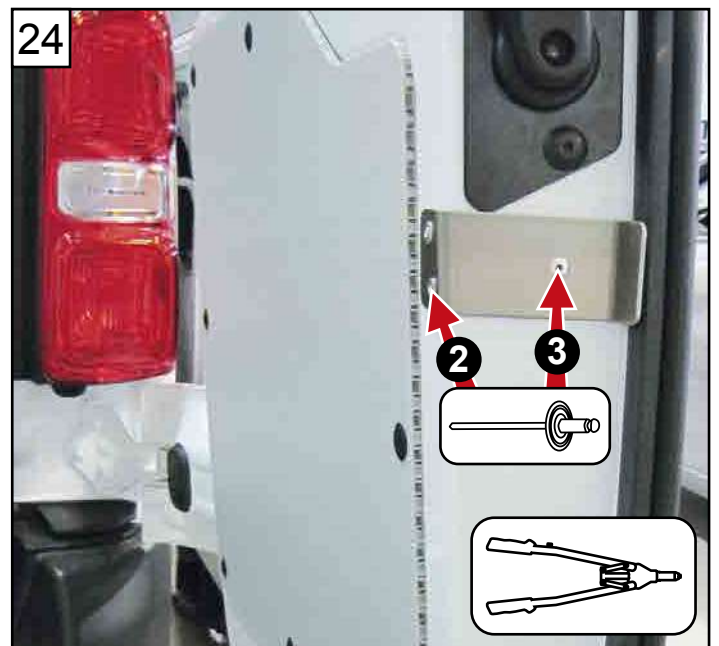
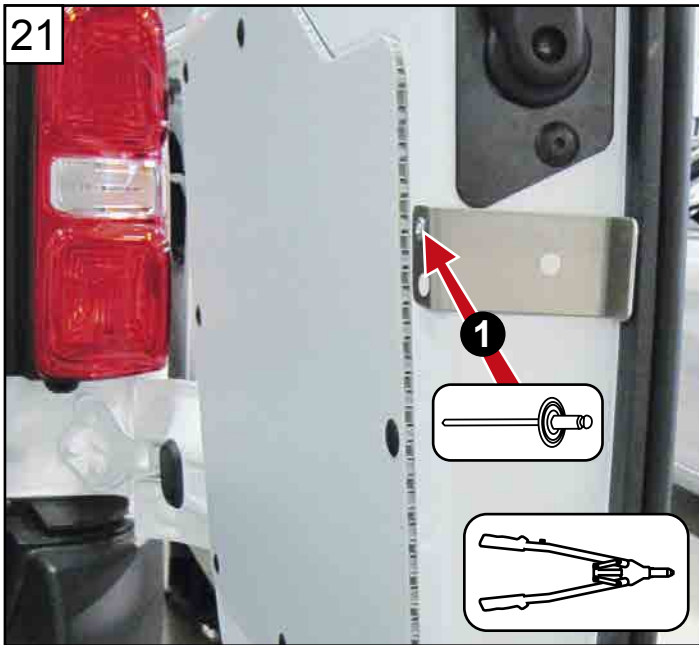
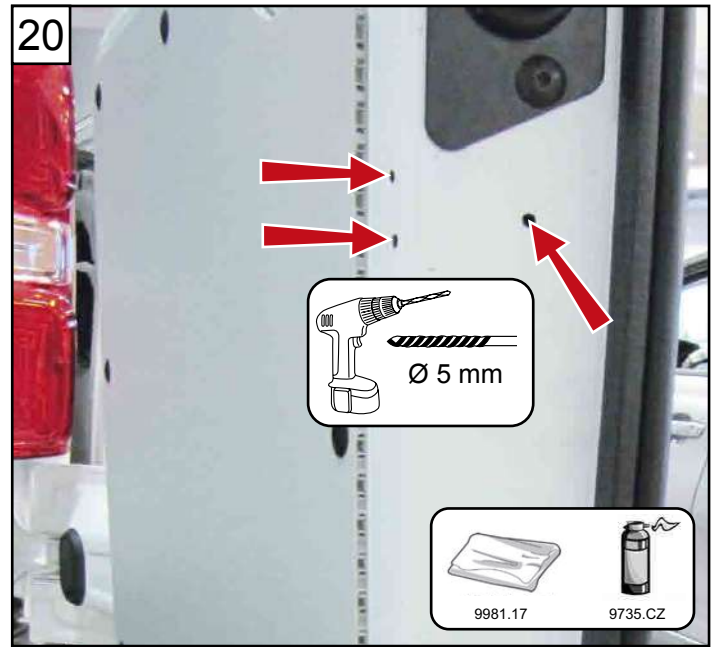
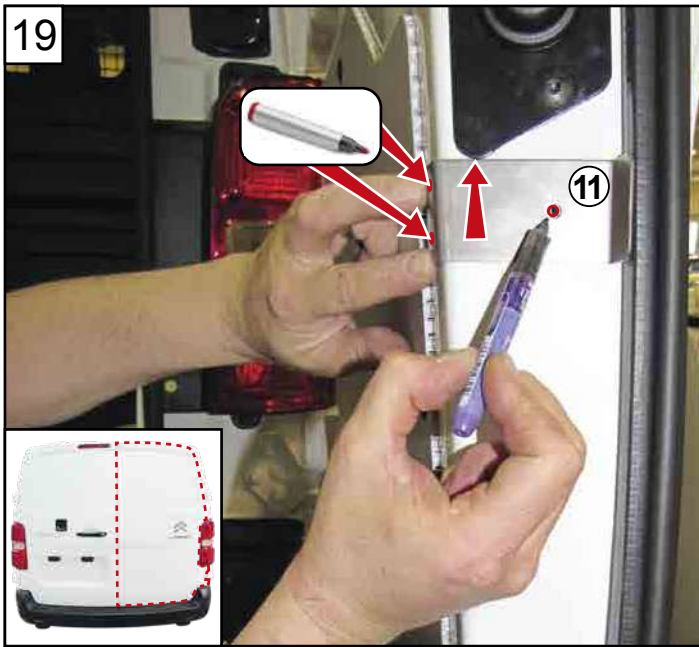

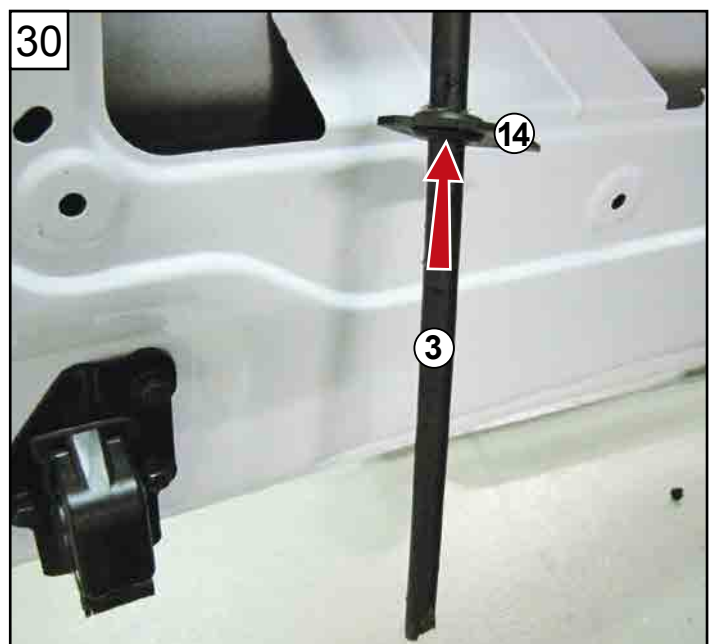
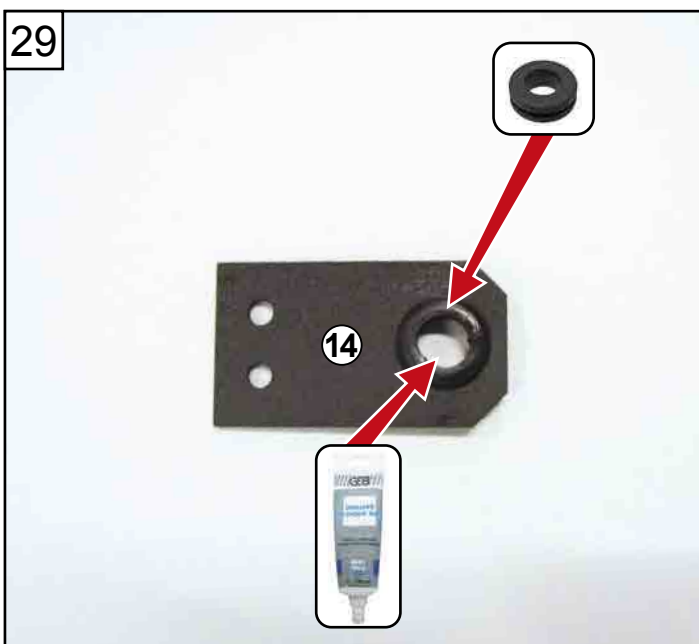
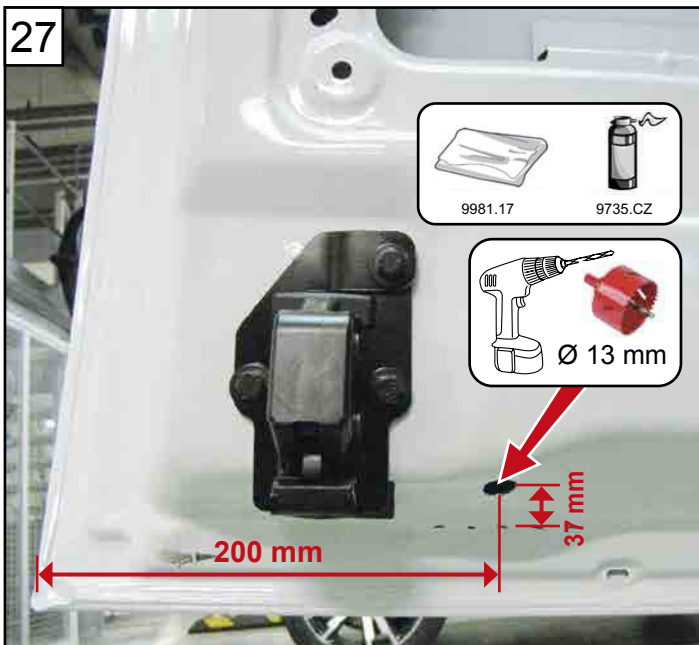
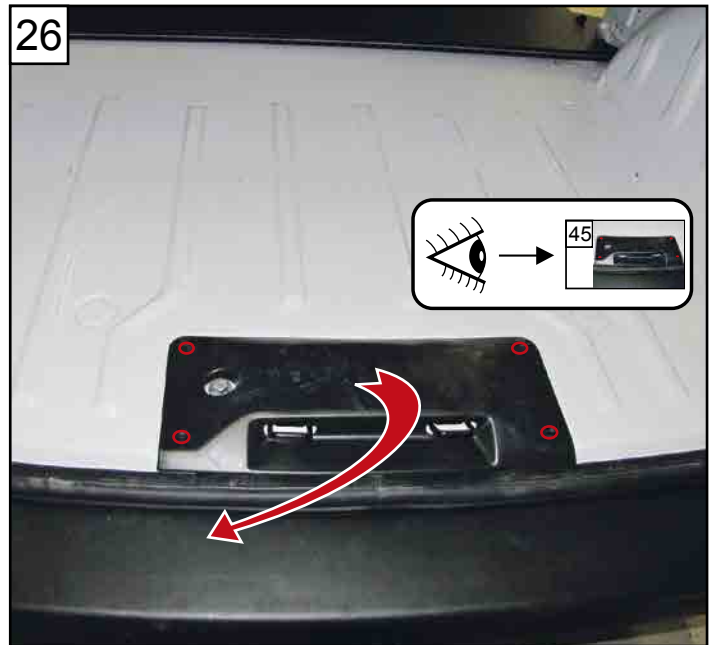

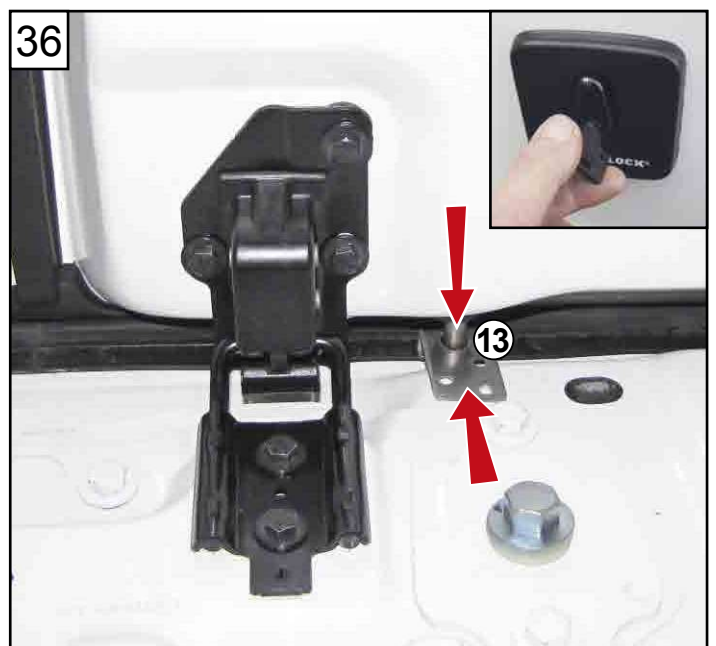
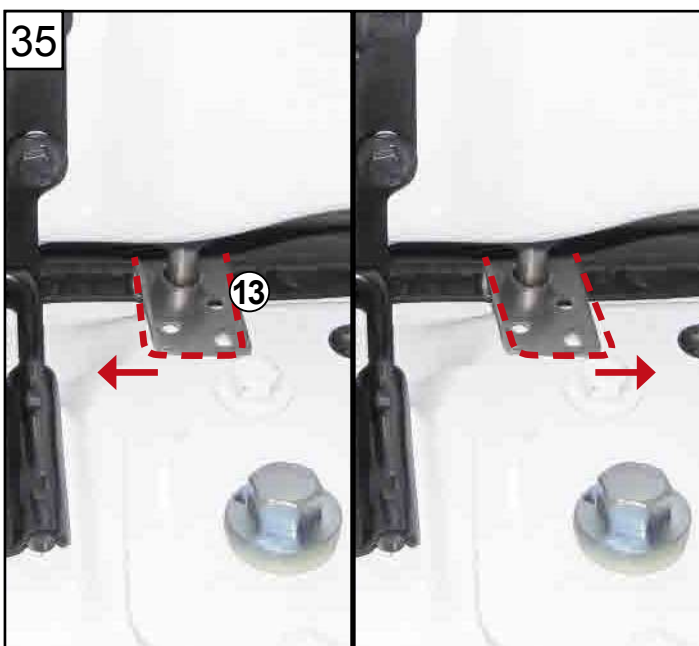
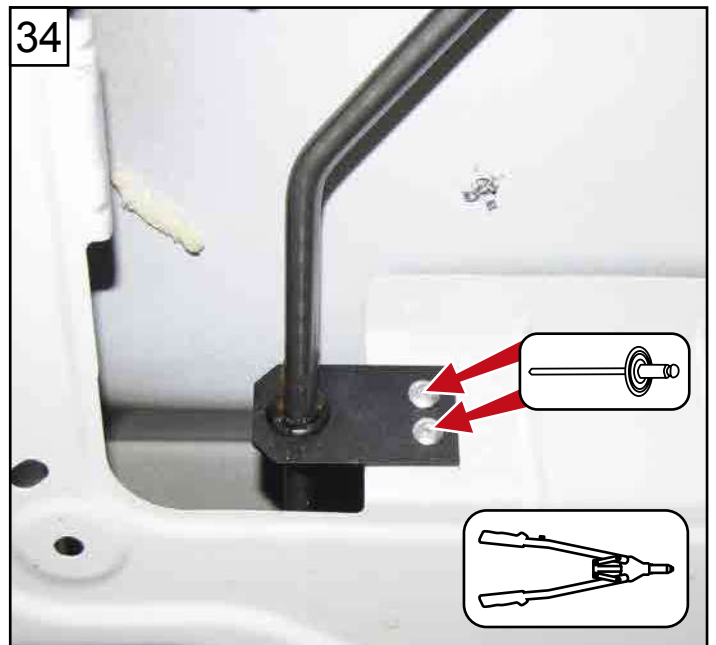
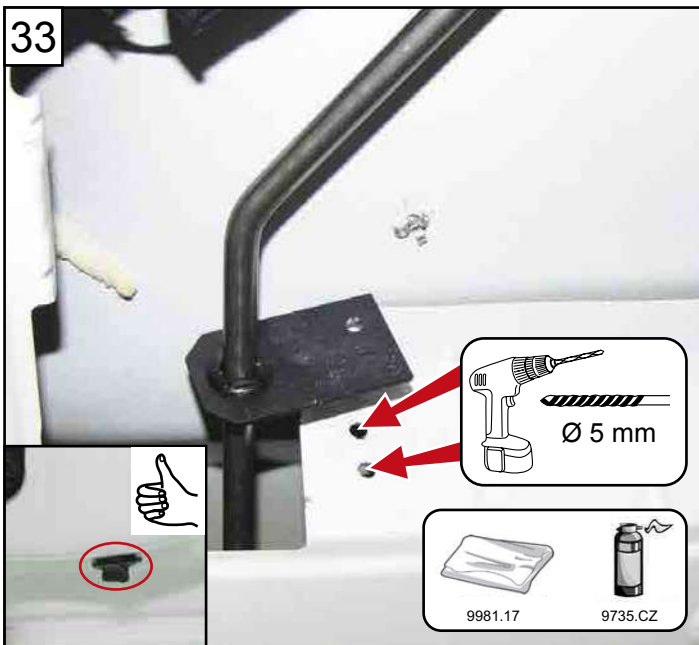
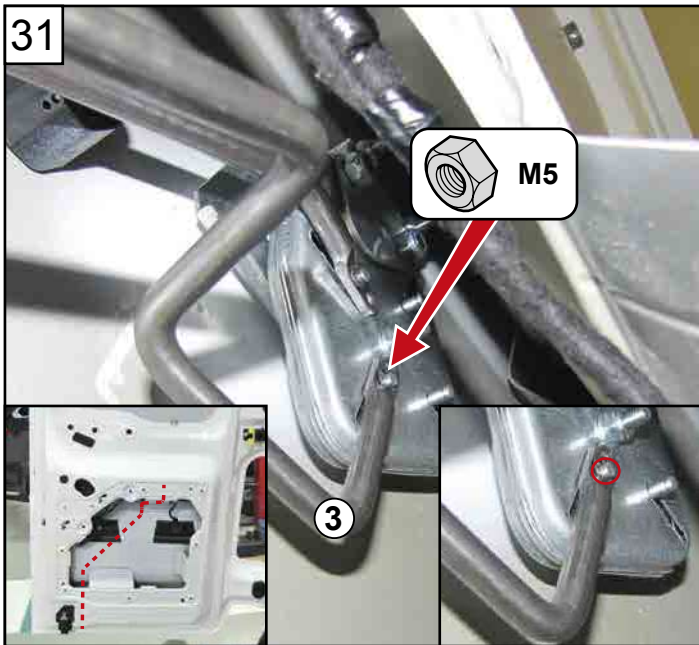

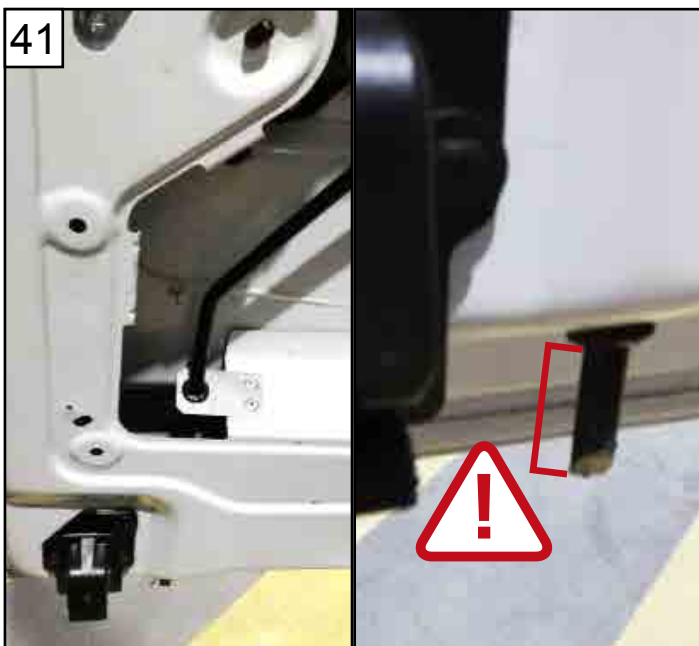
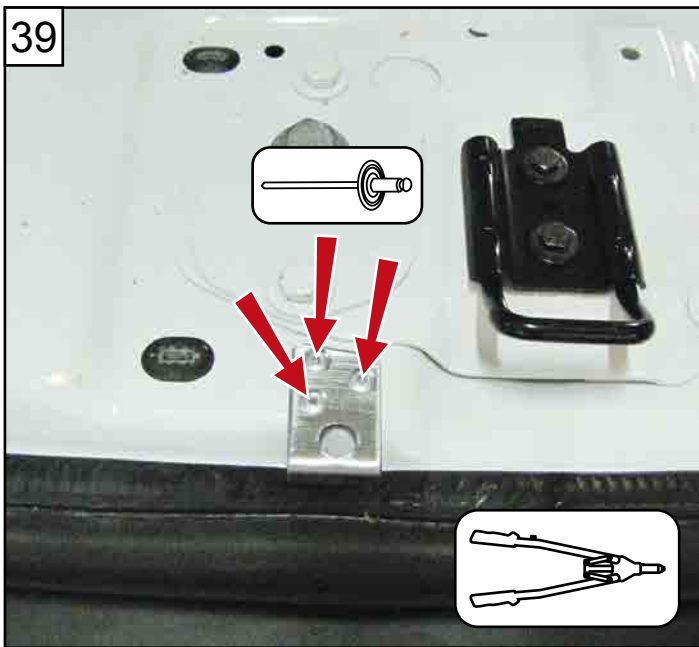
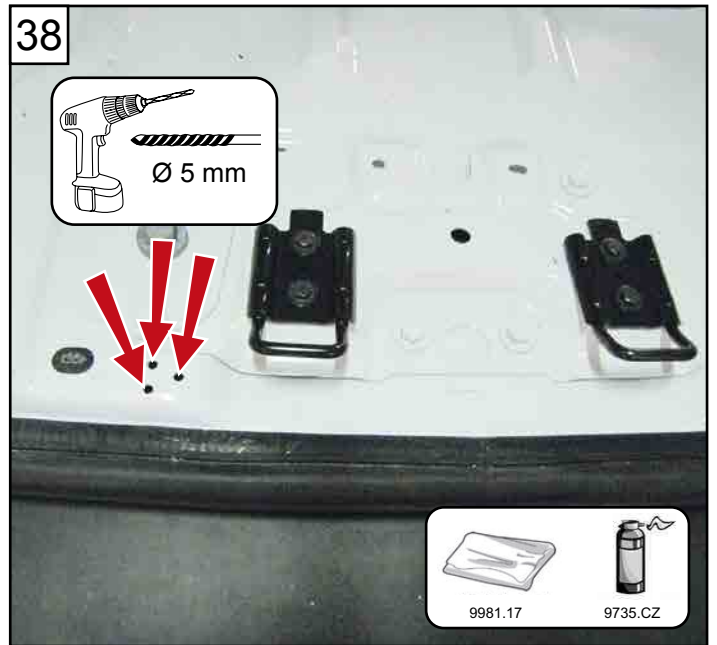
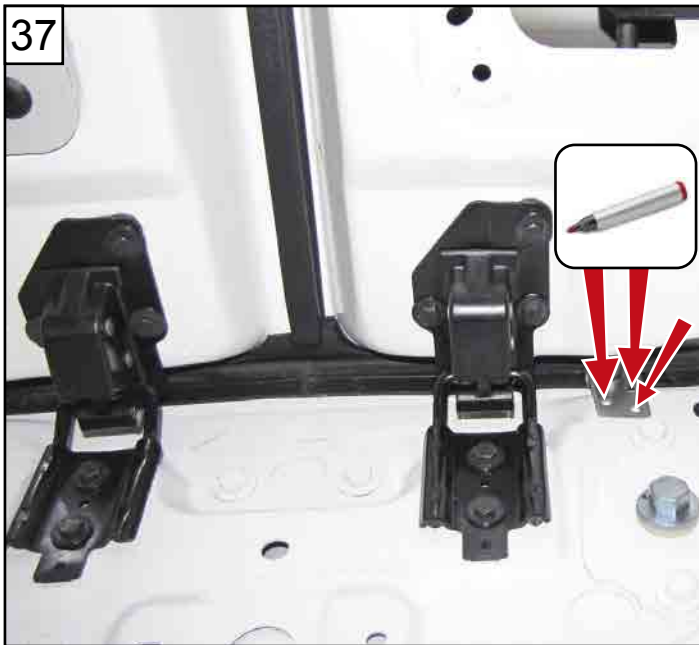

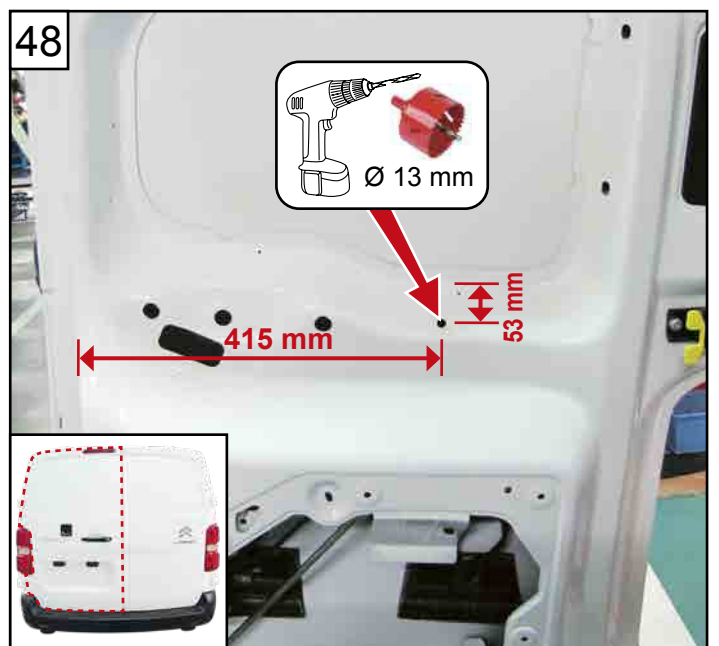

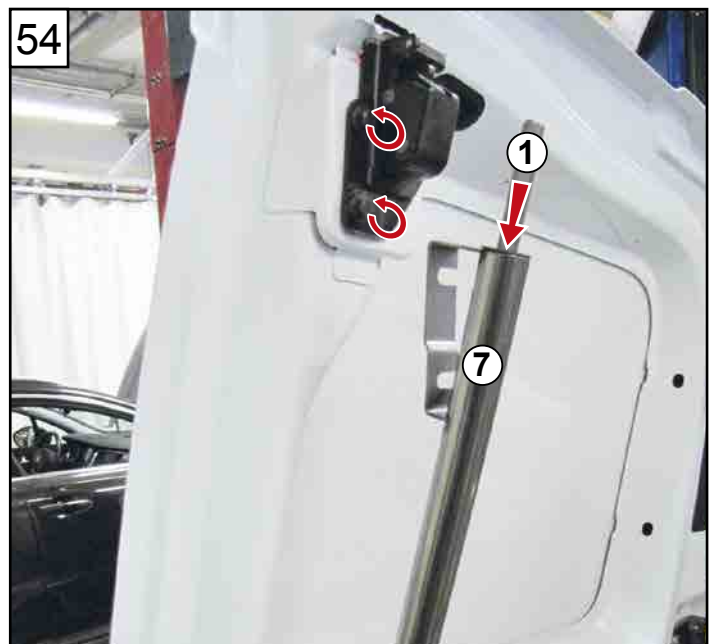
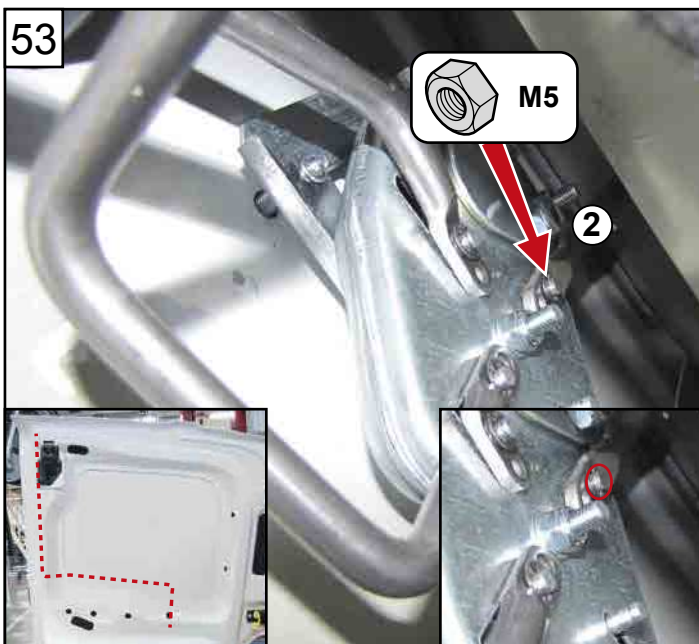
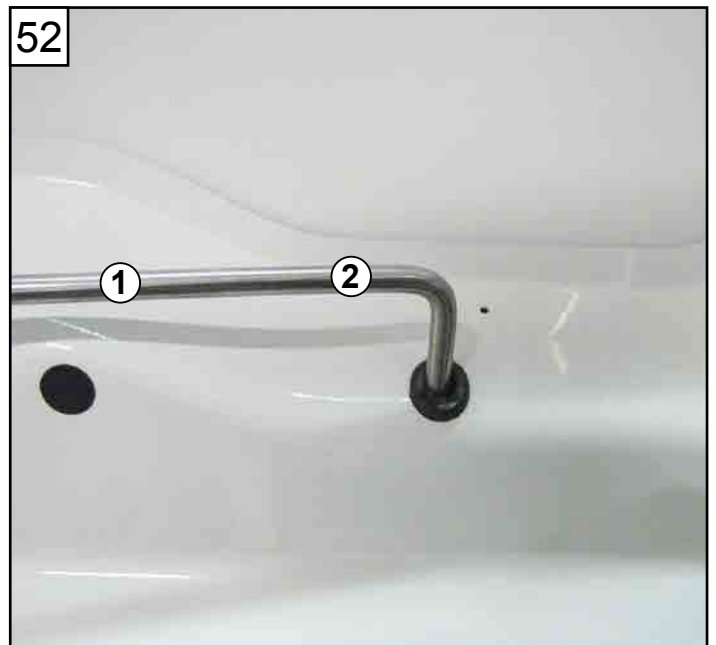
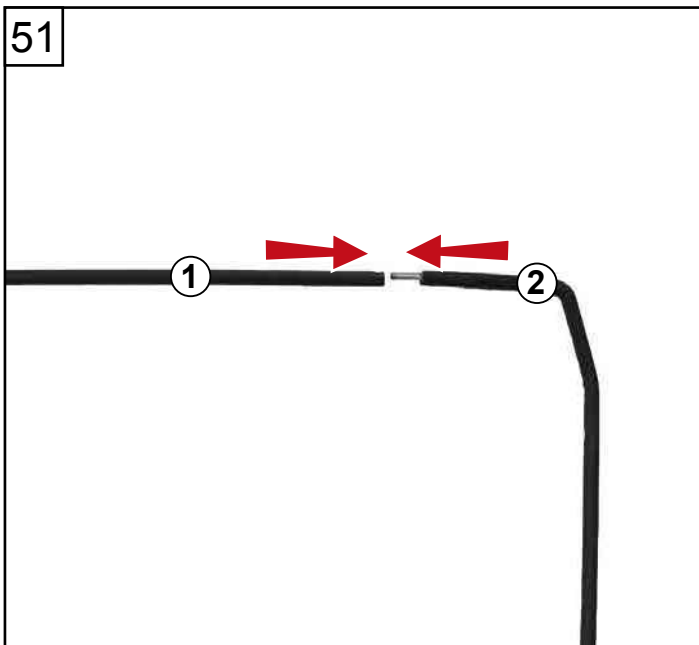
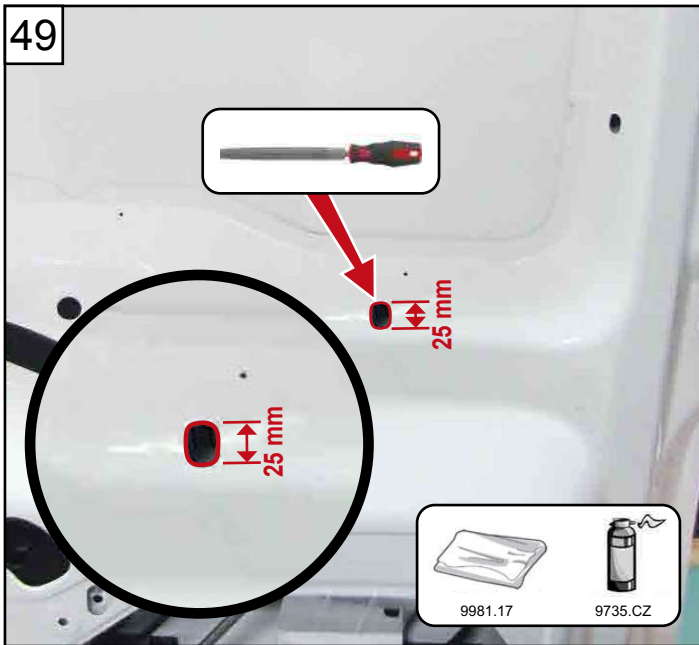

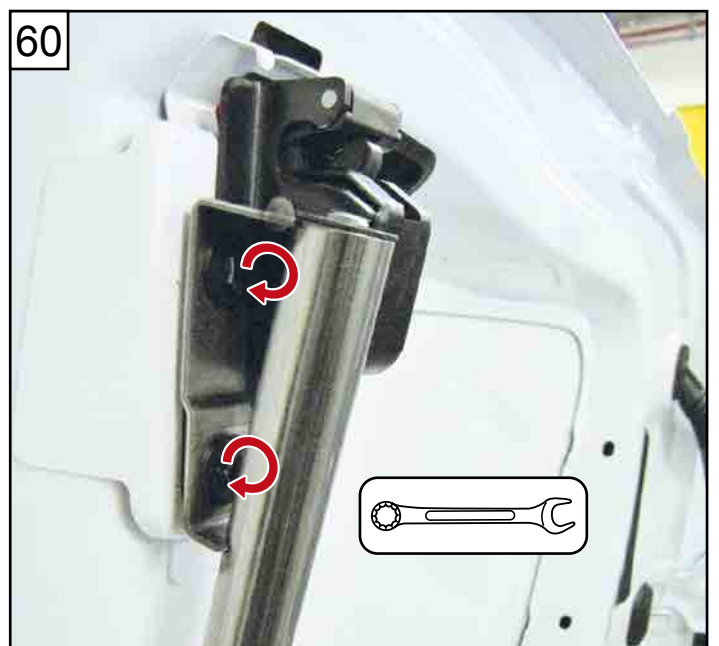
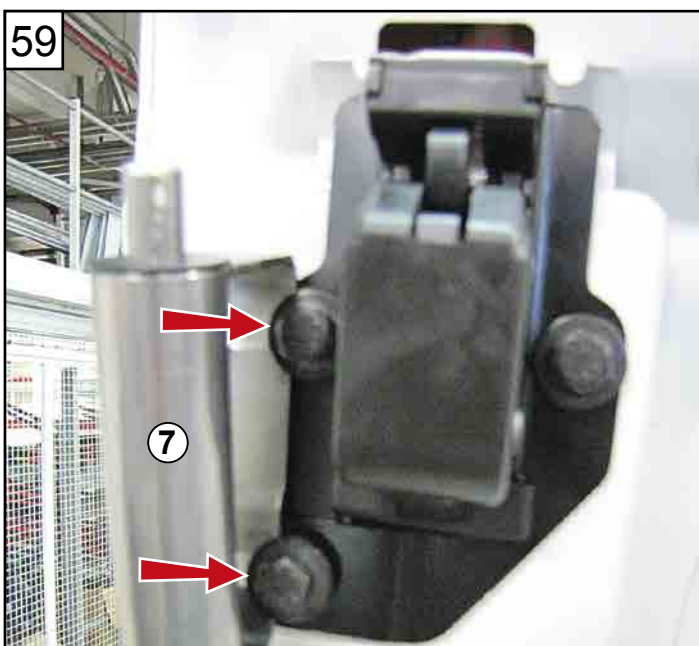
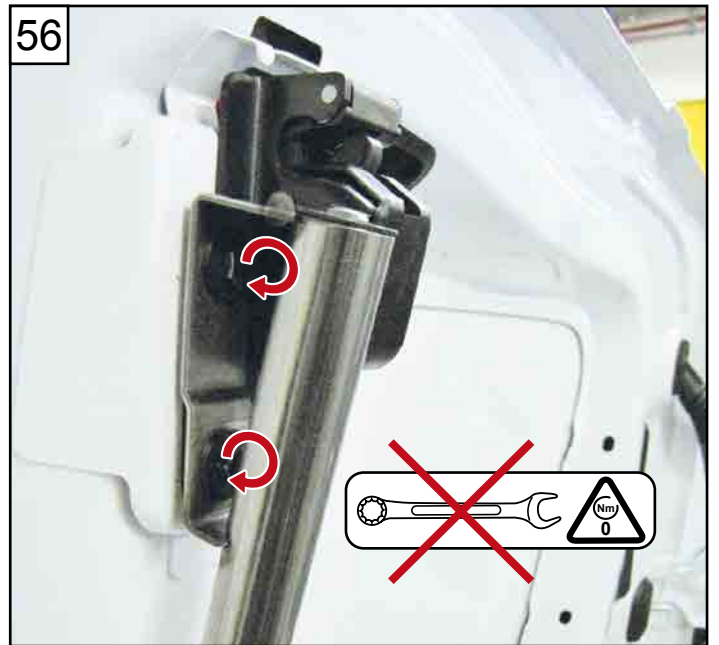
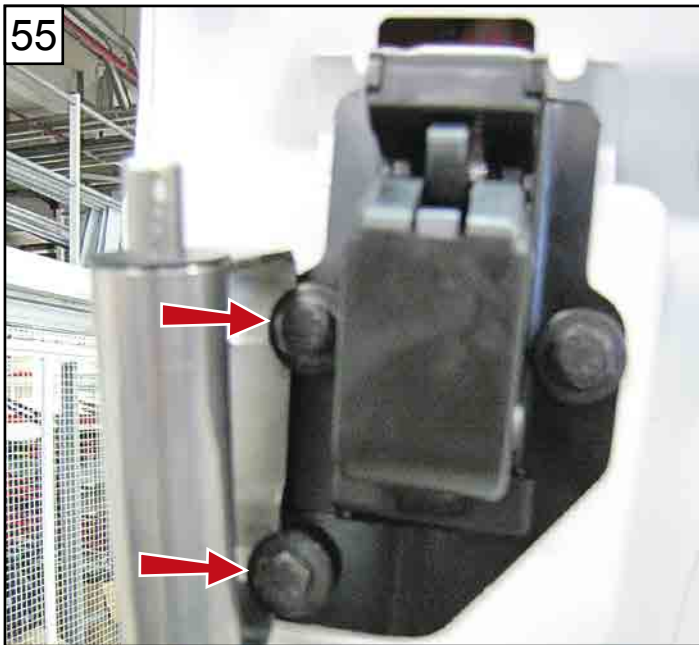

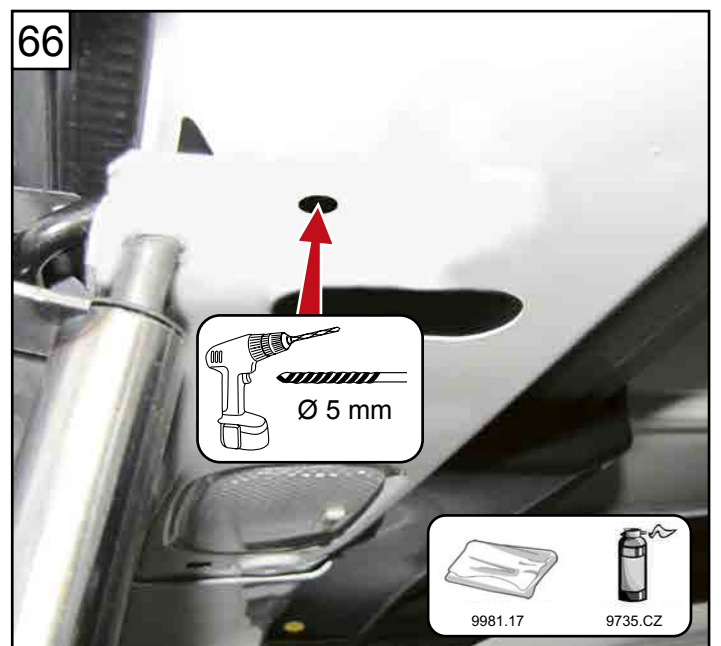
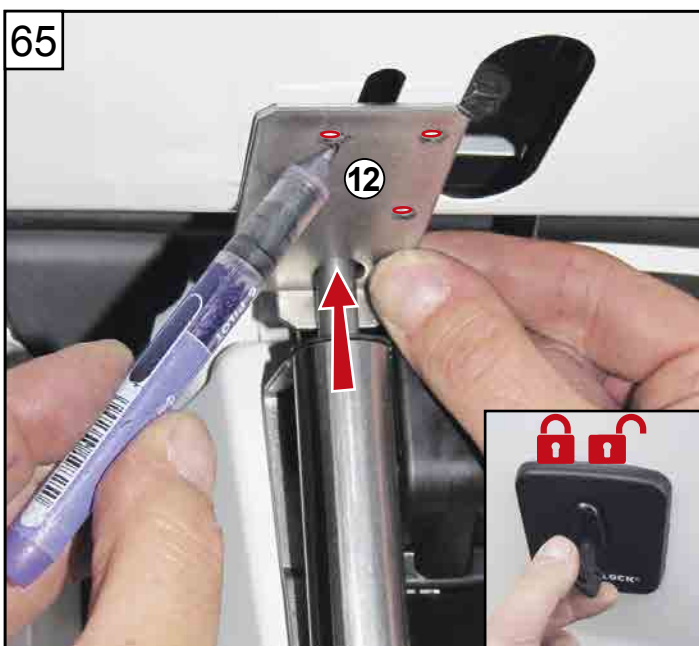
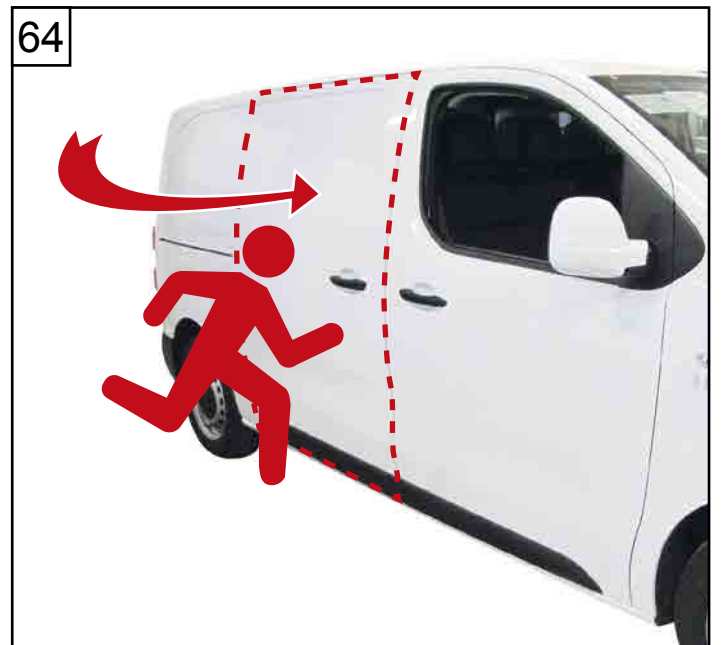
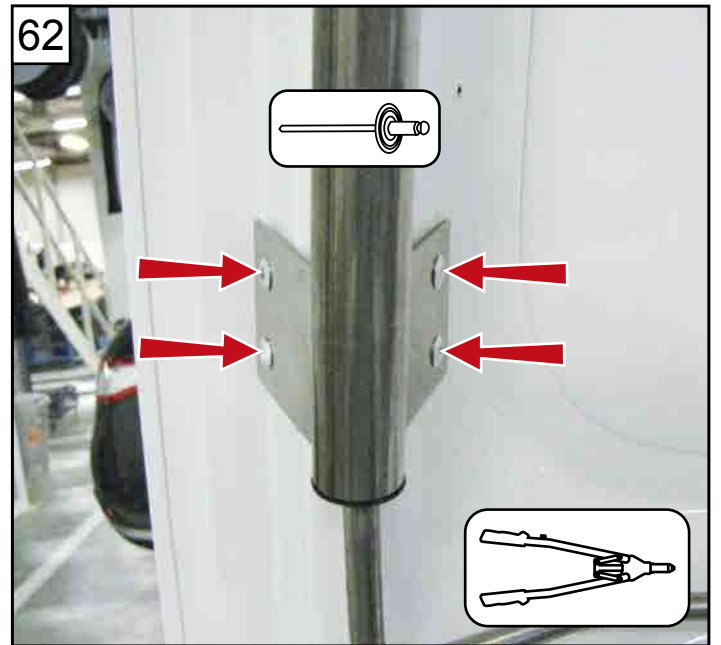
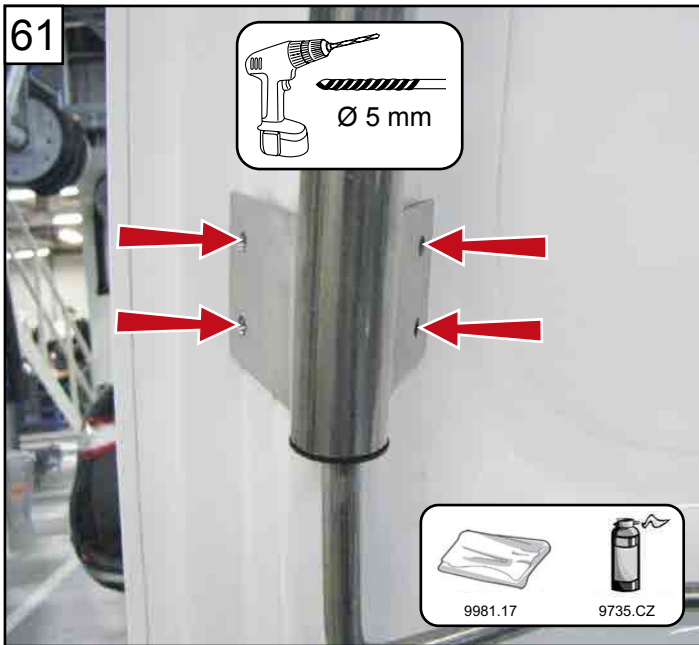

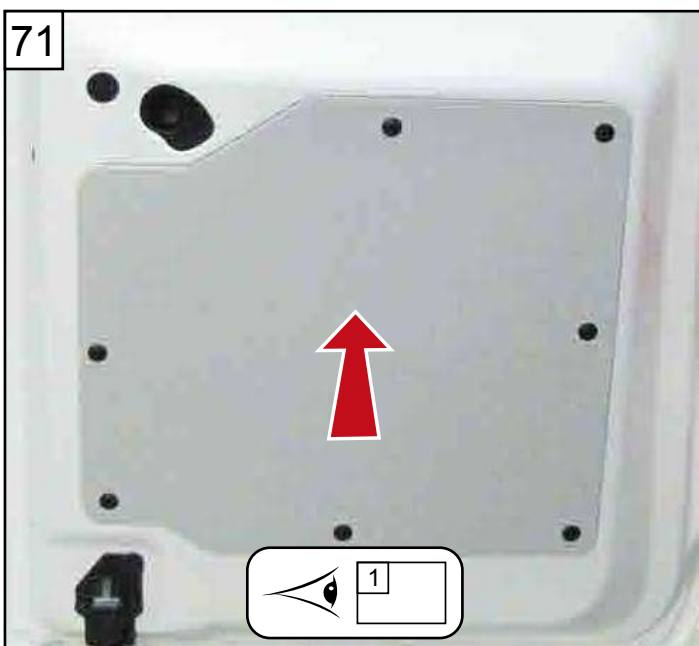
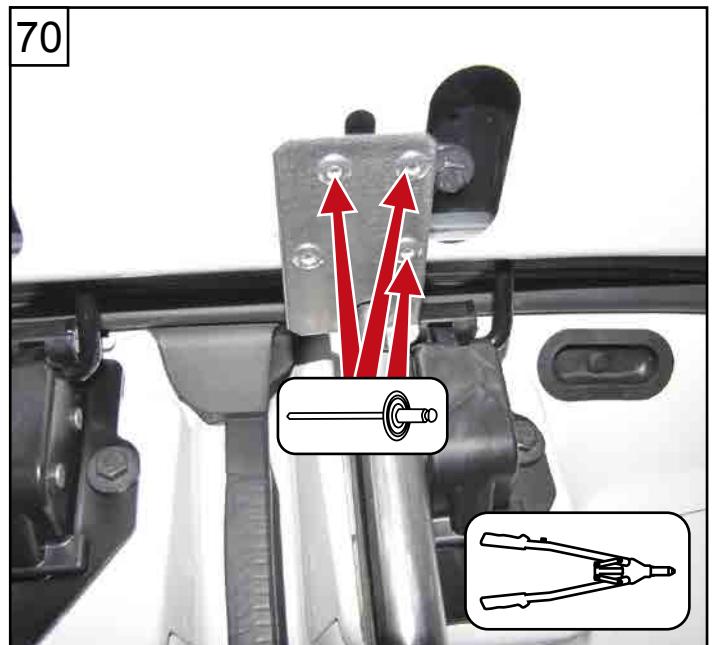
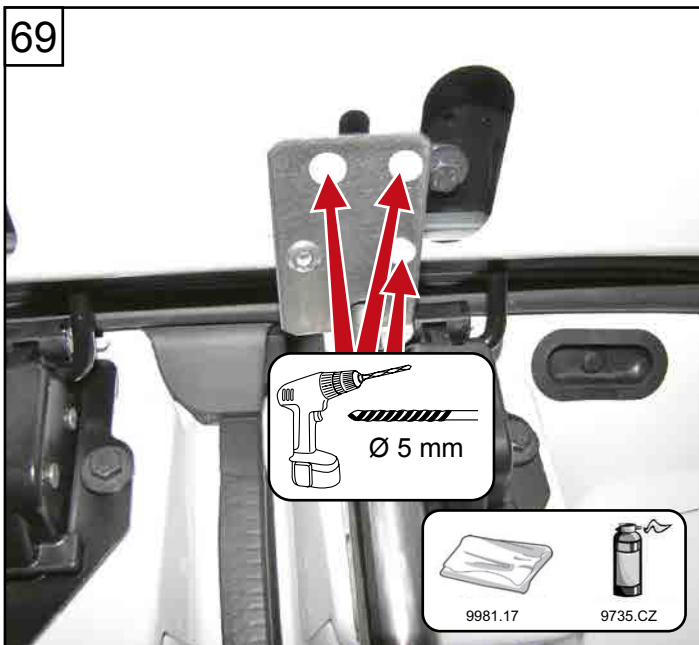
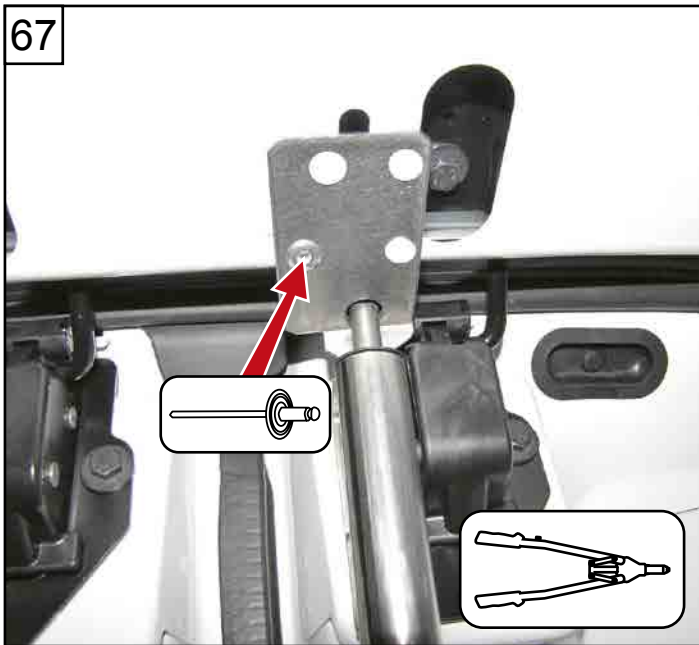

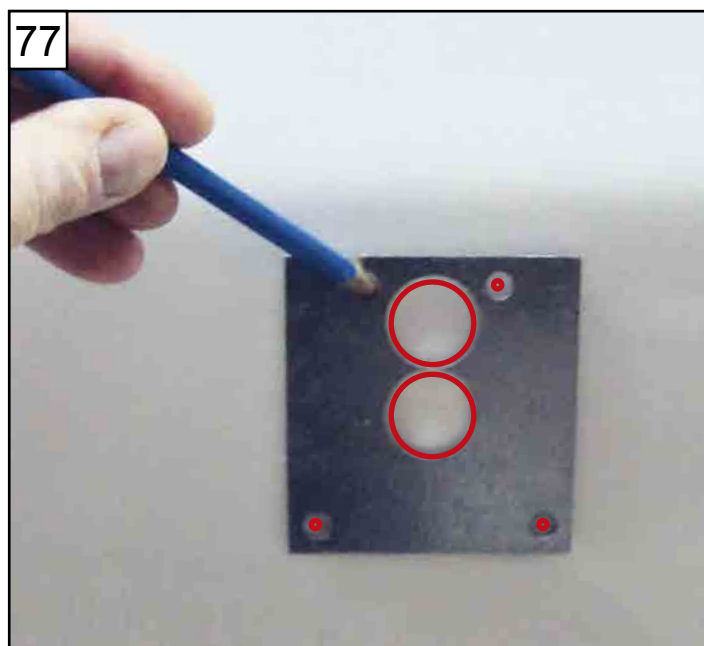
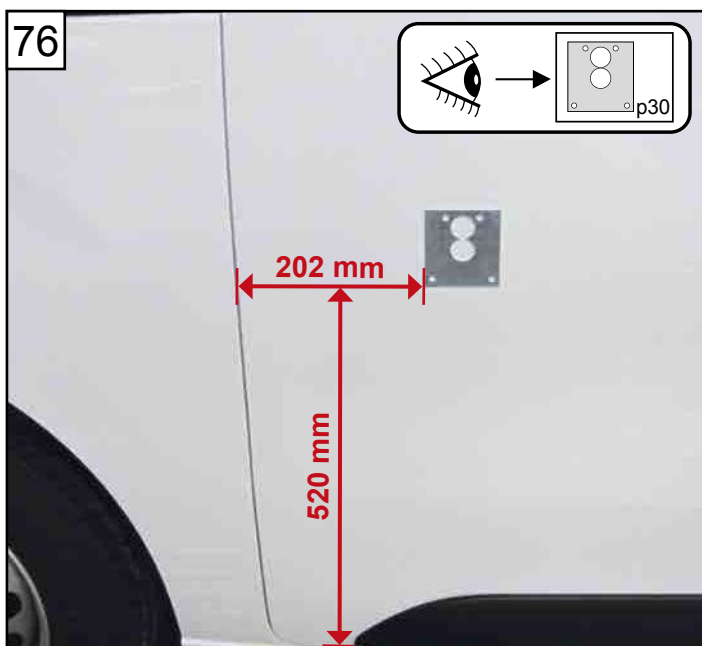
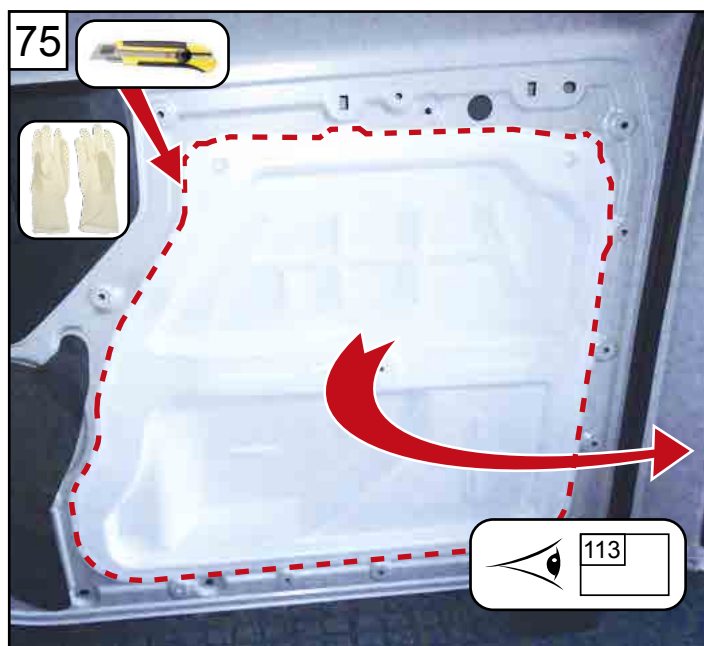
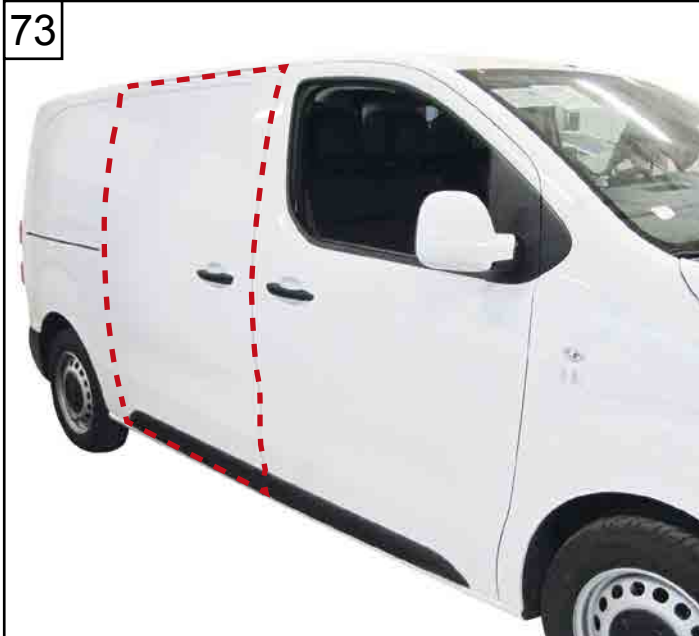

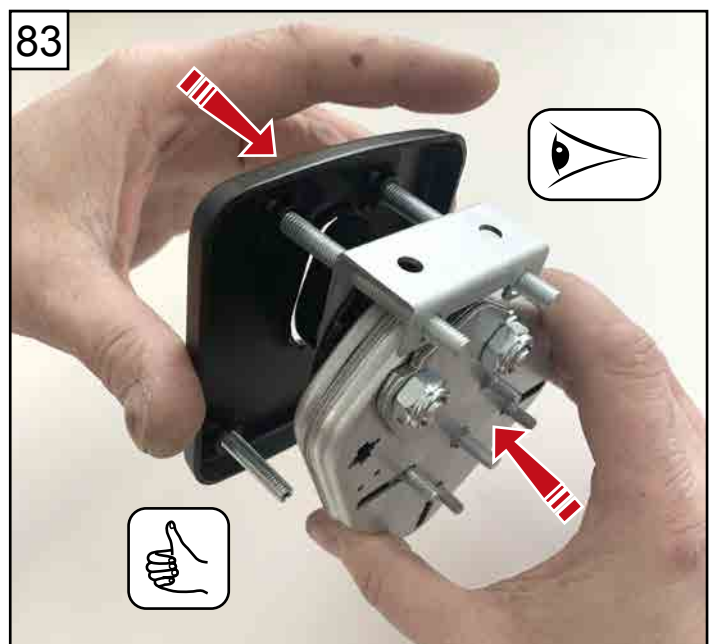
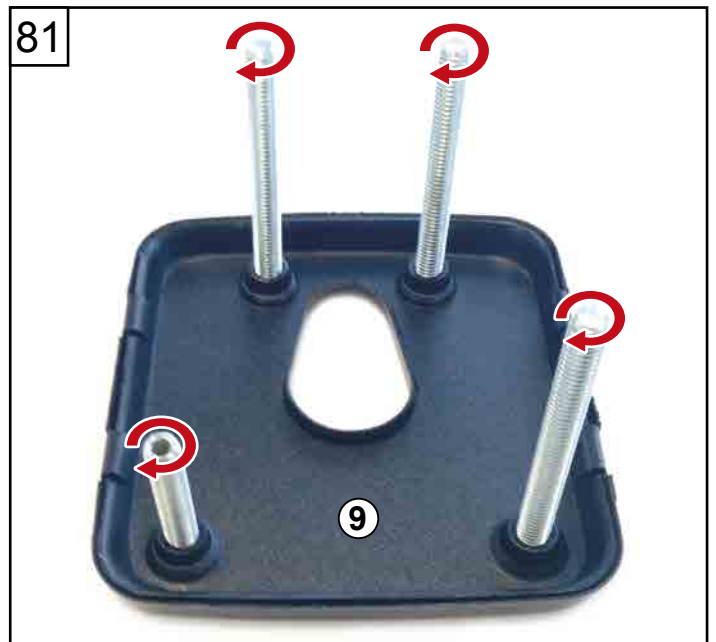
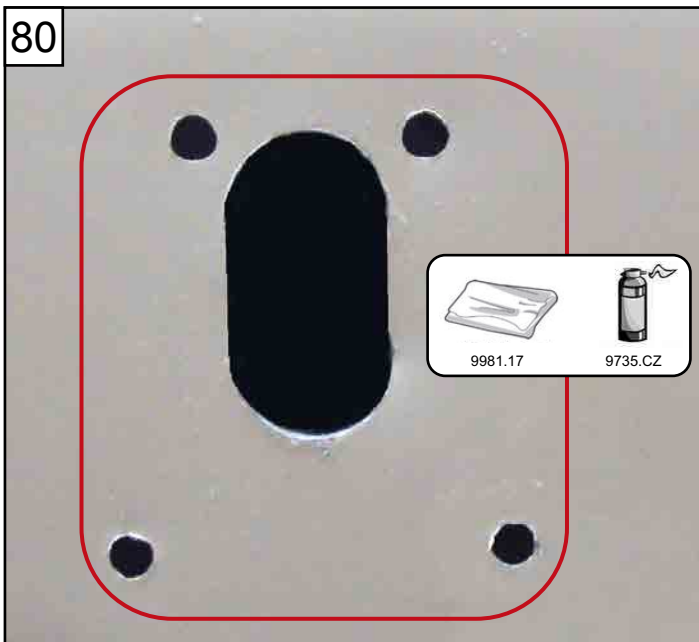
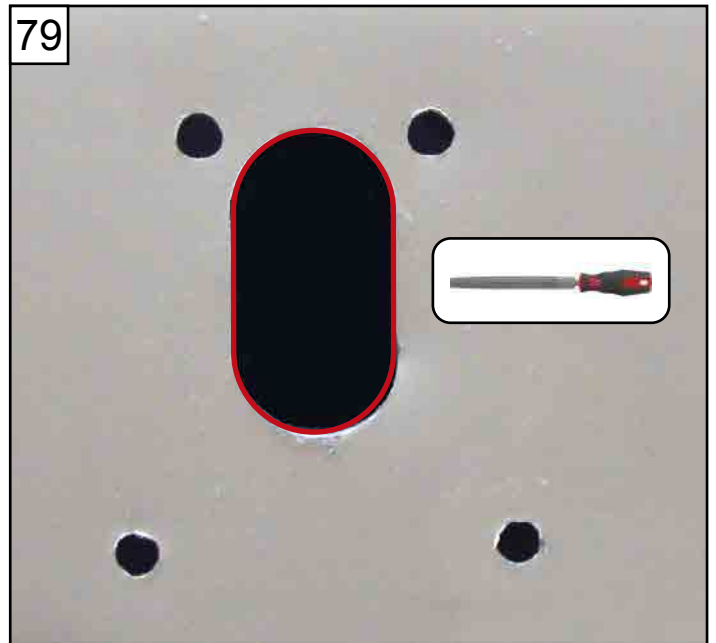
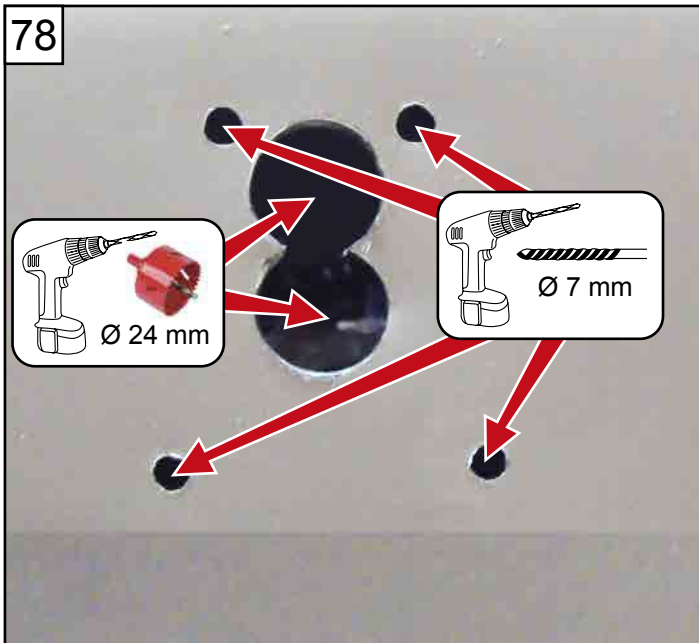

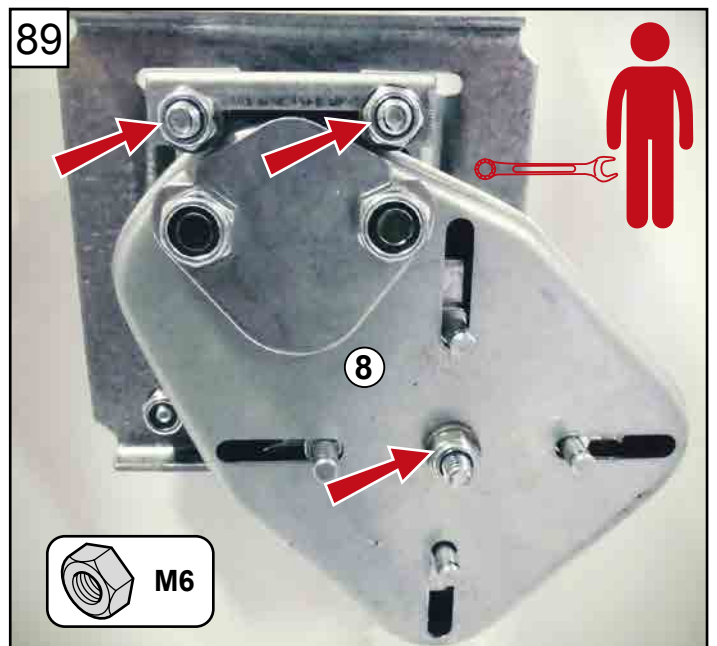
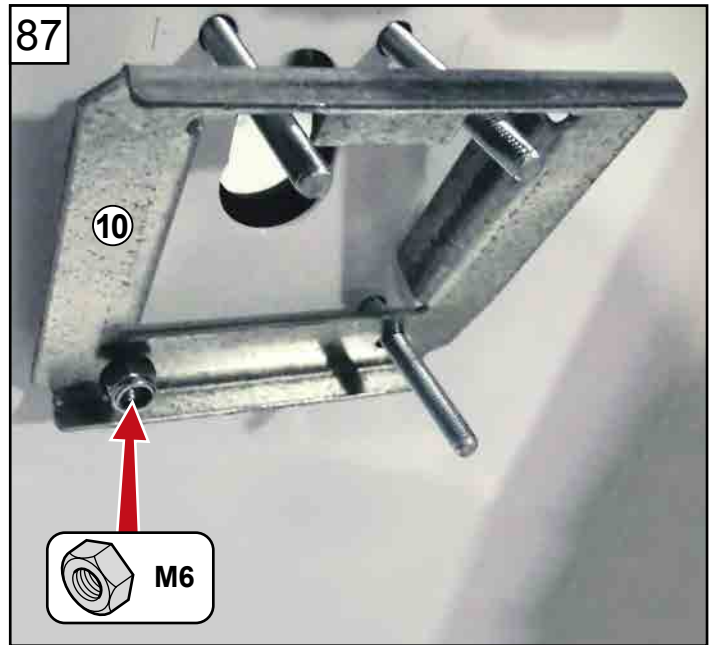



< OPR 16100

90-98

> OPR 16100

99-112

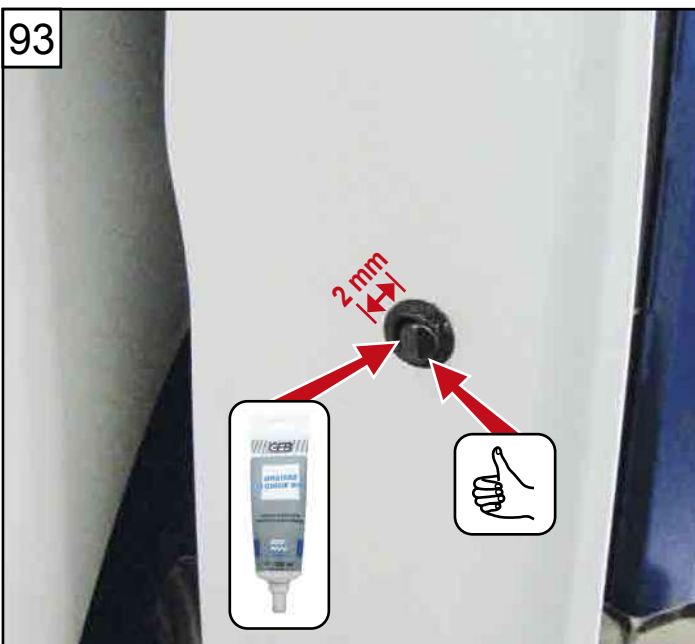
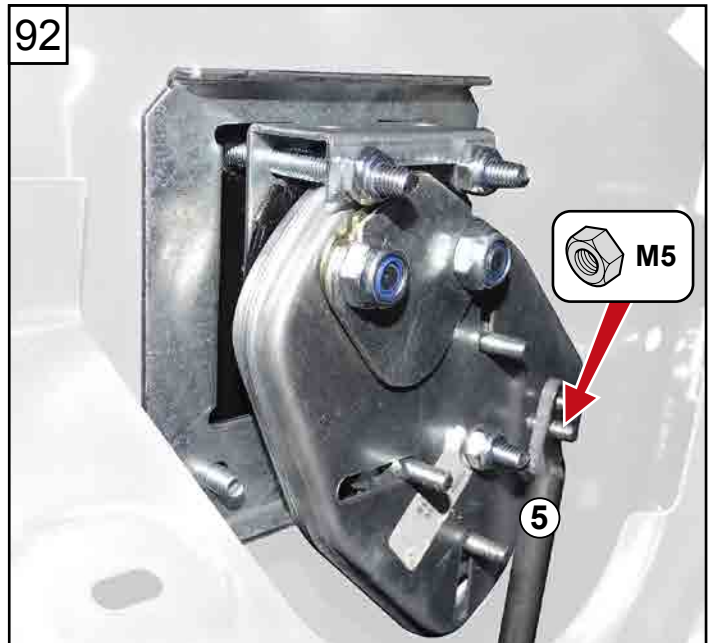
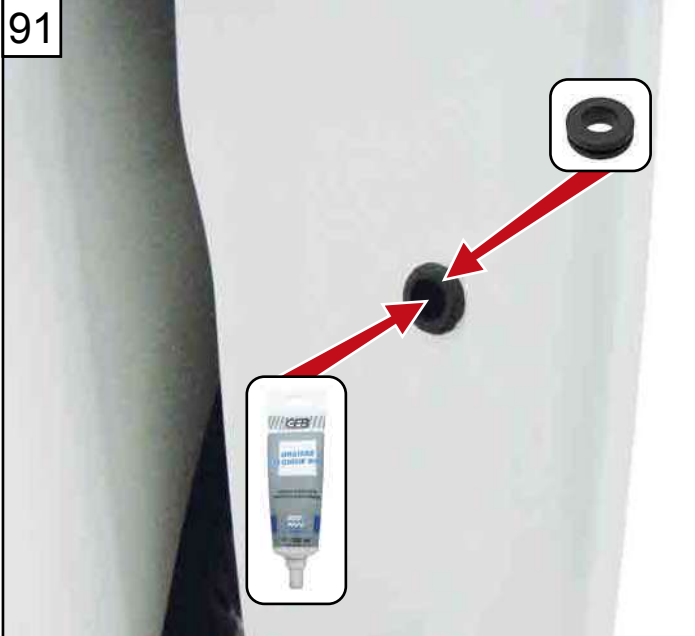
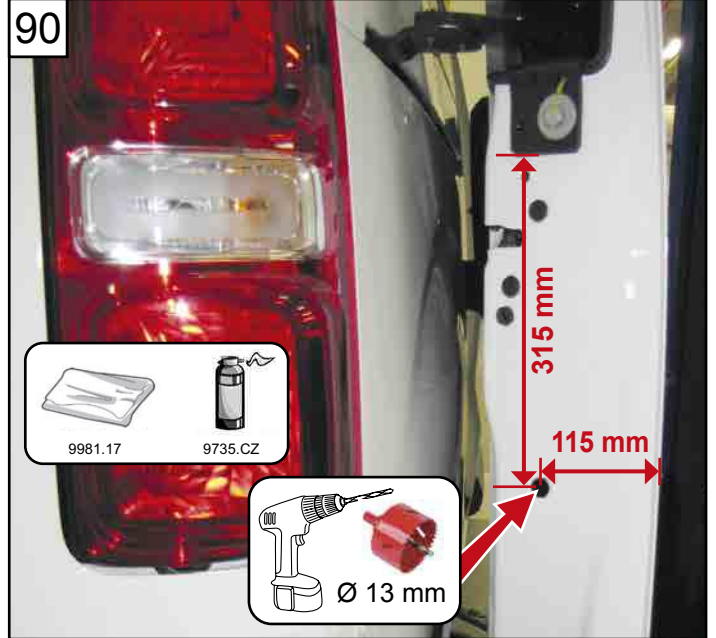

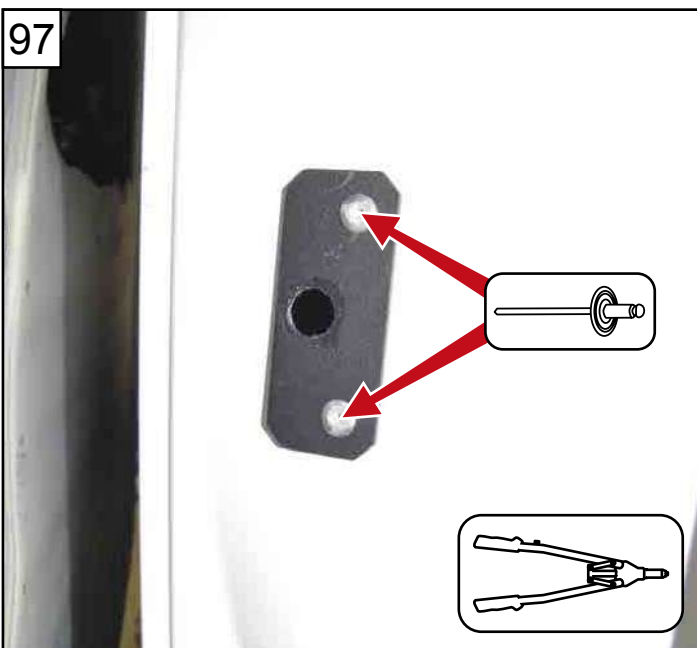
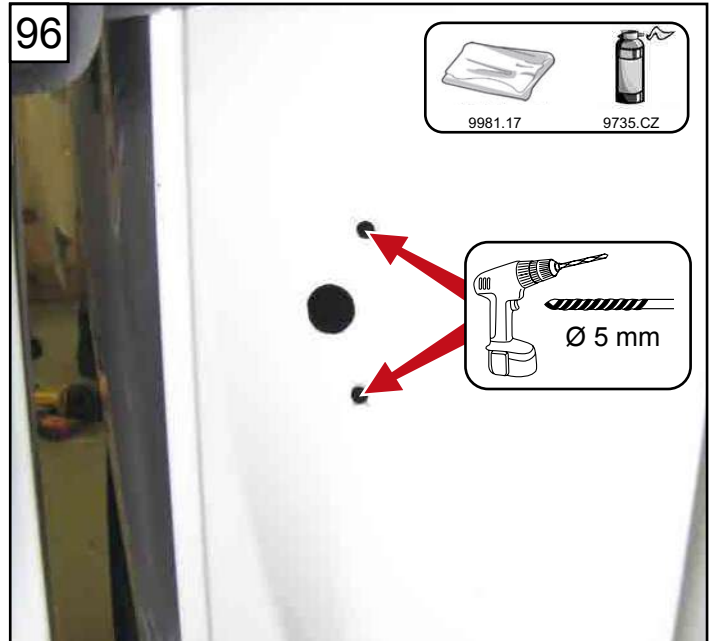
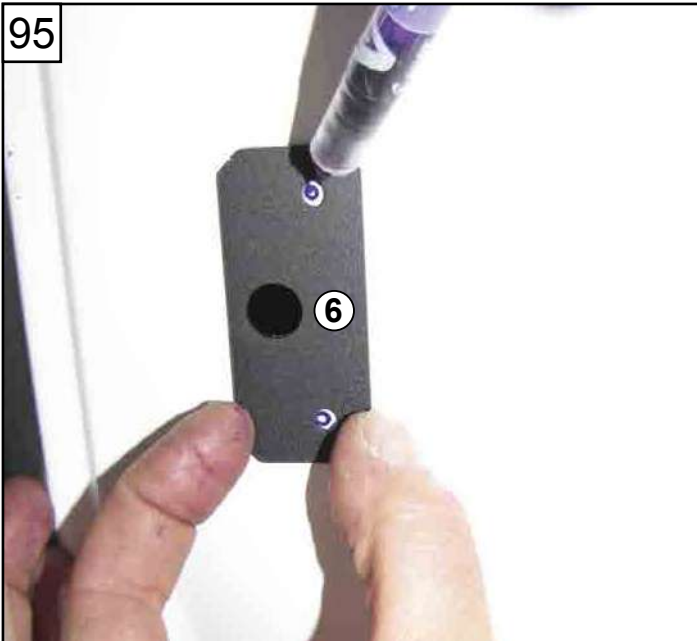

> N° OPR : 16100

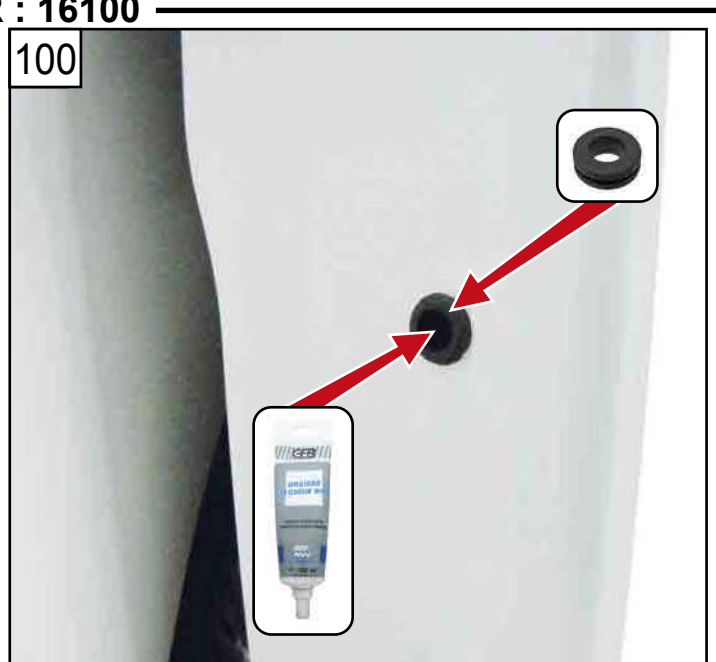
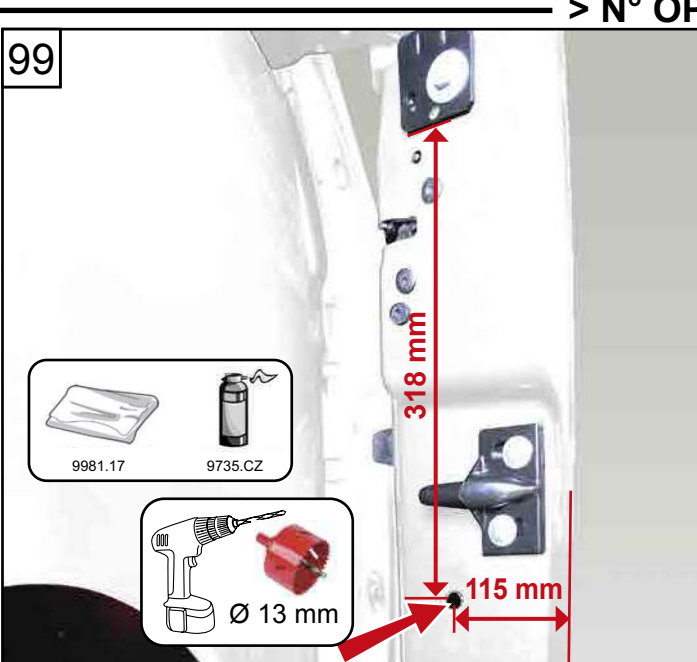

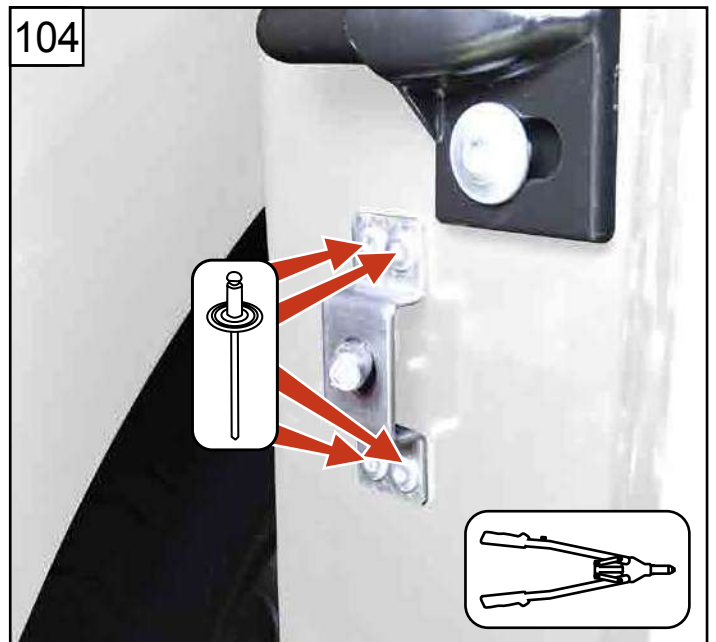
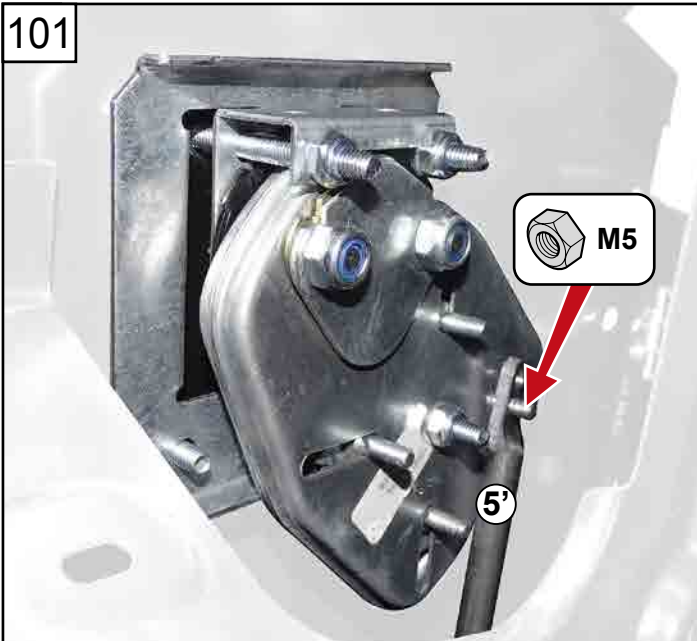

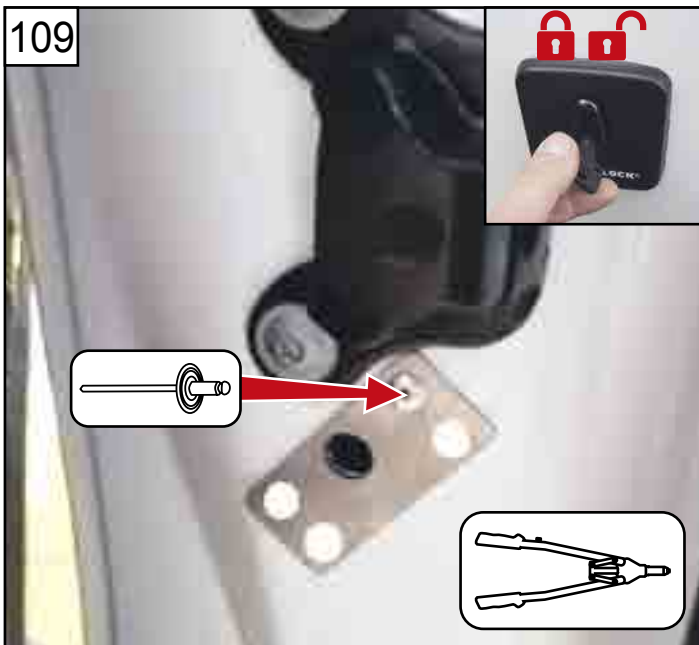

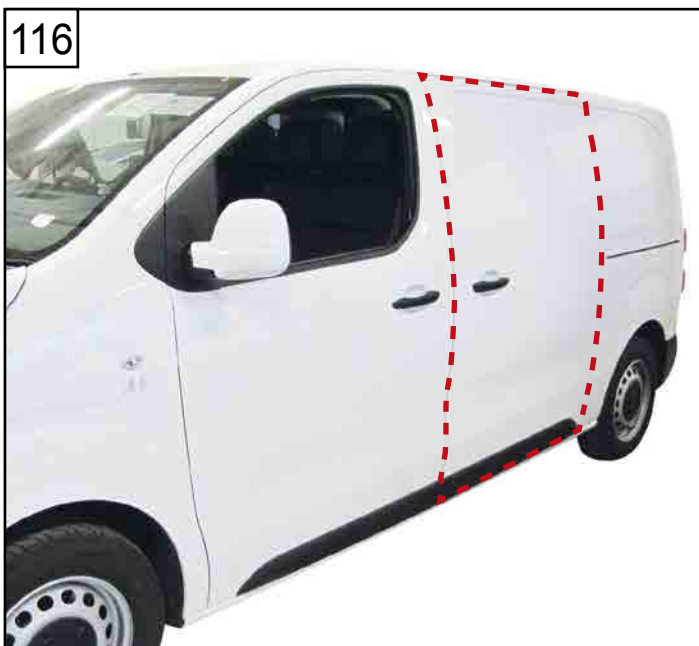
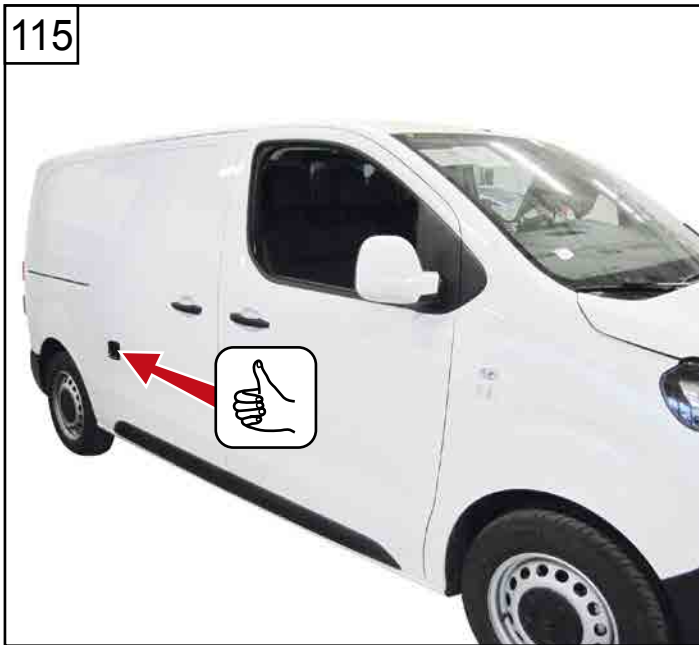
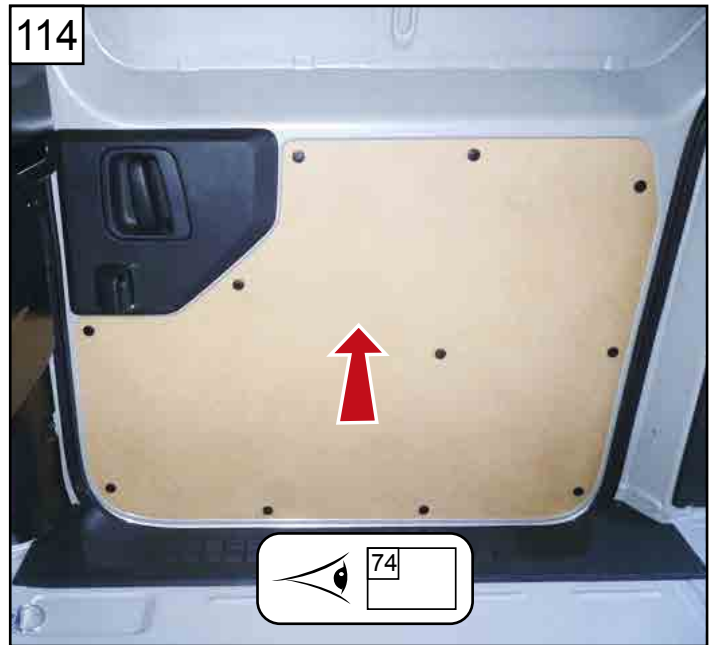
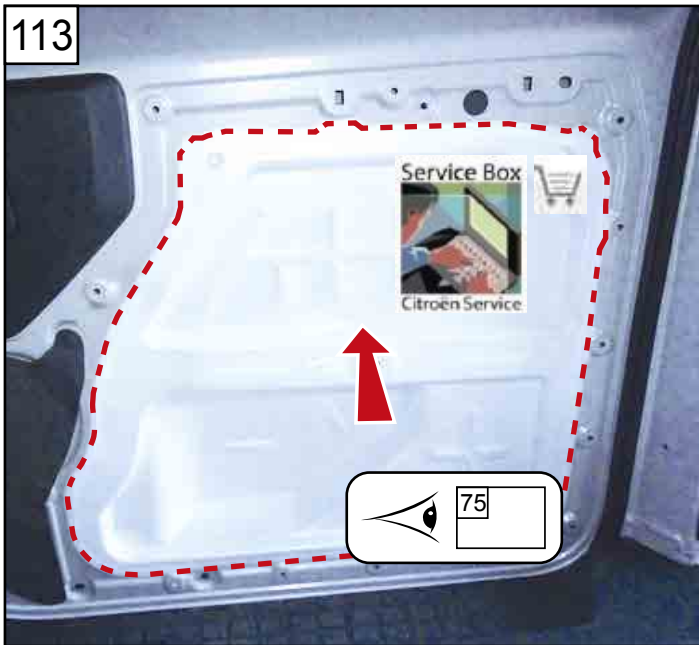

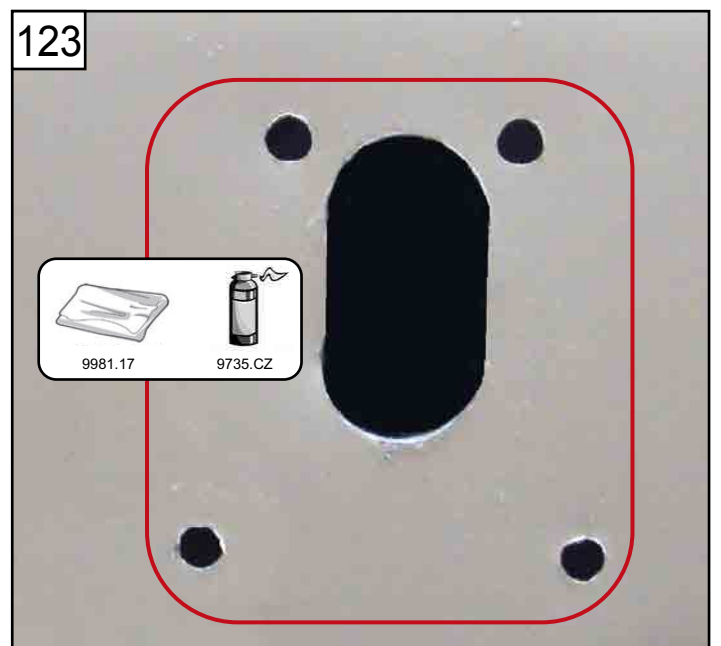
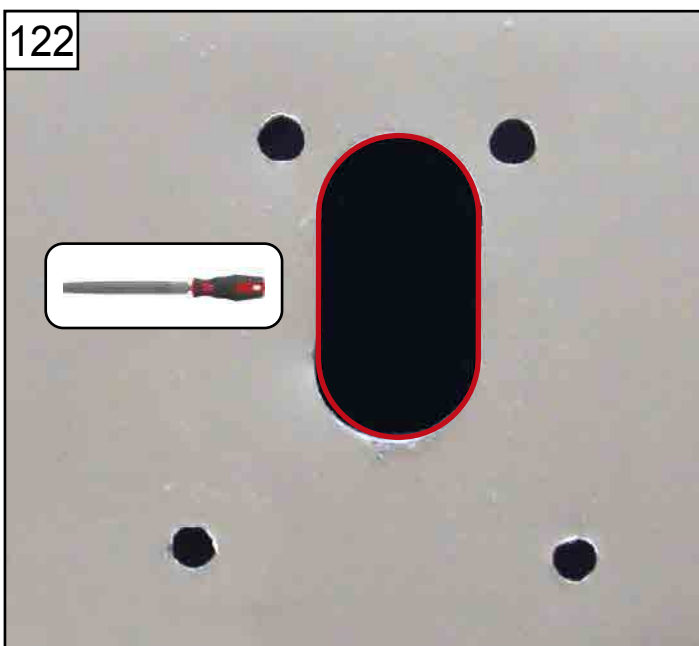
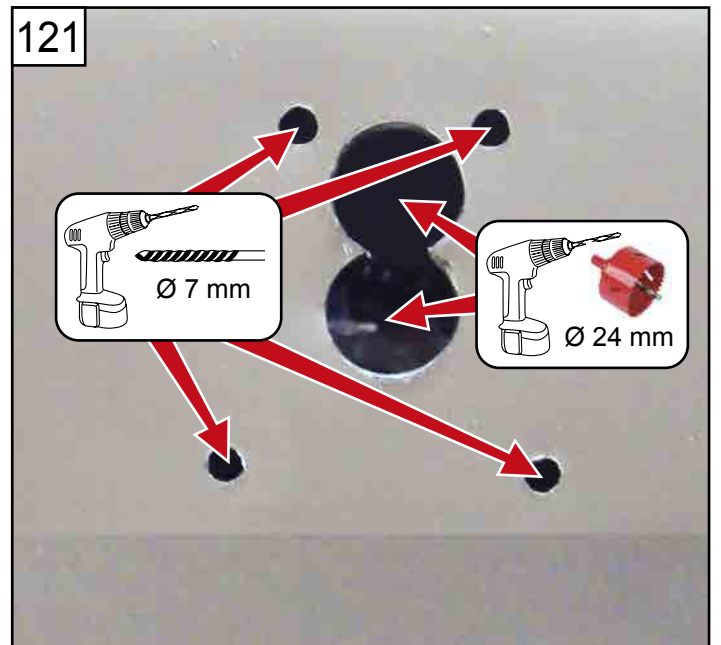
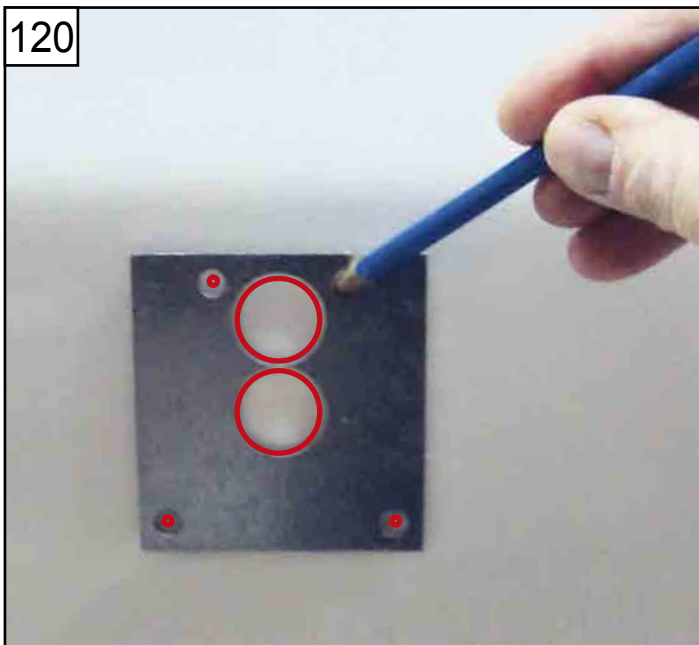
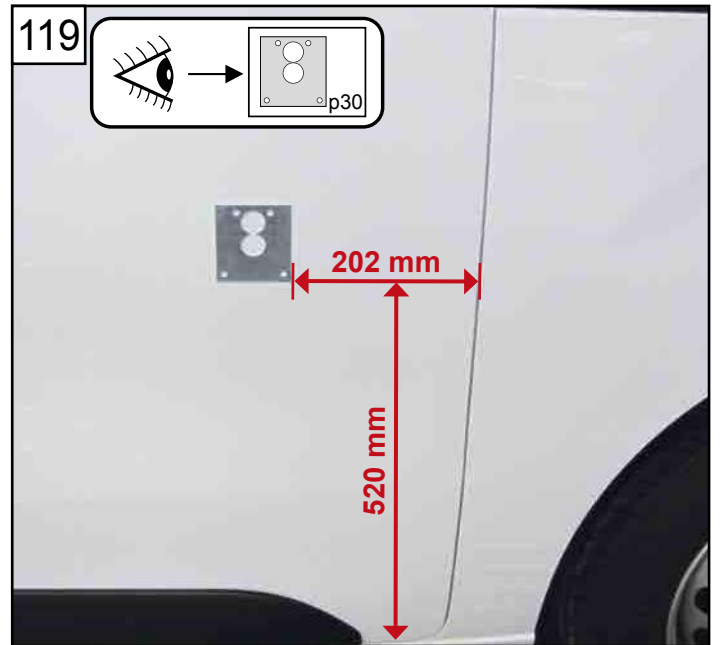
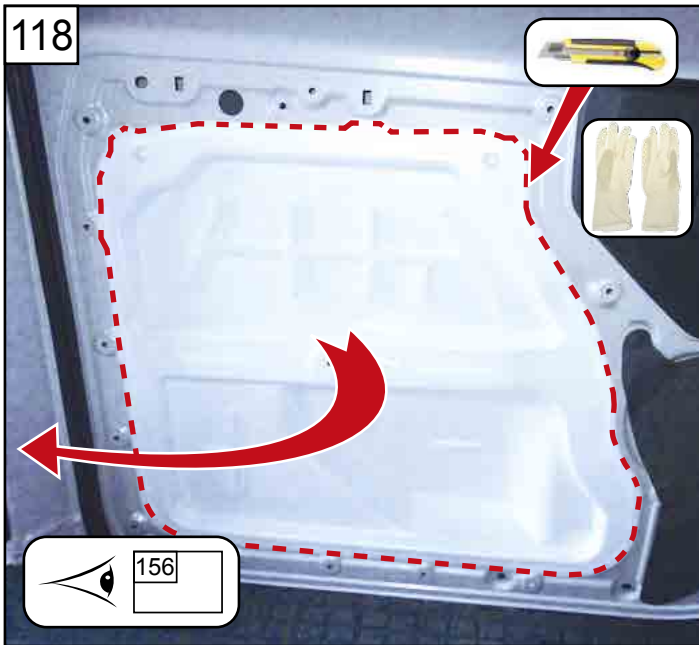

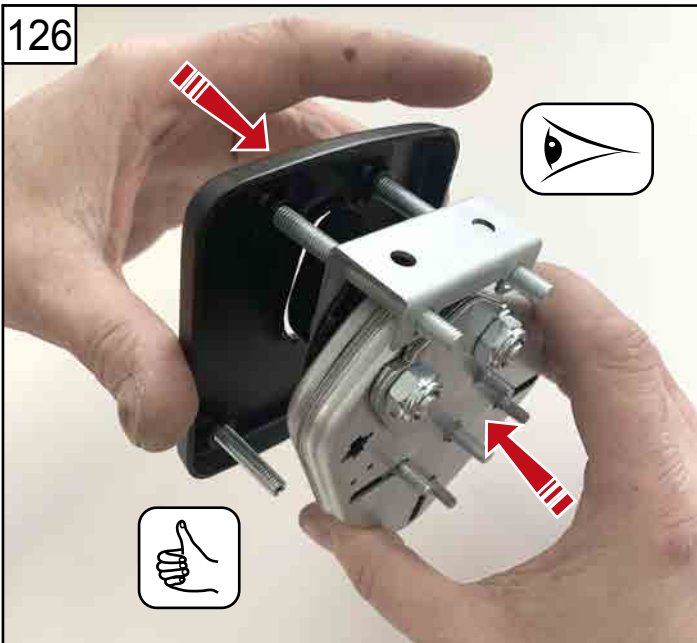
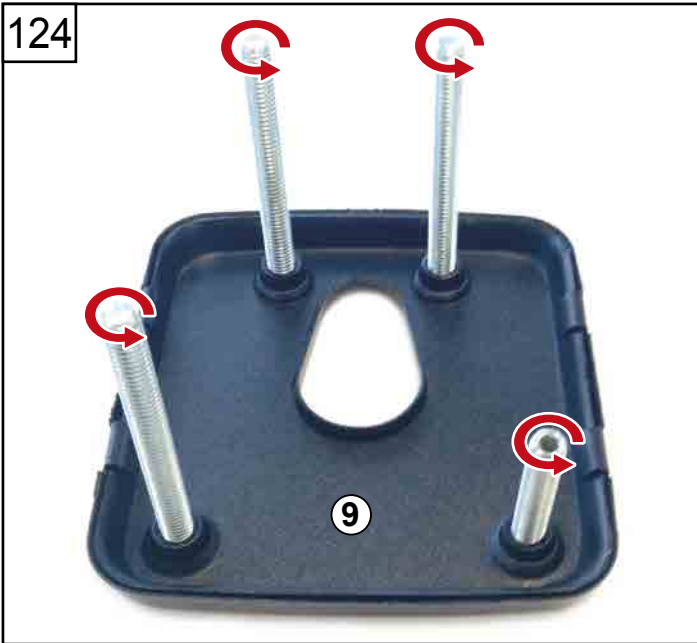

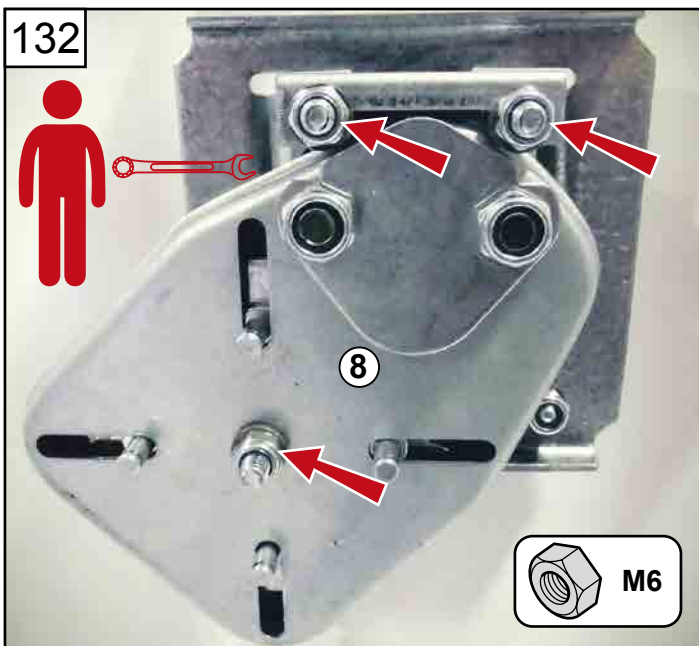
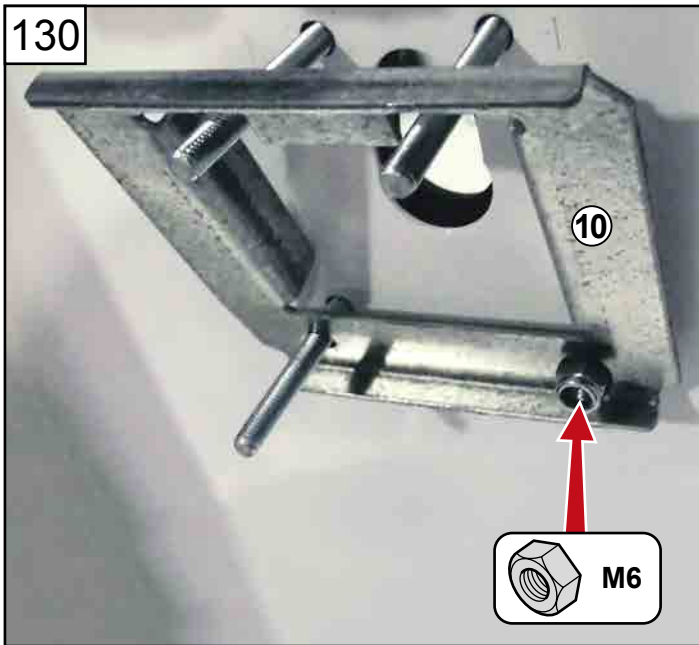

< OPR 16100

133-141

> OPR 16100

142-155

< N° OPR : 16100

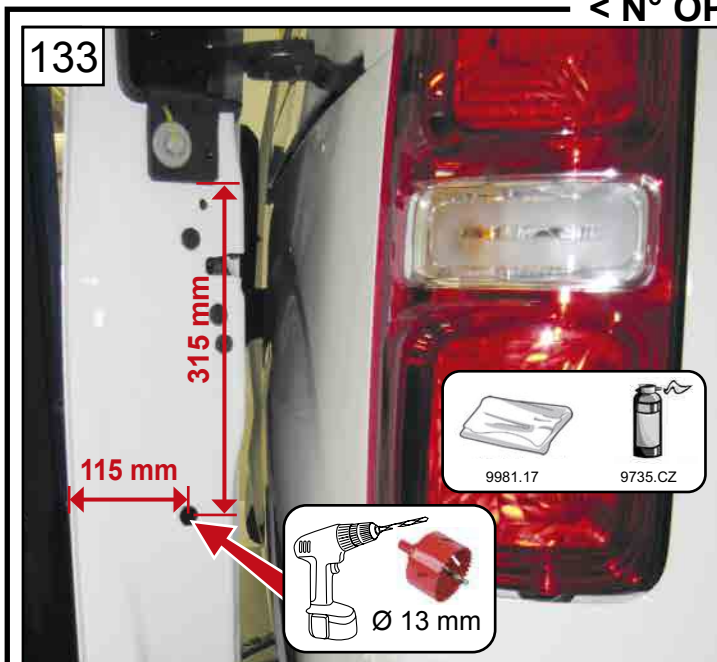

135

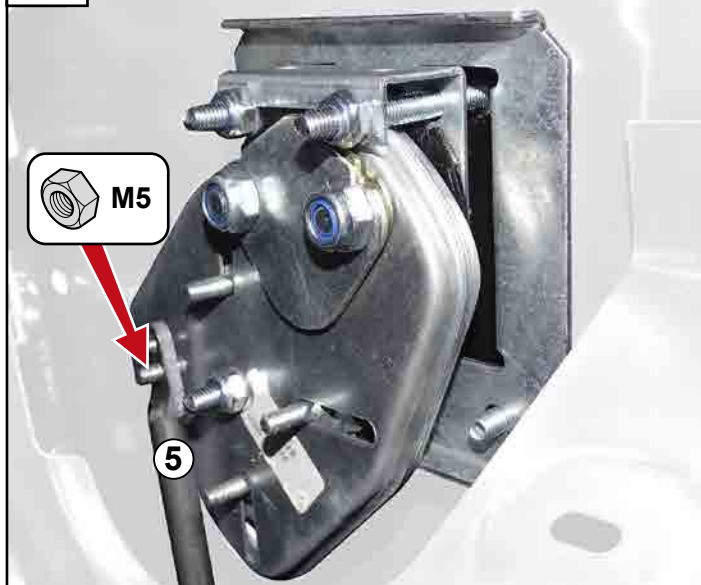

136



137



138

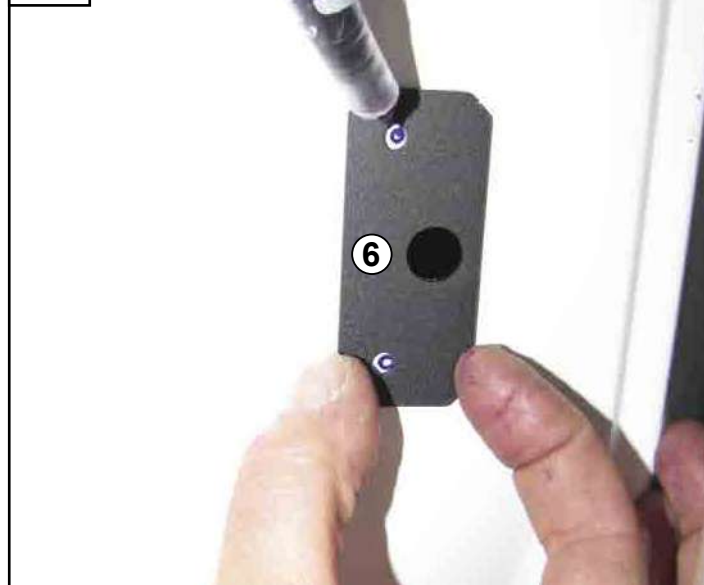

139

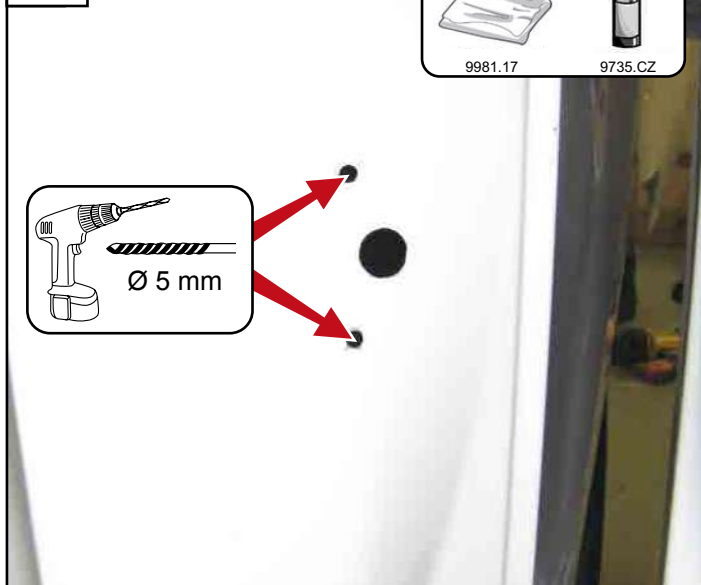

140

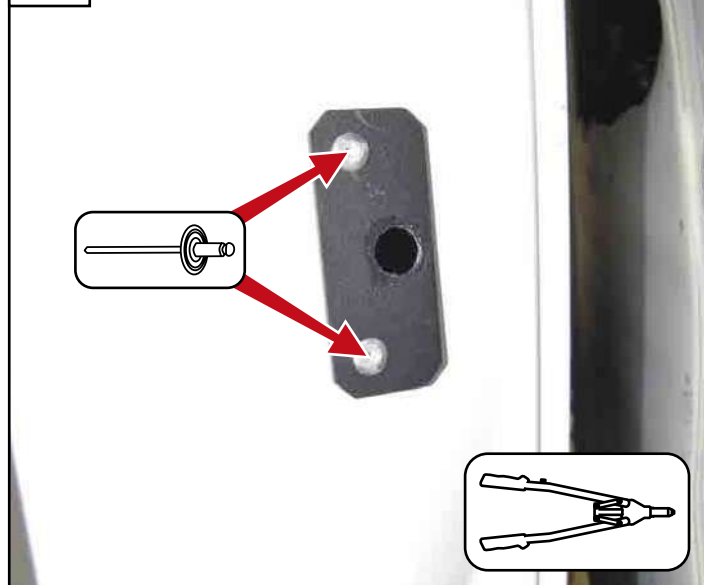

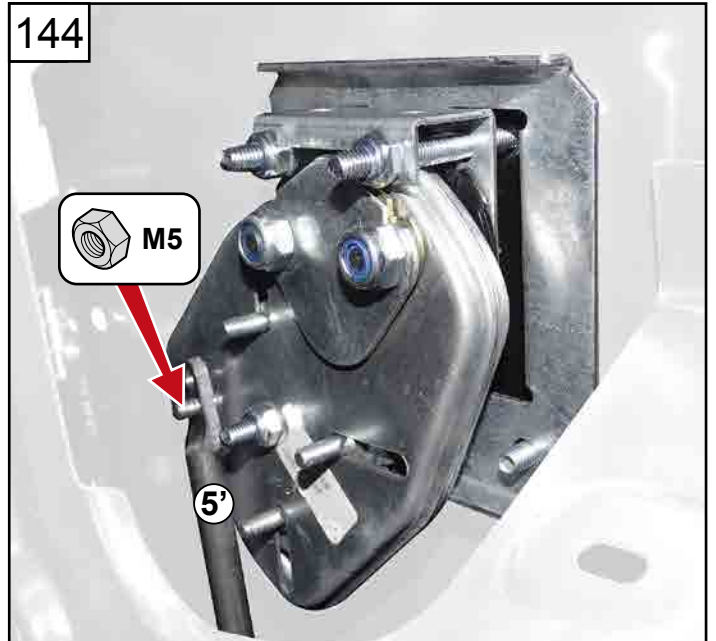
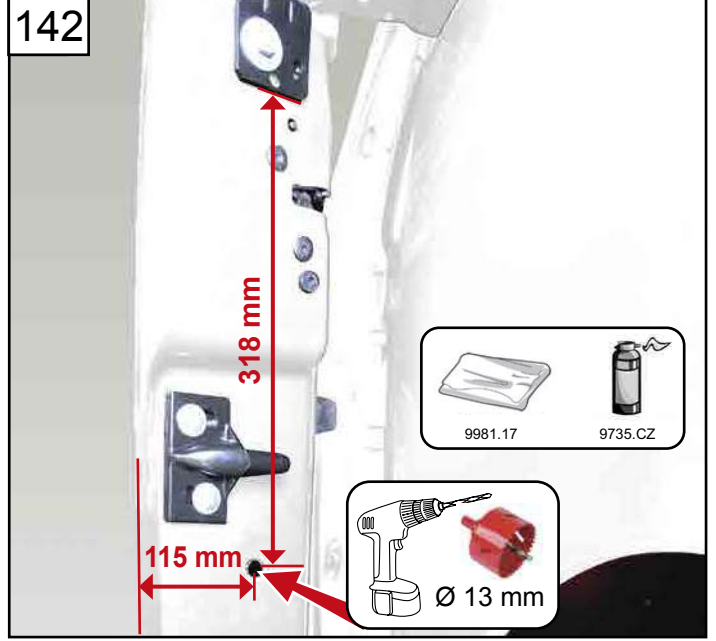

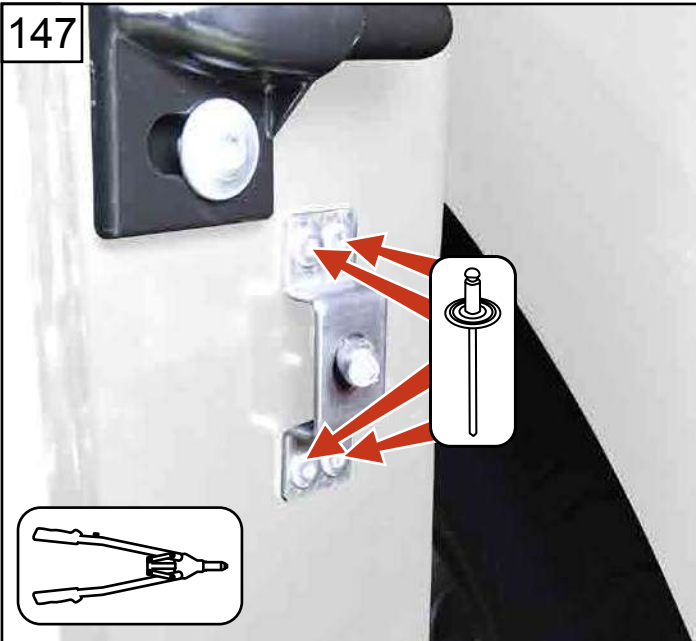

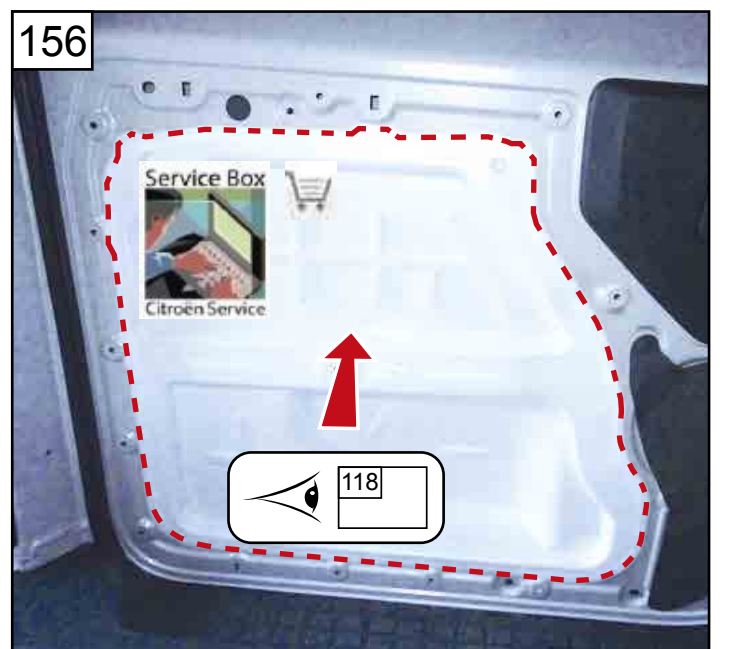



100%

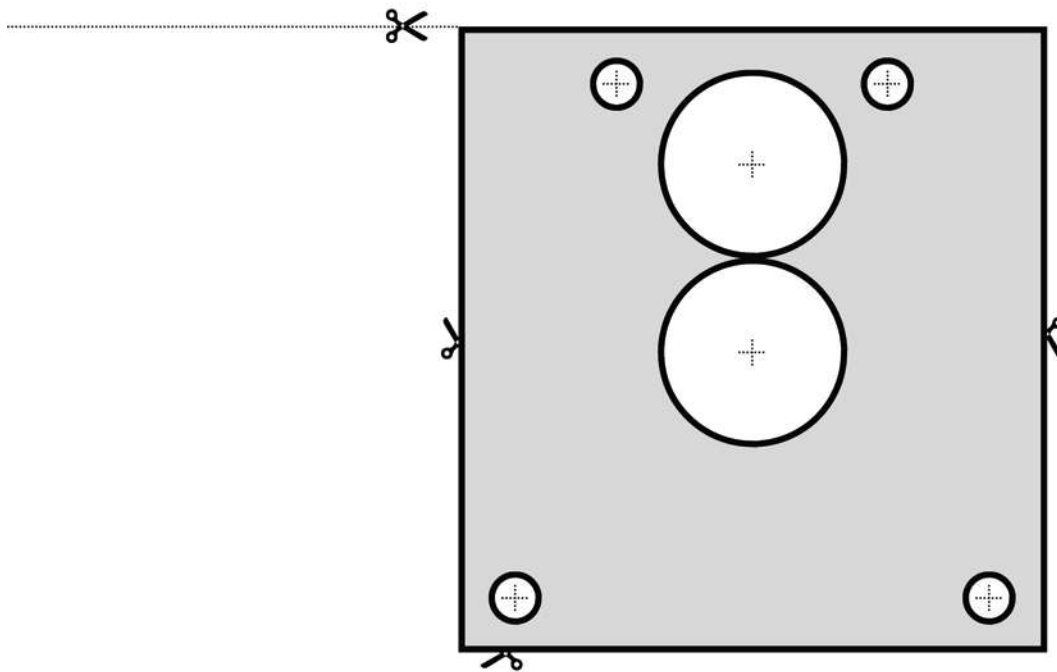

3 cm





DIVISION AUTOMOBILE MUL-T-LOCK

**4 AVENUE D'OUessant
91140 VILLEBON SUR YVETTE**

Tél. : 01 41 28 39 70

Fax : 01 69 53 01 85



SUPPORT COMMERCIAL

01 41 28 39 70

adv@mul-t-lock.fr

SUPPORT TECHNIQUE

automobile@mul-t-lock.fr

**TOUTES LES PHOTOS DE LA PRÉSENTE NOTICE SONT LA PROPRIÉTÉ EXCLUSIVE DE MUL-T-LOCK.
REPRODUCTION STRICTEMENT INTERDITE. NOTICE RÉSERVÉE EXCLUSIVEMENT AUX PRODUITS DE LA MARQUE MUL-T-LOCK.**