



NOTICE DE MONTAGE KIT COMPLET

MODÈLE CITROËN JUMPER II

L1- H1 et L2 - H1

Année : 2006 - À ce jour

MODÈLE PEUGEOT Boxer

L1- H1 et L2 - H1

Année : 2006 - À ce jour

MODÈLE Fiat Ducato

L1- H1 et L2 - H1

Année : 2006 - À ce jour



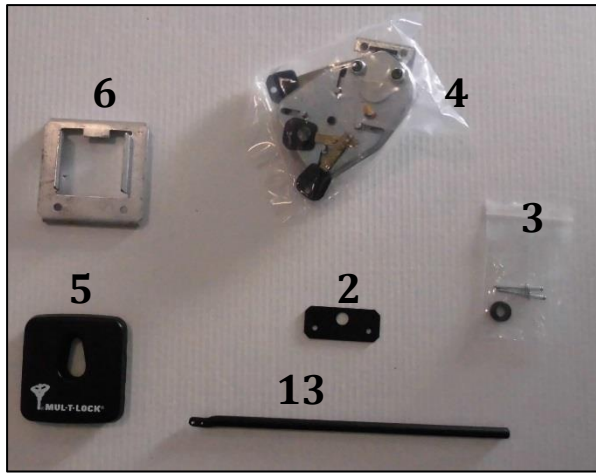

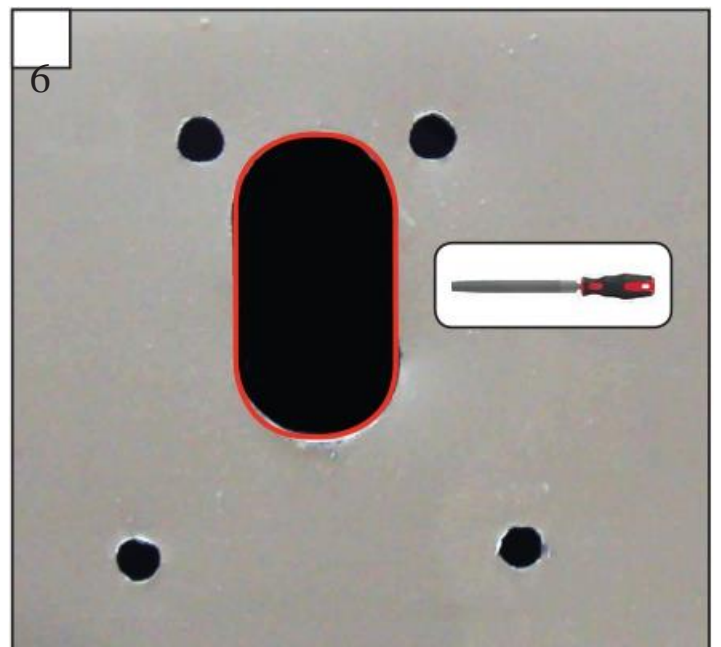
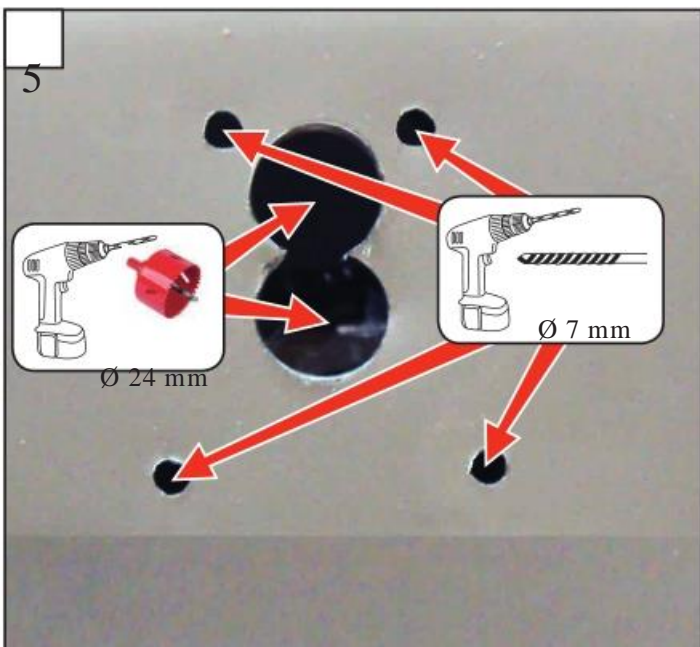
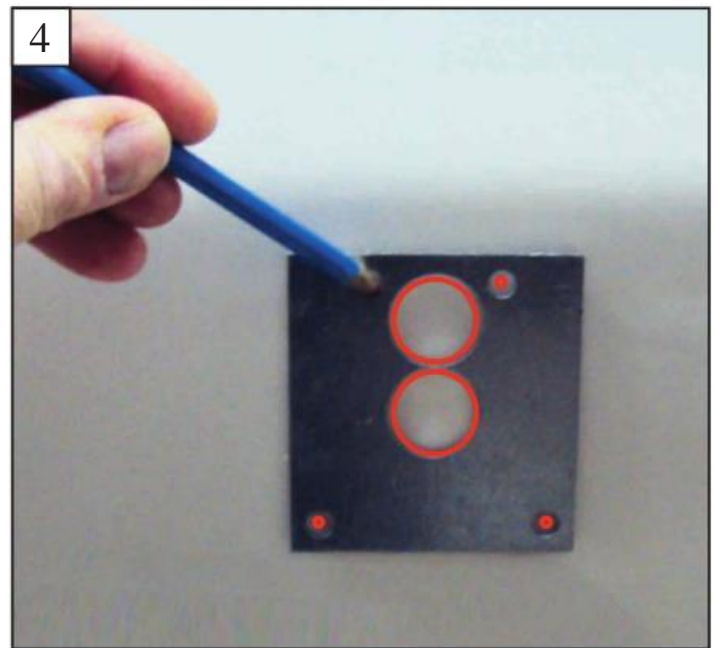
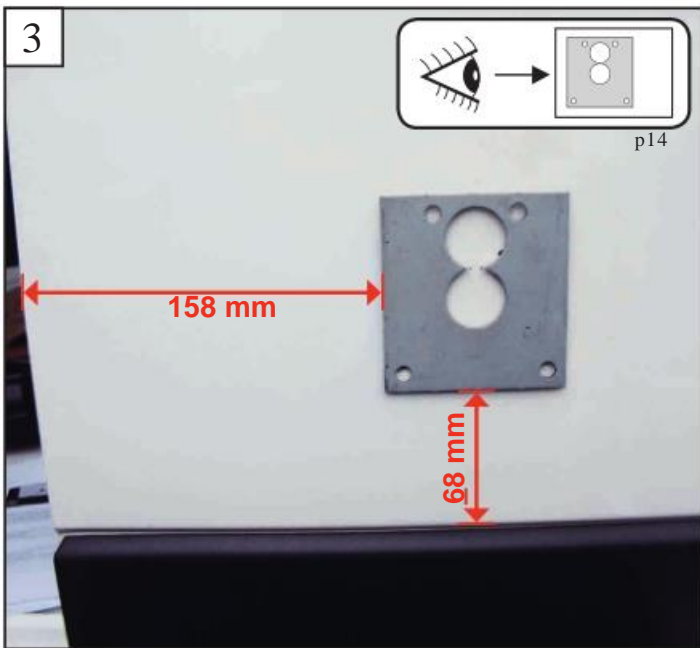
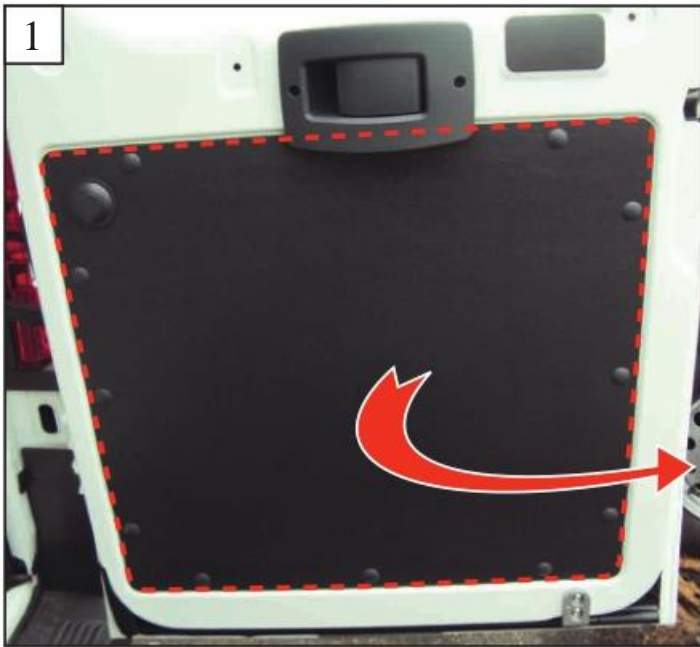

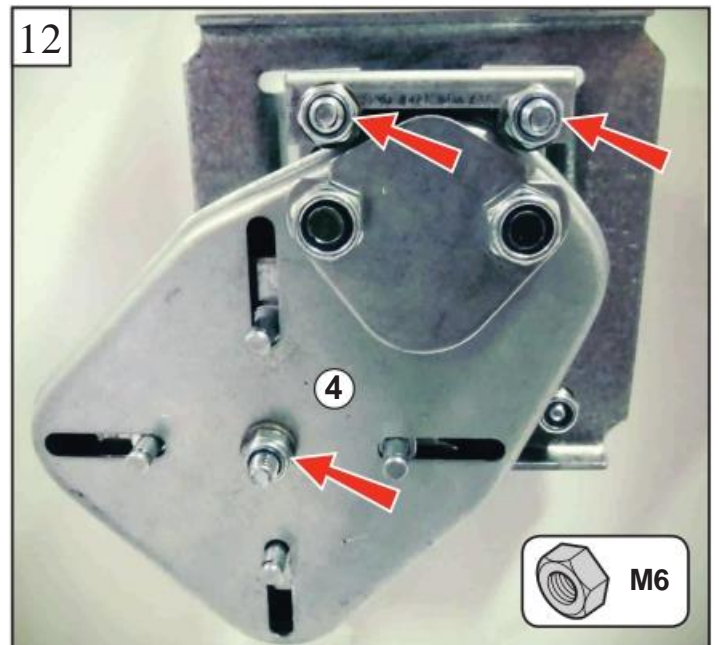
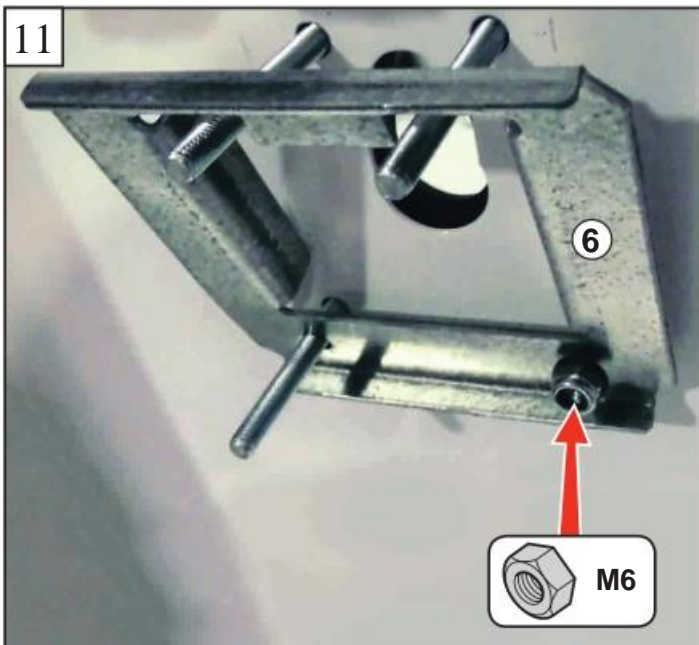
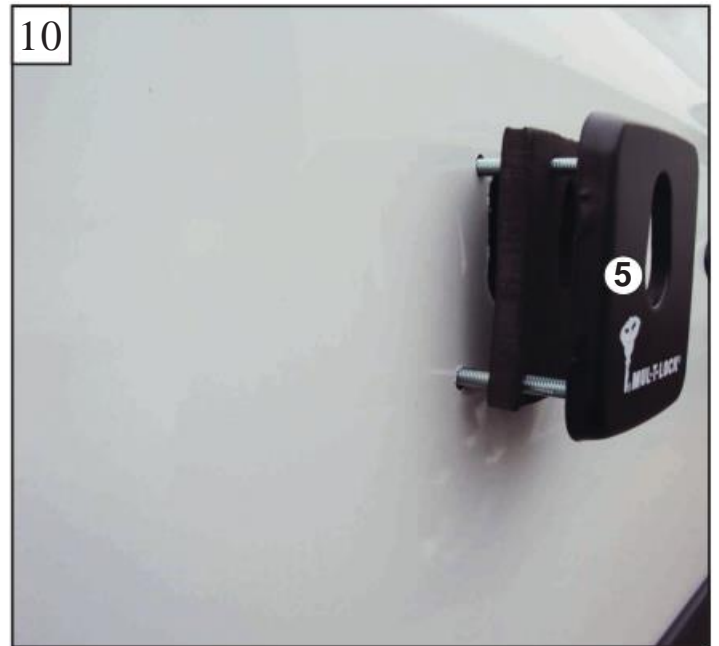
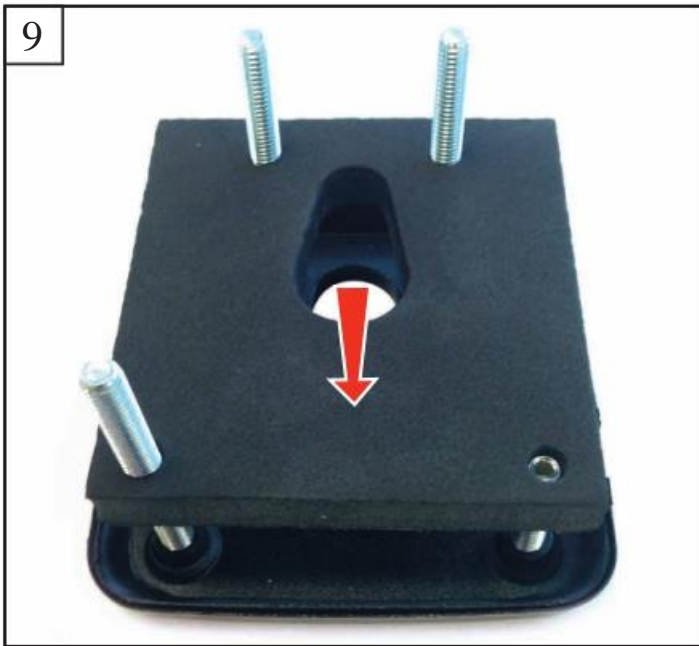
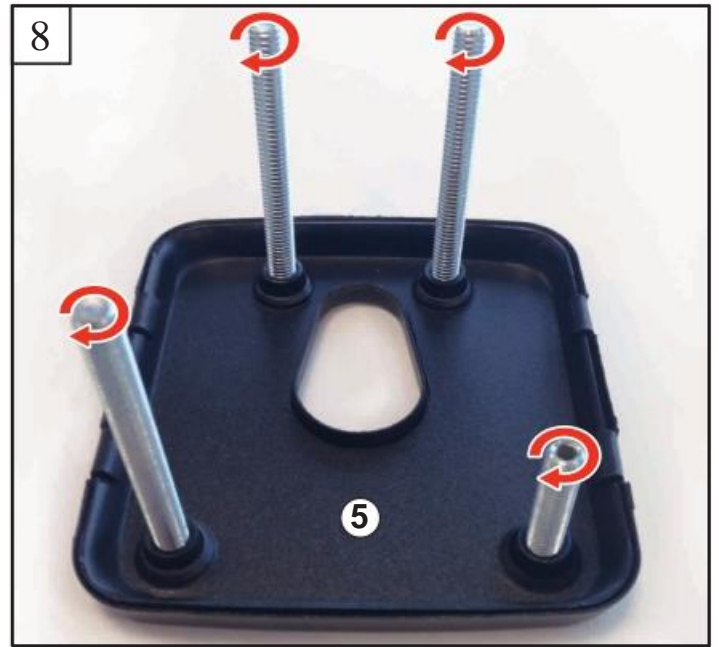
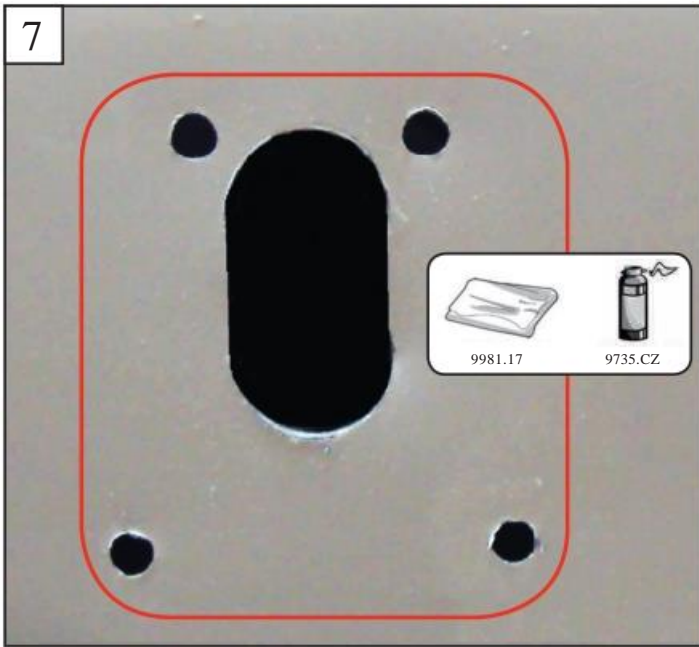

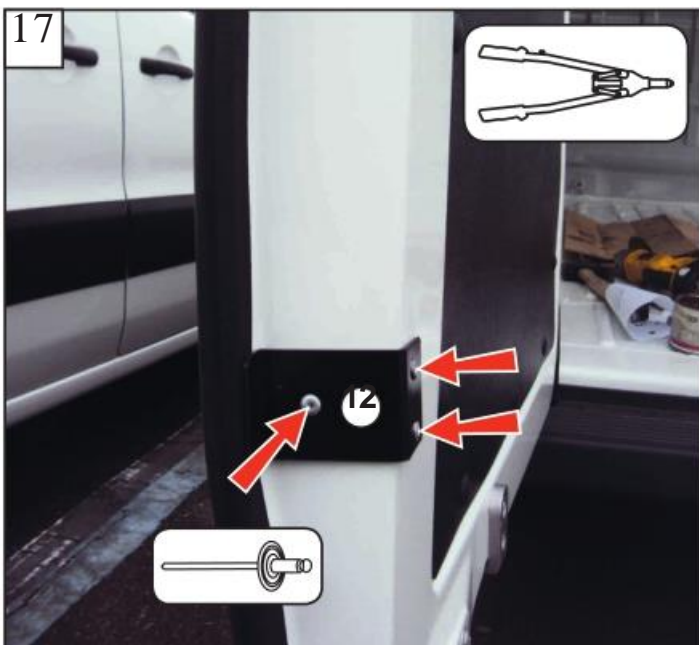
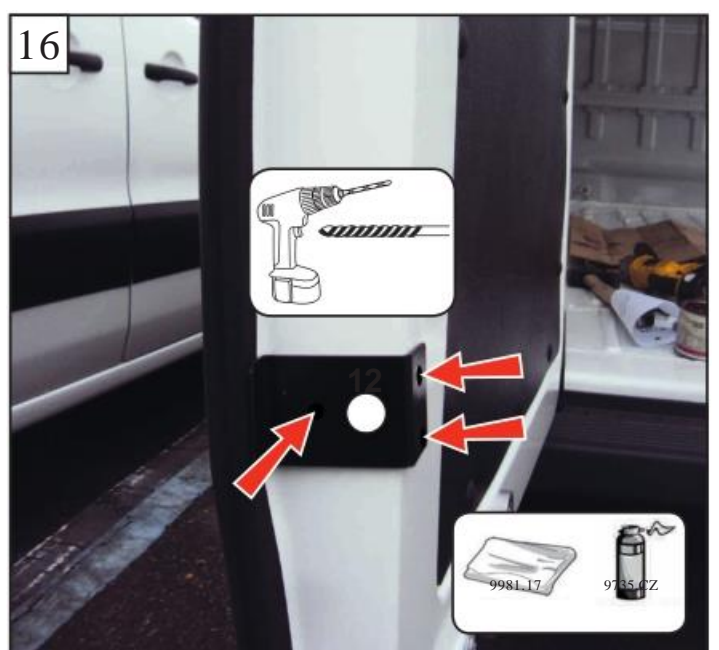
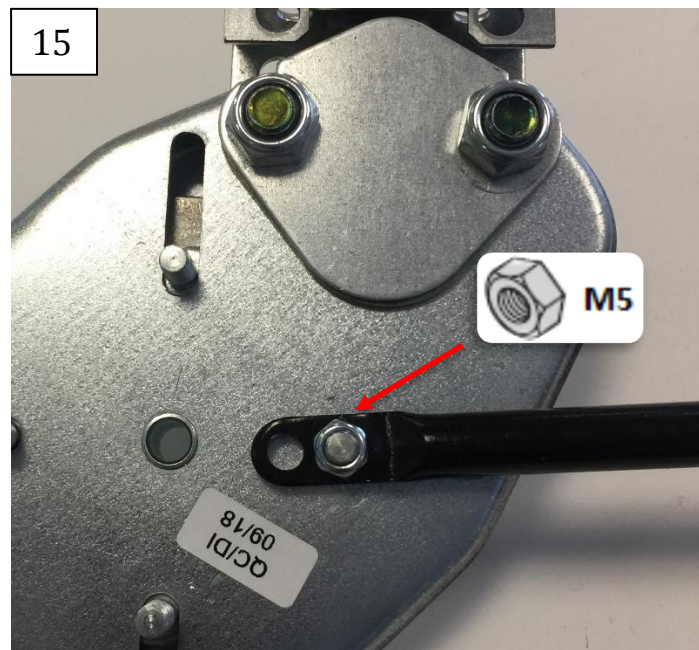
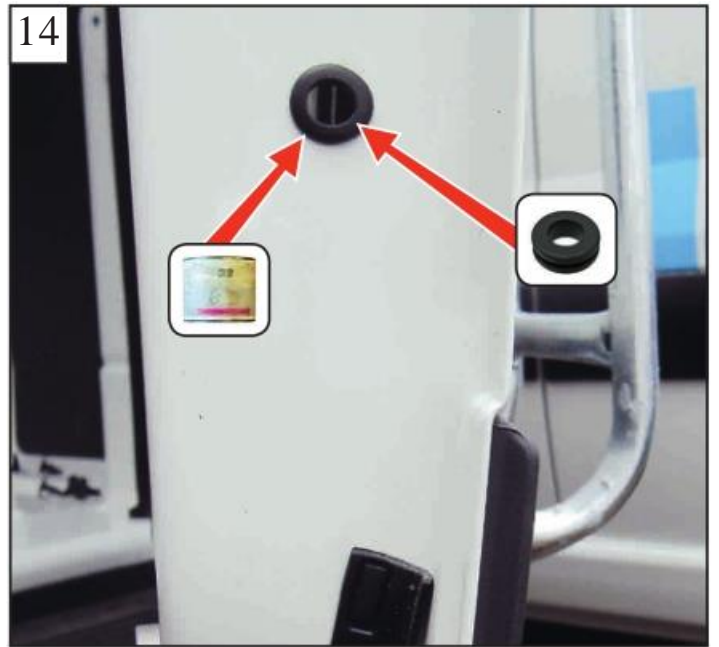
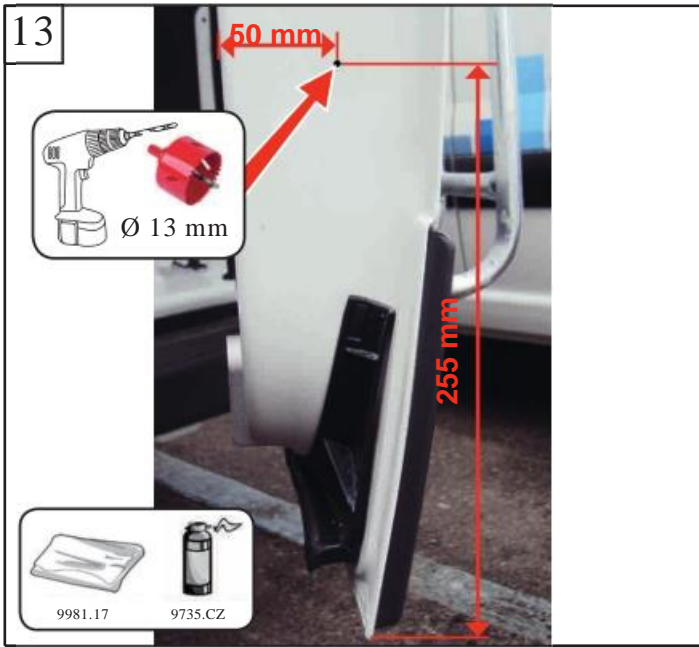

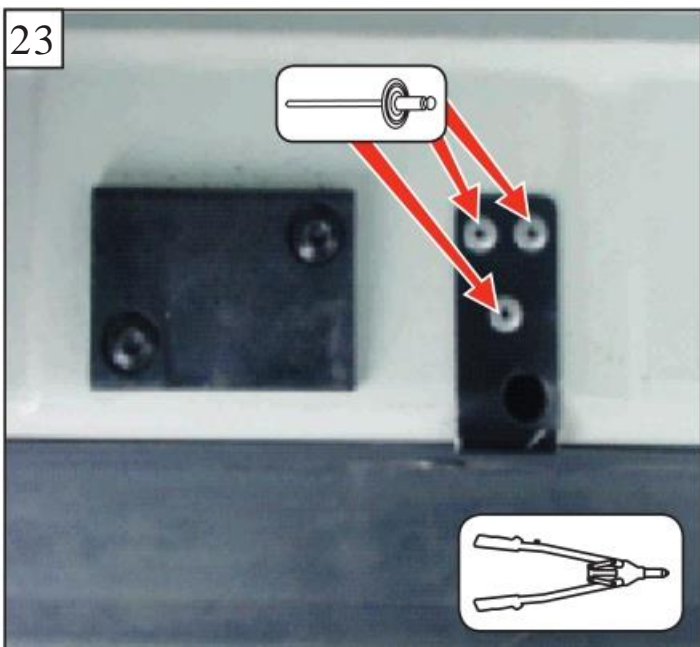
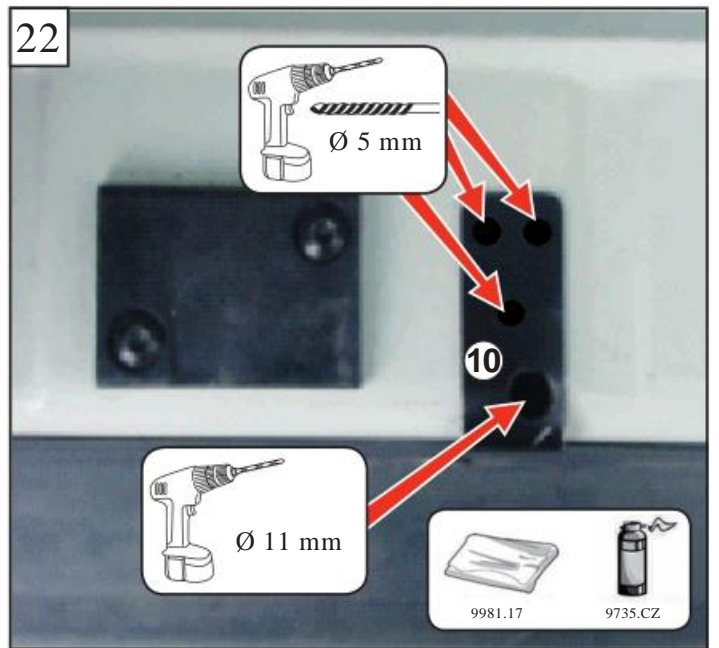
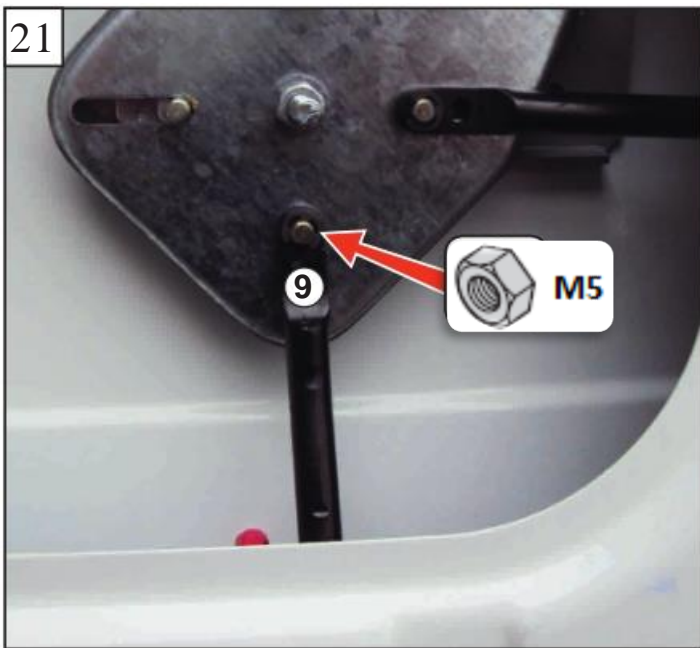
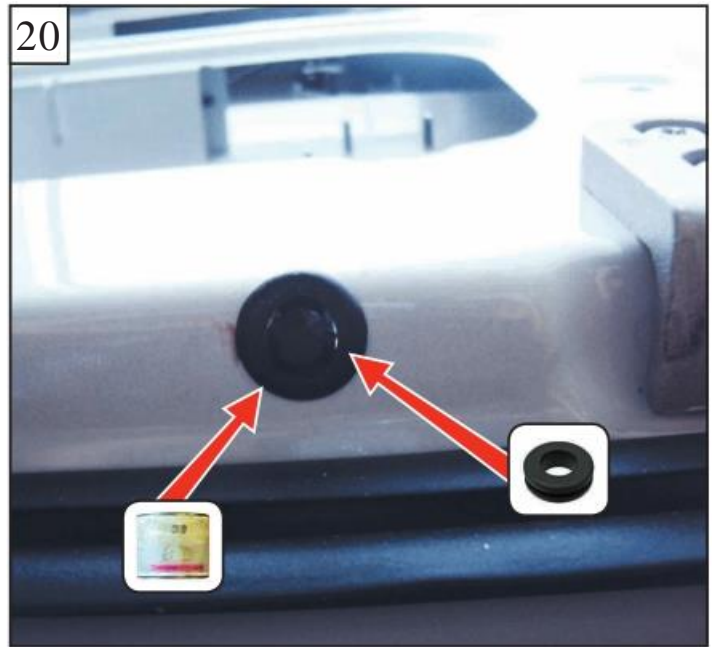
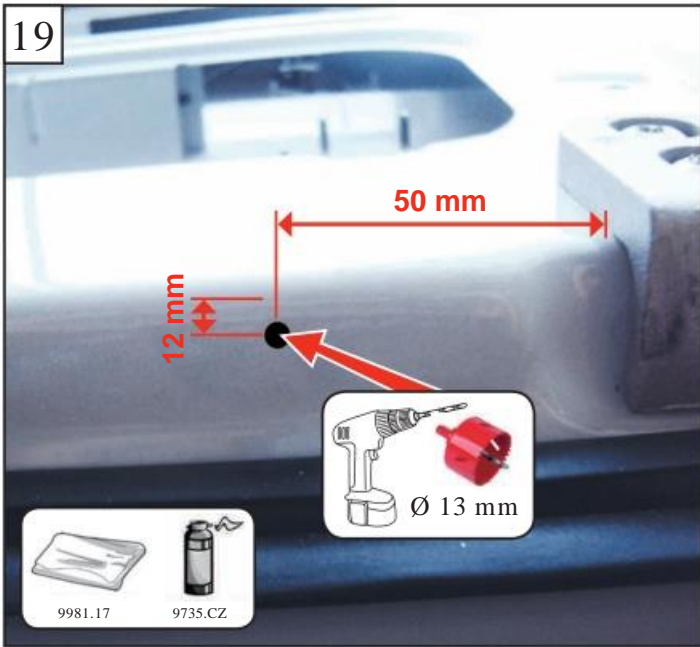

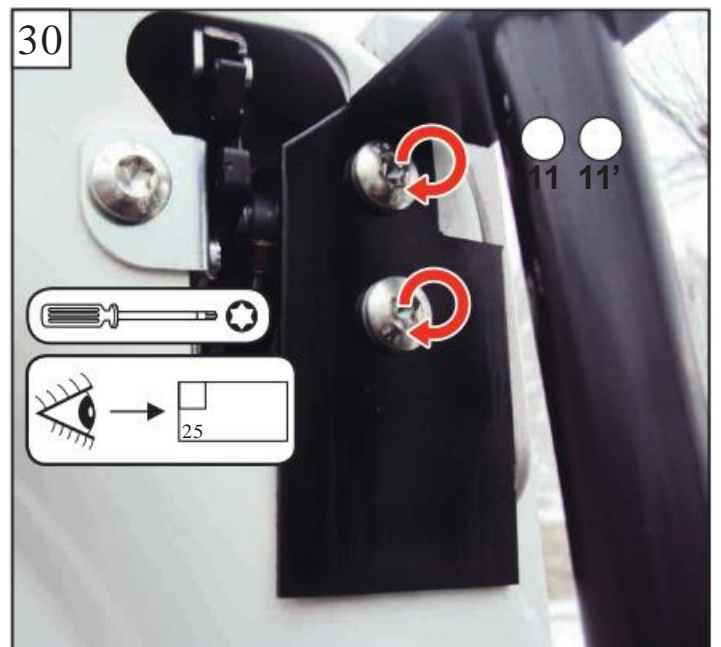
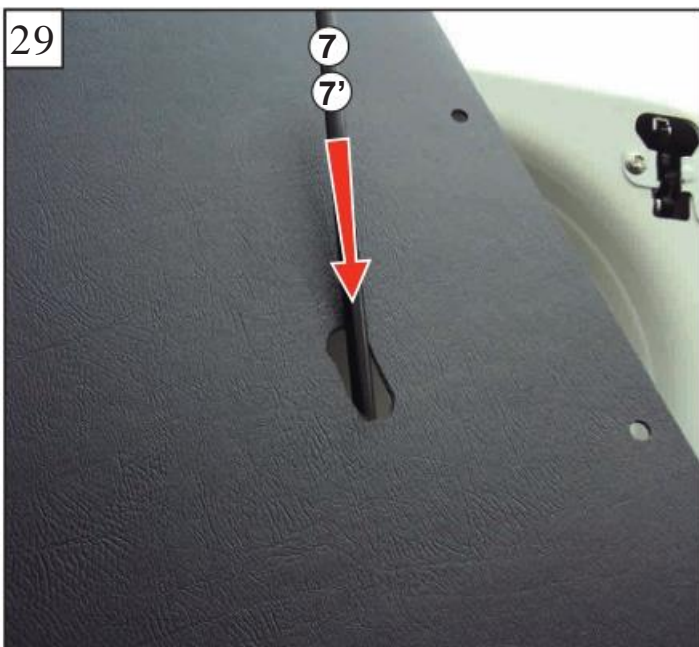
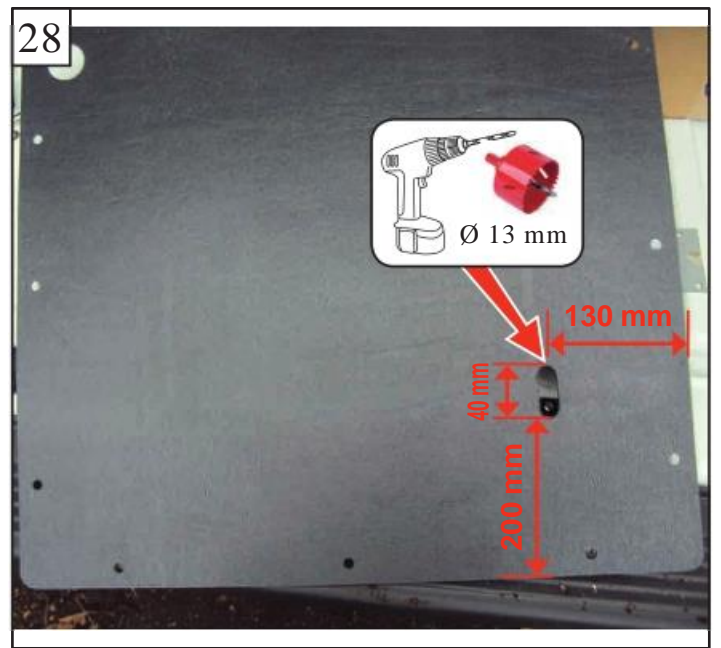
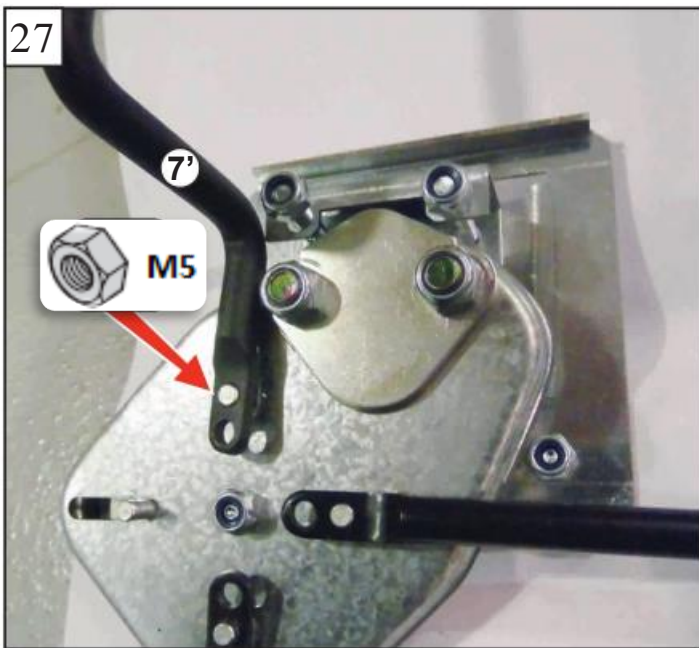
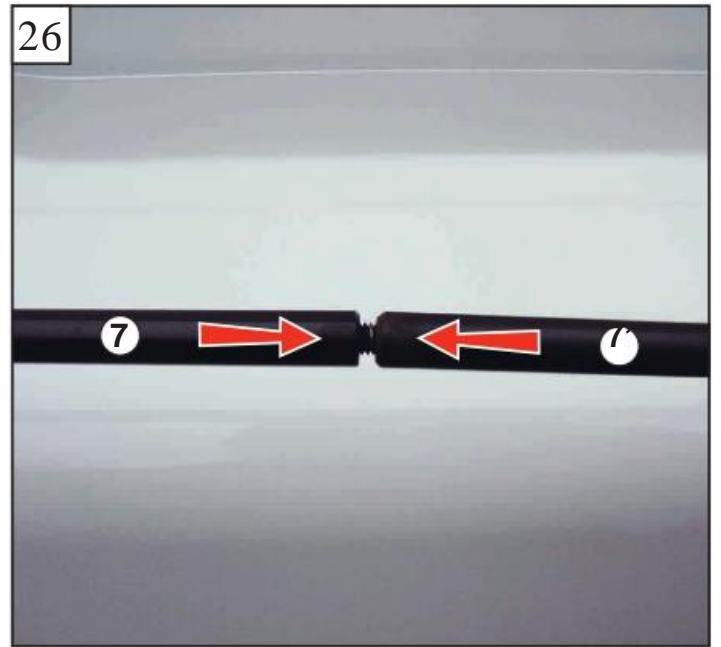
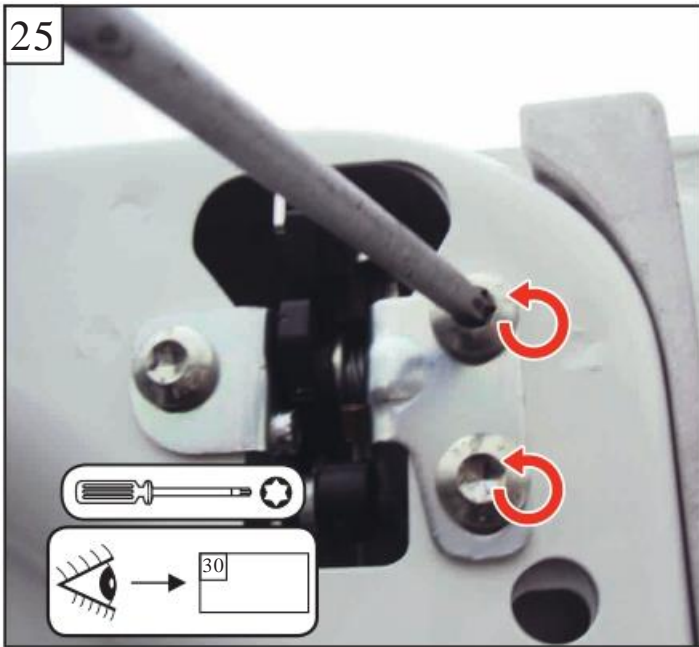

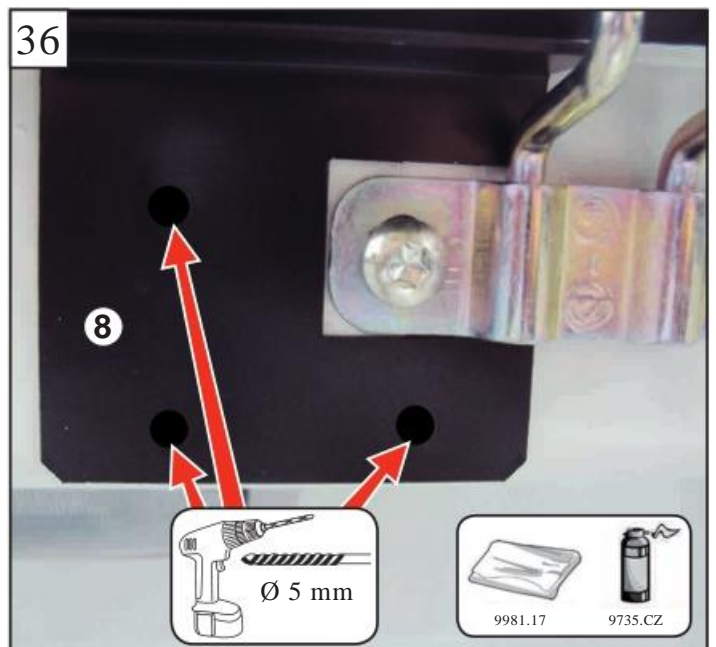
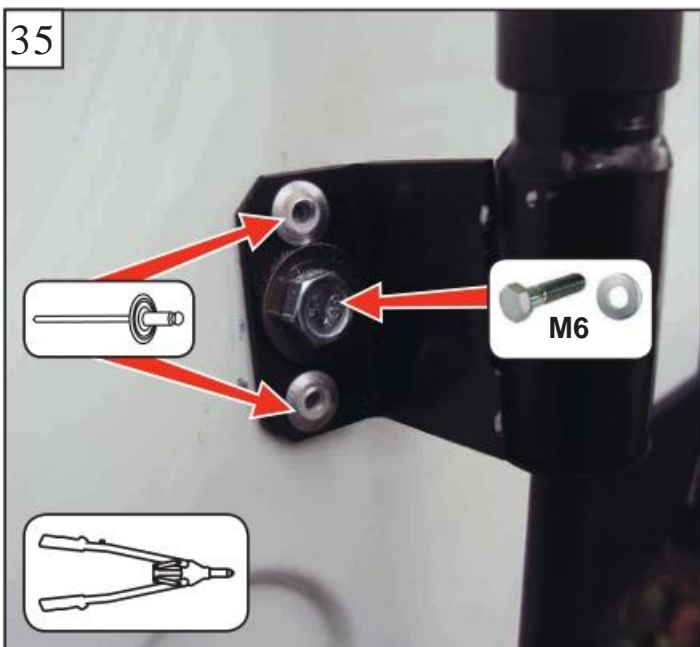
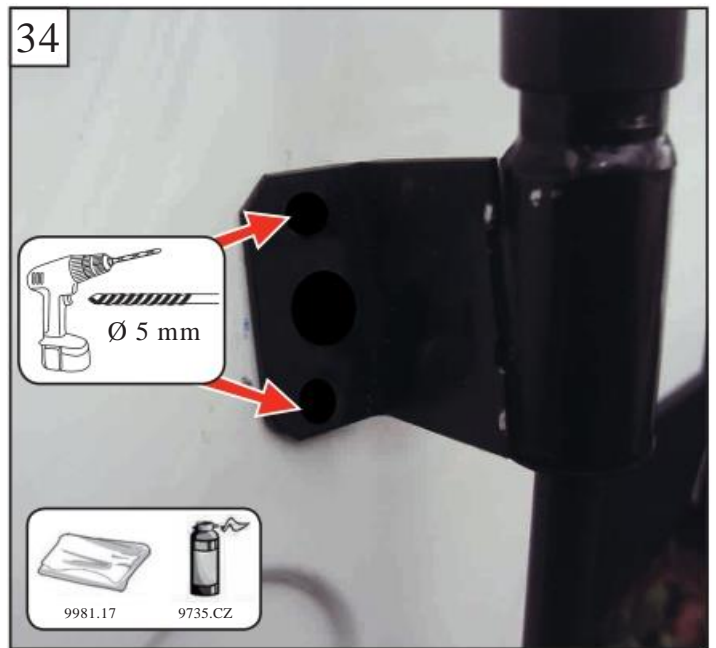
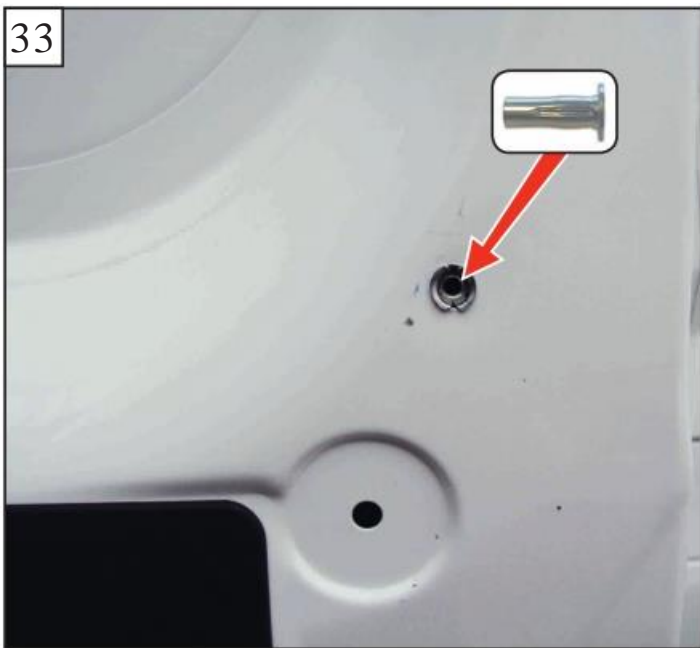
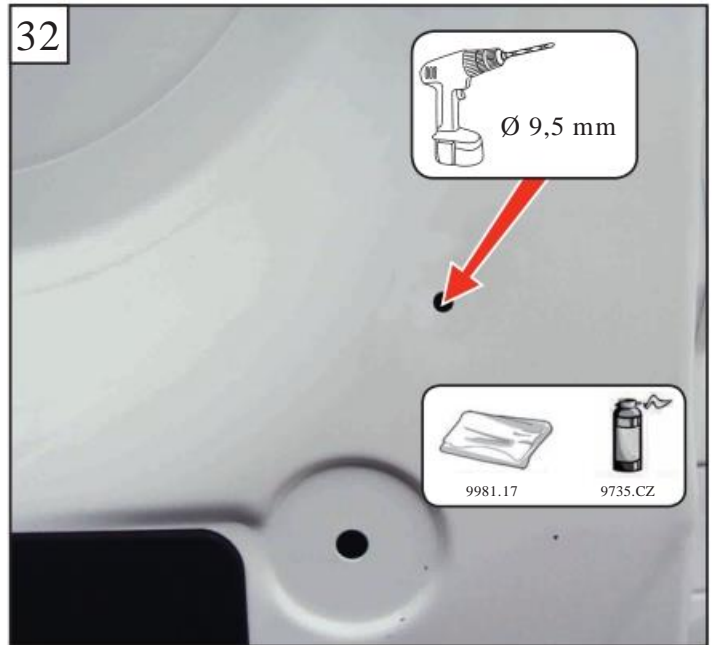
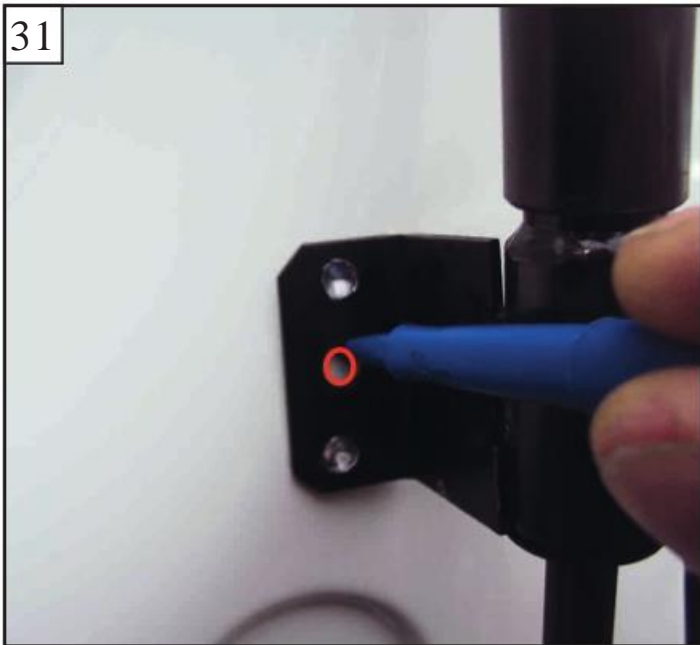

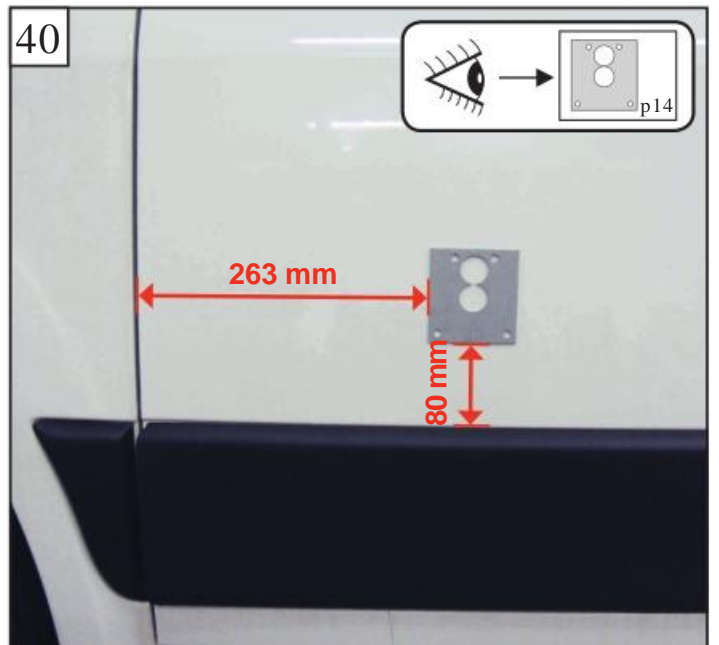
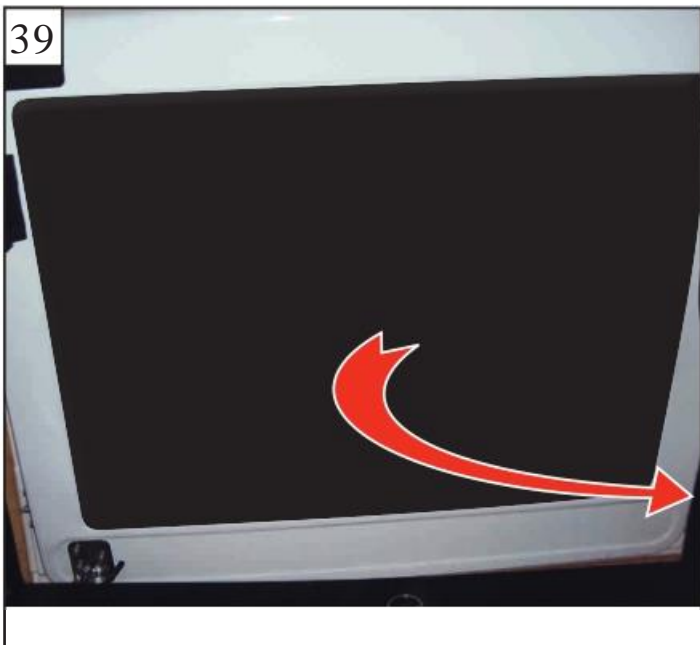
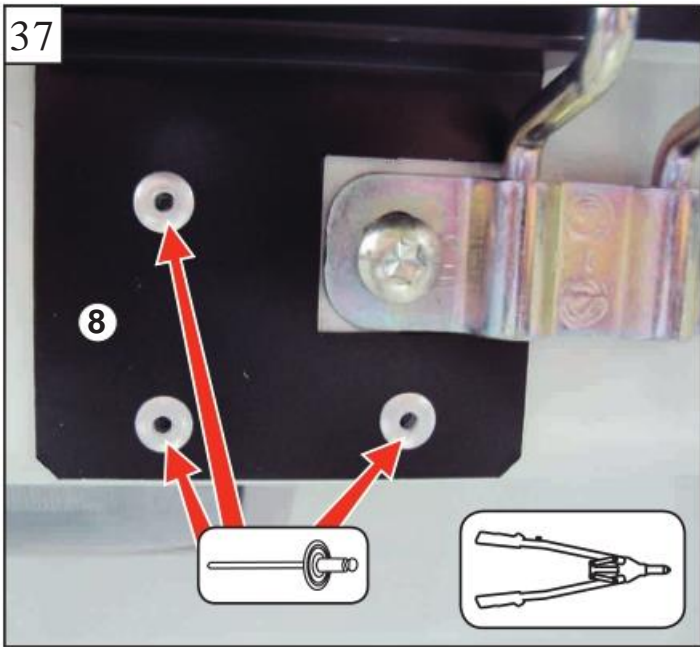

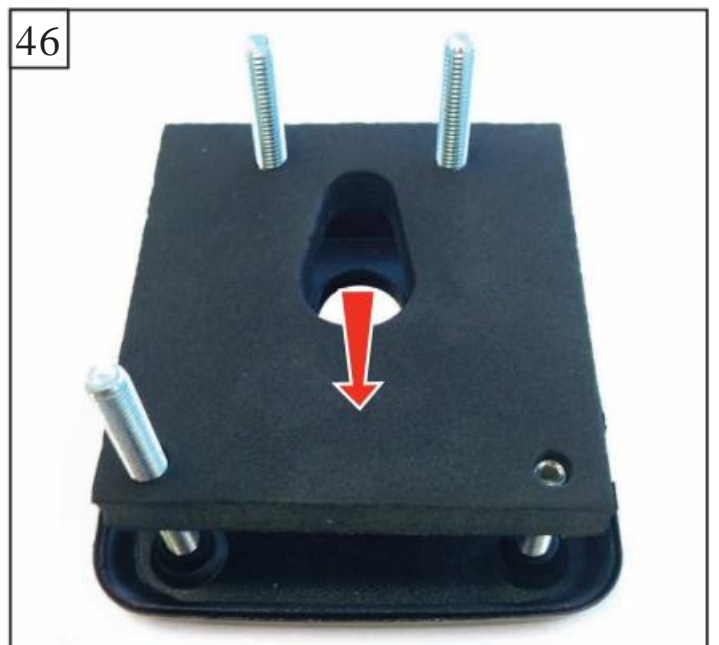
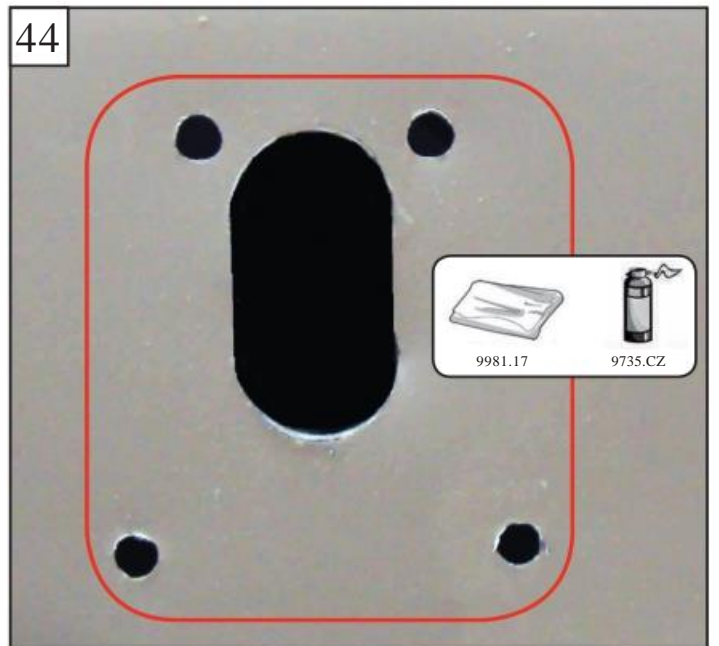
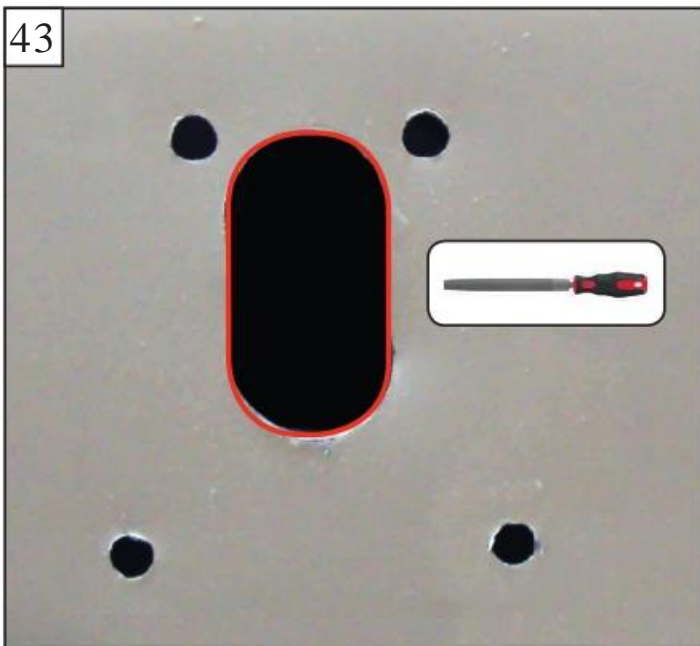
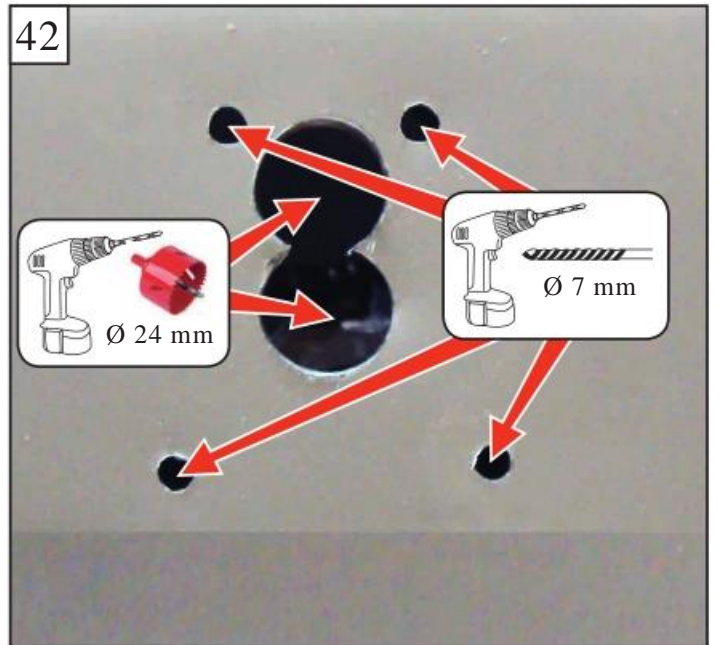
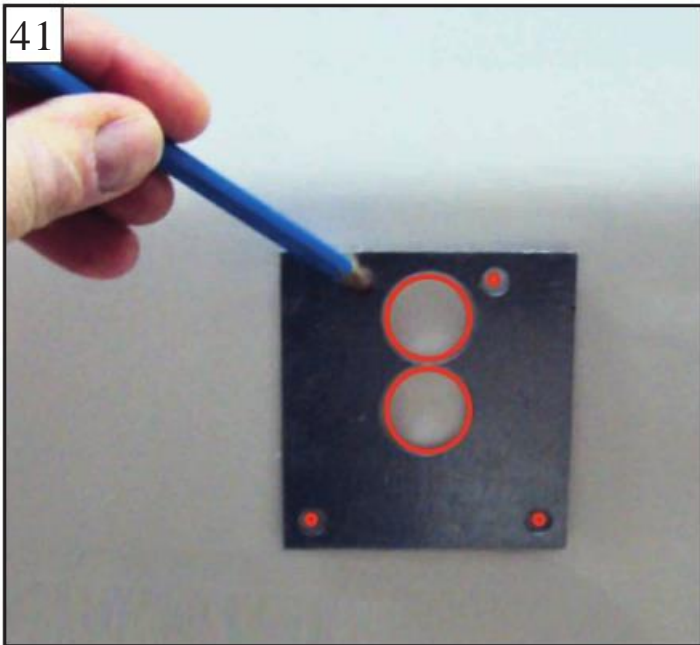

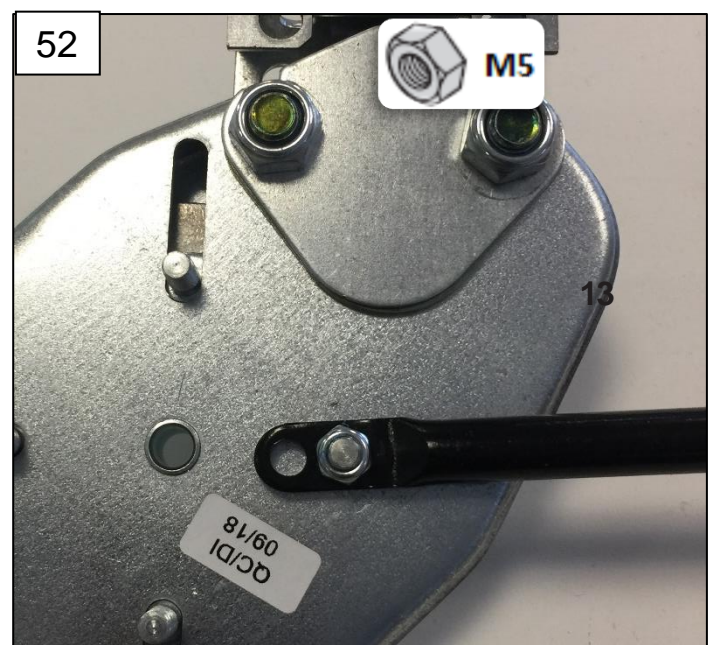
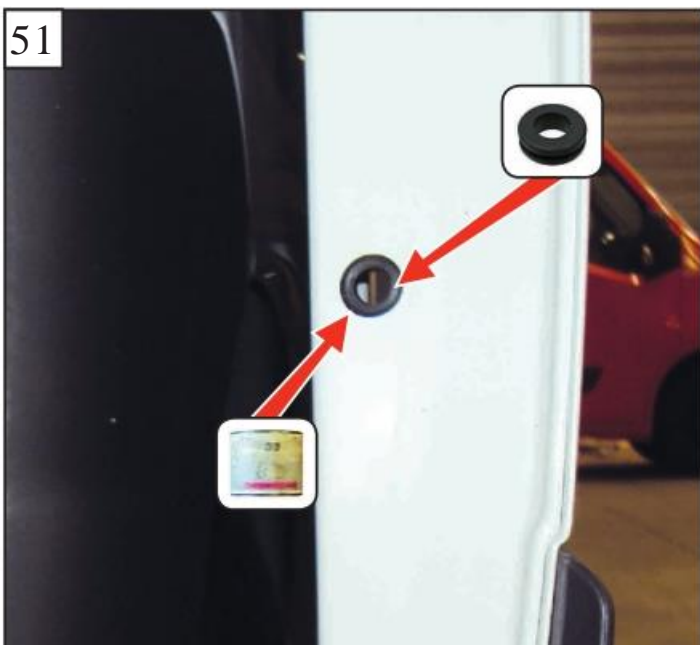
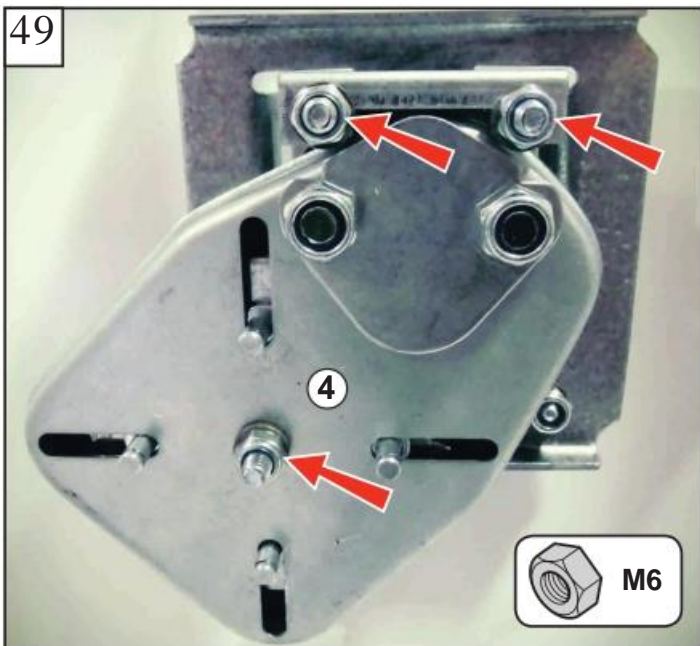
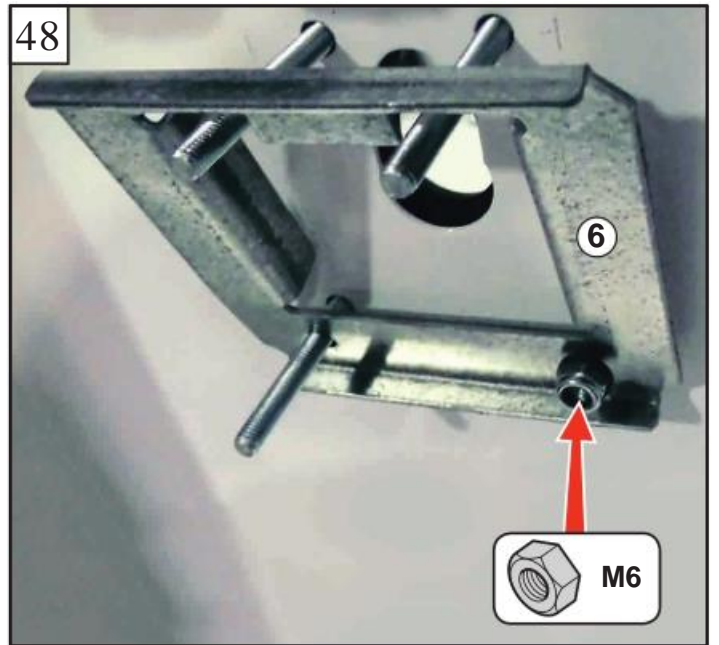
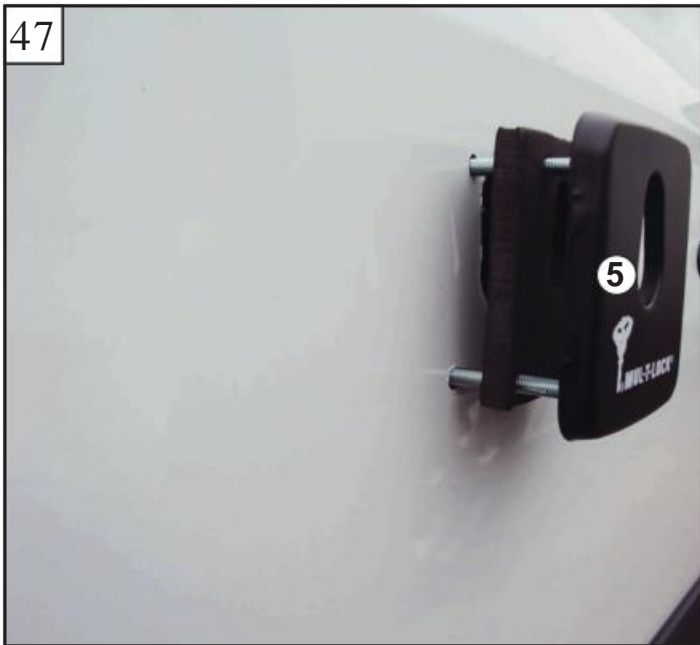

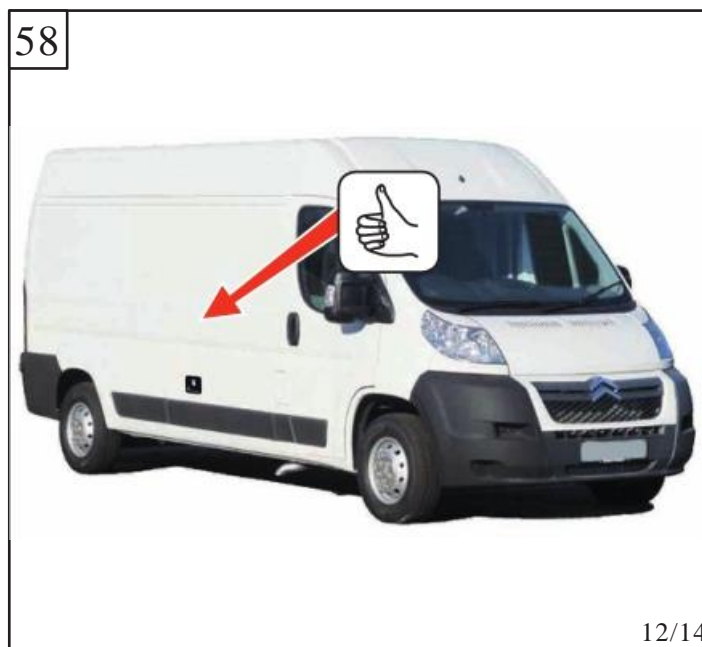
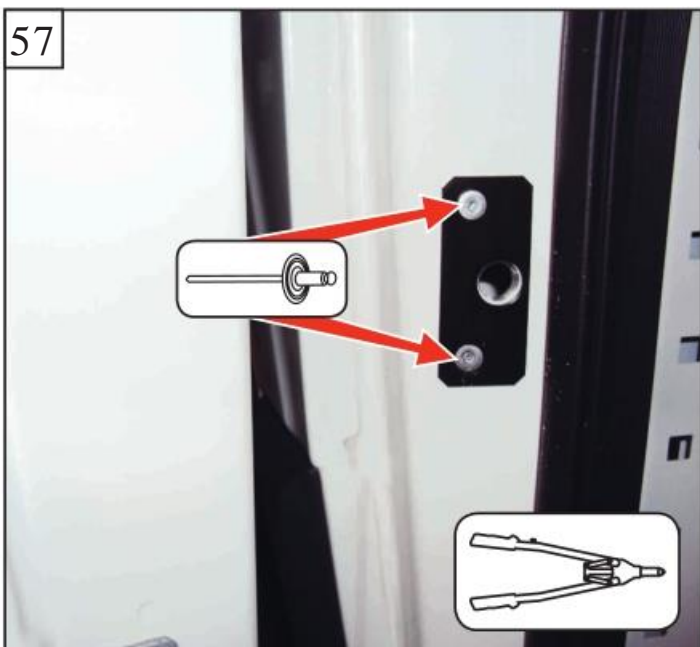
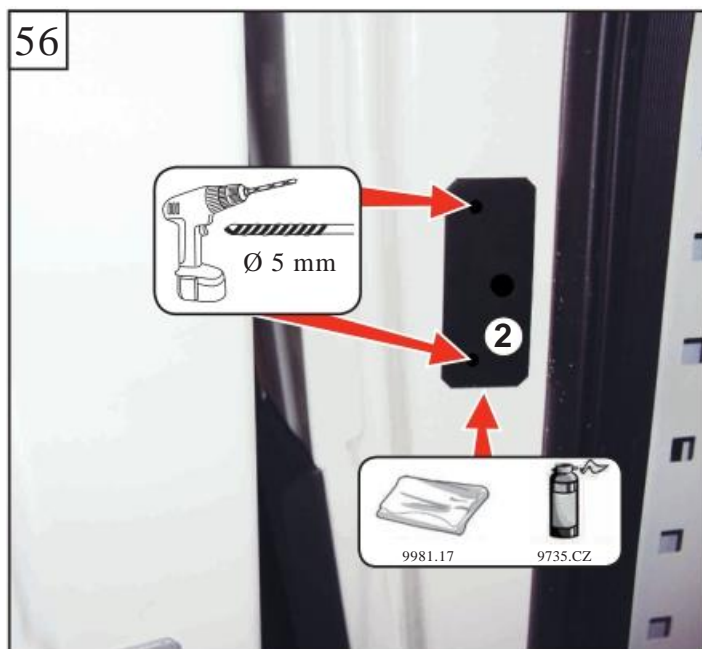
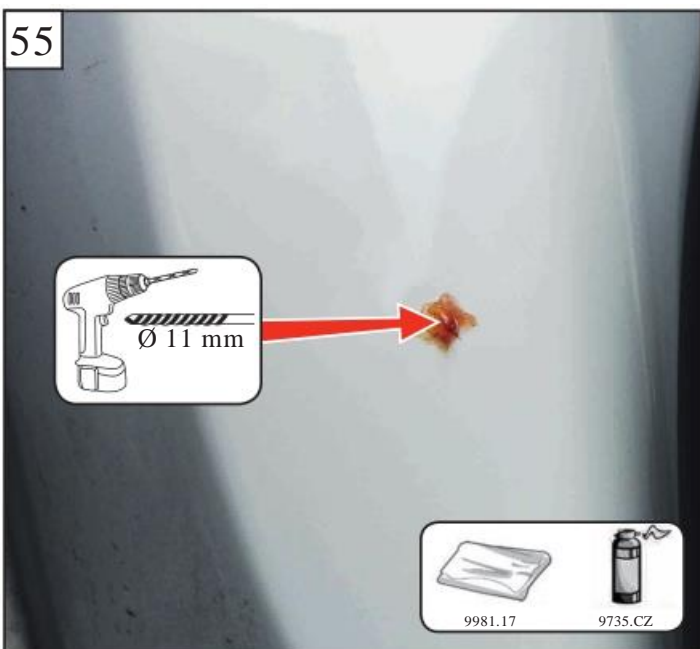
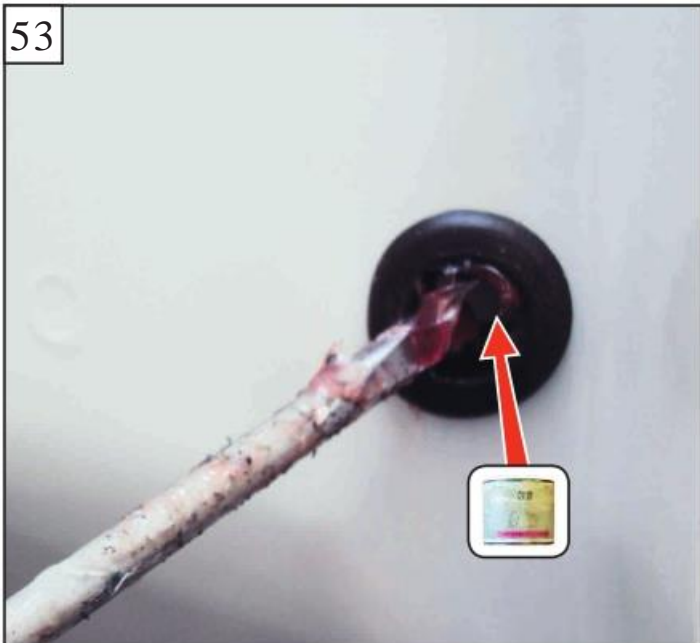

GABARIT DE PERCAGE—SERRURE MUL-T-LOCK

- 1- Imprimer le Gabarit et vérifier l'échelle avant de l'utiliser
- 2- Découper le contour de la zone grise comme indiqué
- 3- Positionner le gabarit selon les indications de la notice
- 4- Repérer les points de perçage
- 5- Effectuer le perçage

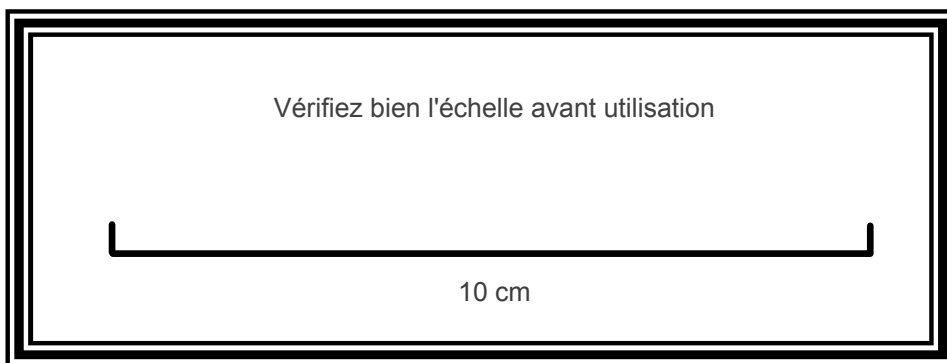
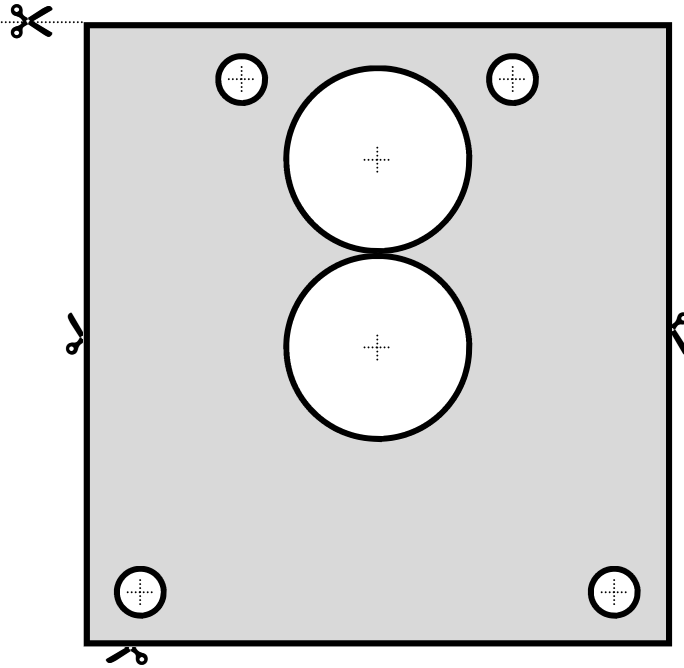



DIVISION AUTOMOBILE MUL-T-LOCK

**533 AVENUE DU GENERAL DE
GAULLE**

92140 CLAMART

Tél : 01 41 28 39 70

Fax : 01 69 53 01 85

www.mul-t-lock.com

Support commercial

01.41.28.39.70

adv@mul-t-lock.fr

Support technique

06.62.91.58.58

automobile@mul-t-lock.fr