



**ASSA ABLOY**  
Une marque du Groupe ASSA ABLOY



## NOTICE DE MONTAGE

- ↪ **KIT 3 POINTS (PORTE ARRIÈRE)**
- ↪ **KIT 1 POINT (PORTE LATÉRALE)**

### MODÈLE CITROËN JUMPY III

**L1- H1 et L2 - H1**

**L3 - H1**

**Année : 2016 - À ce jour**

### MODÈLE PEUGEOT EXPERT III

**L1- H1 et L2 - H1**

**L3 - H1**

**Année : 2016 - À ce jour**





# MONTAGE DU KIT 3 POINTS

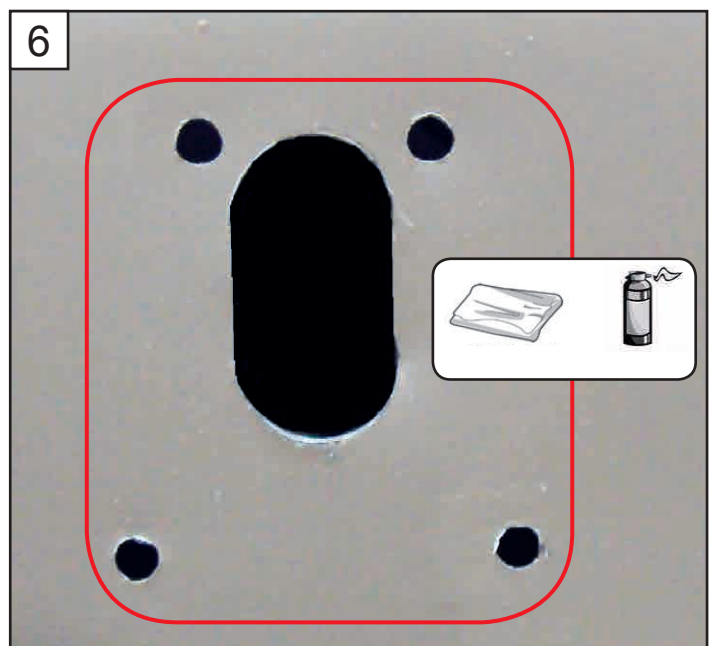
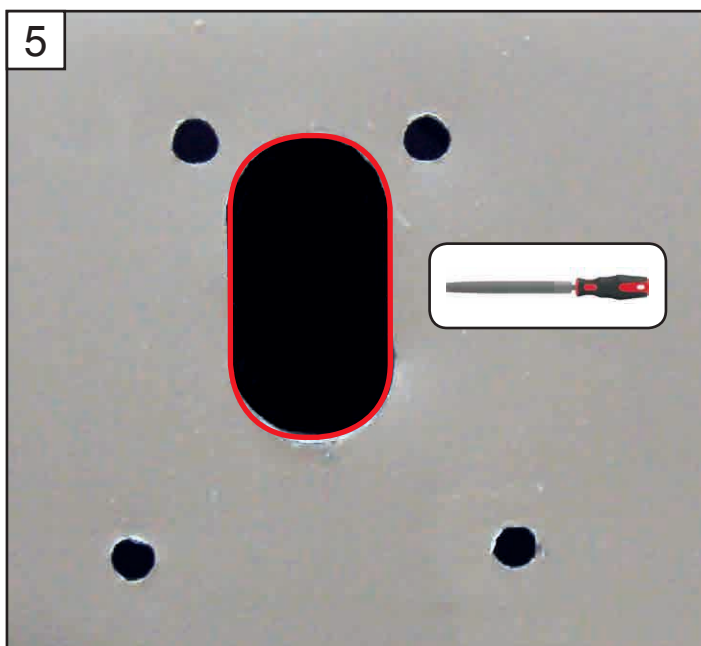
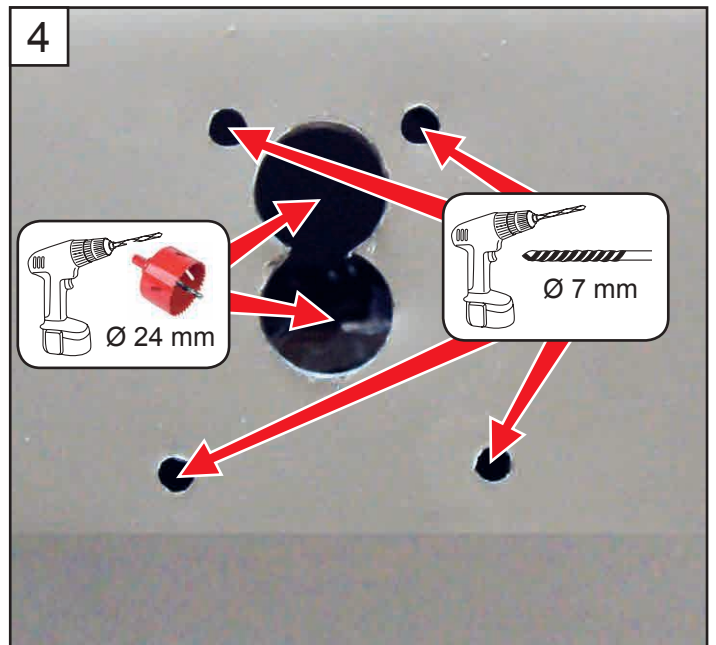
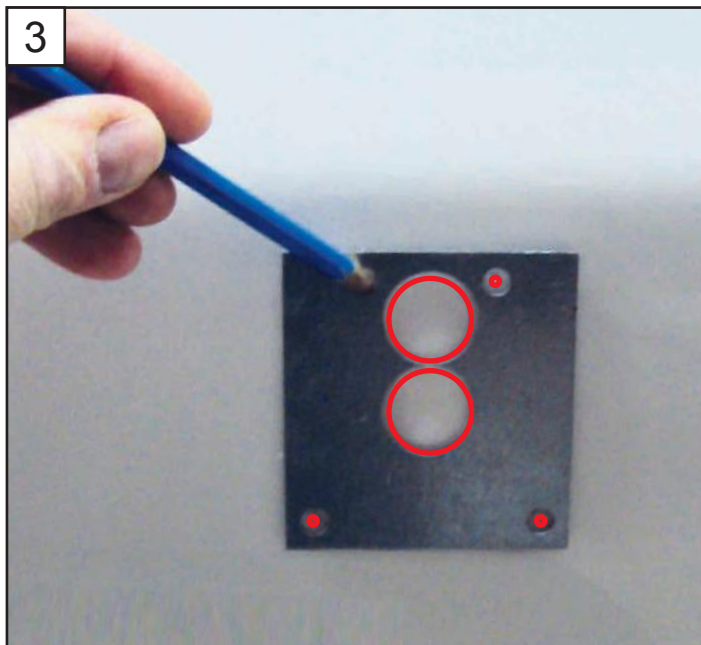
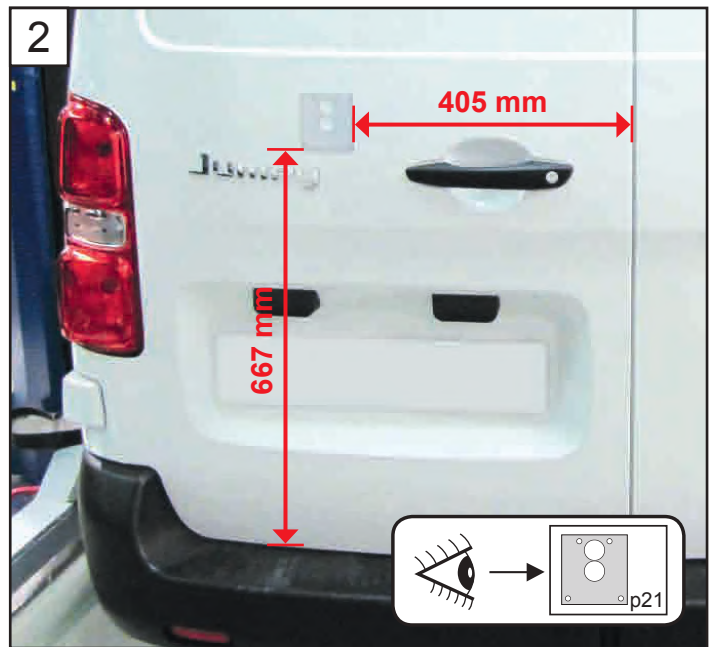
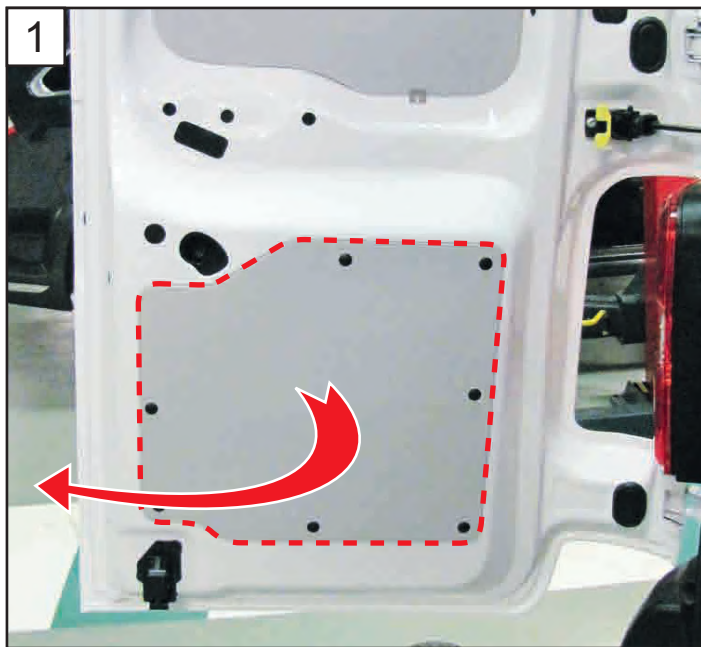

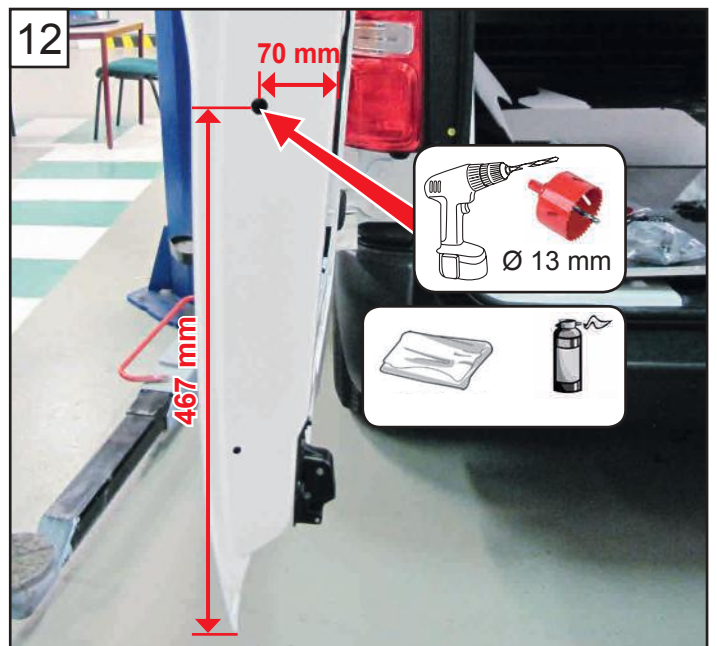
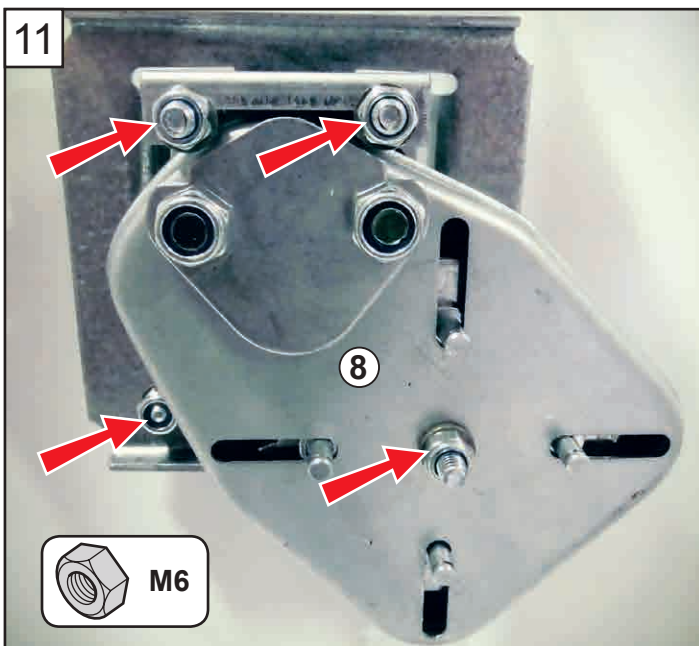
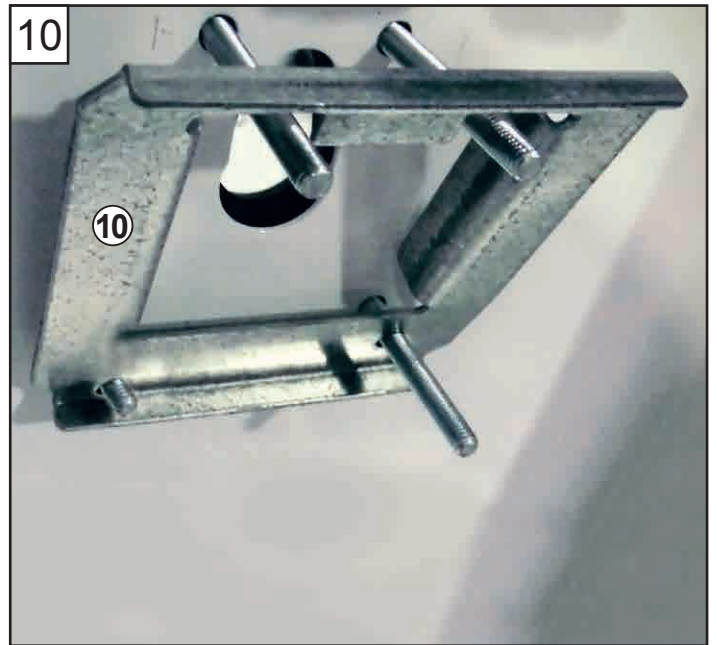
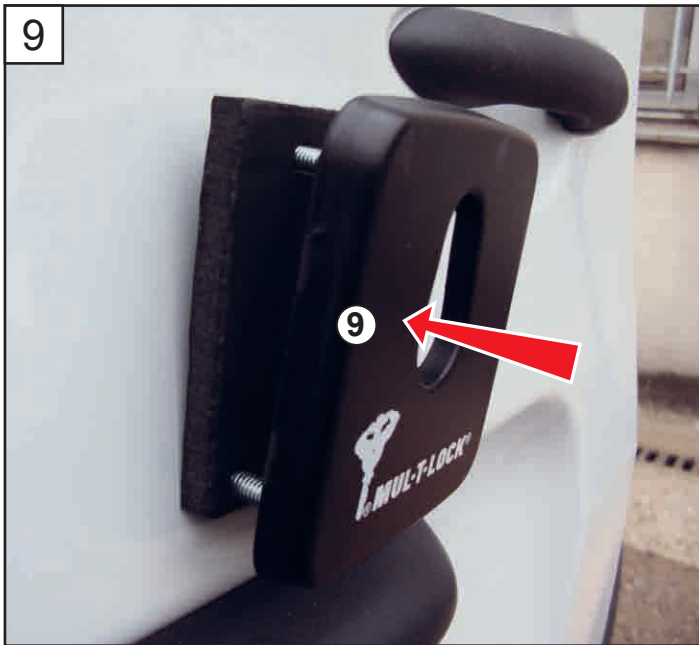
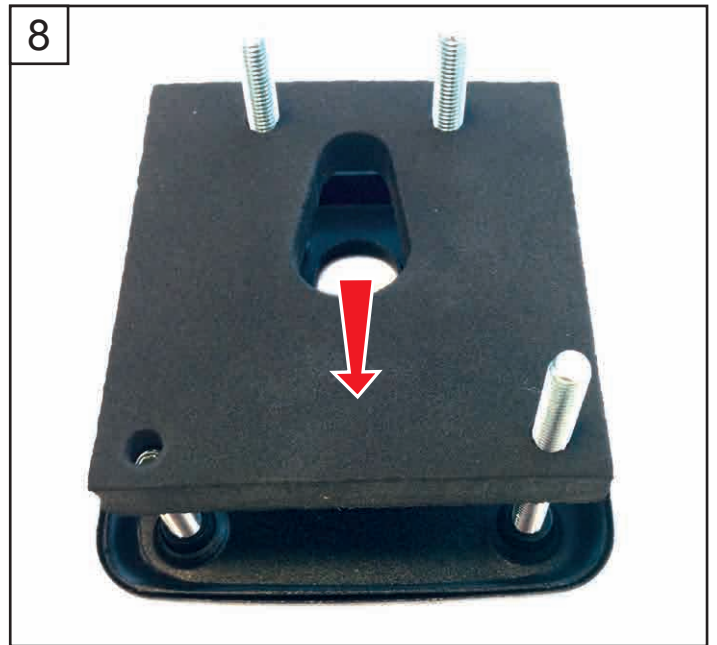
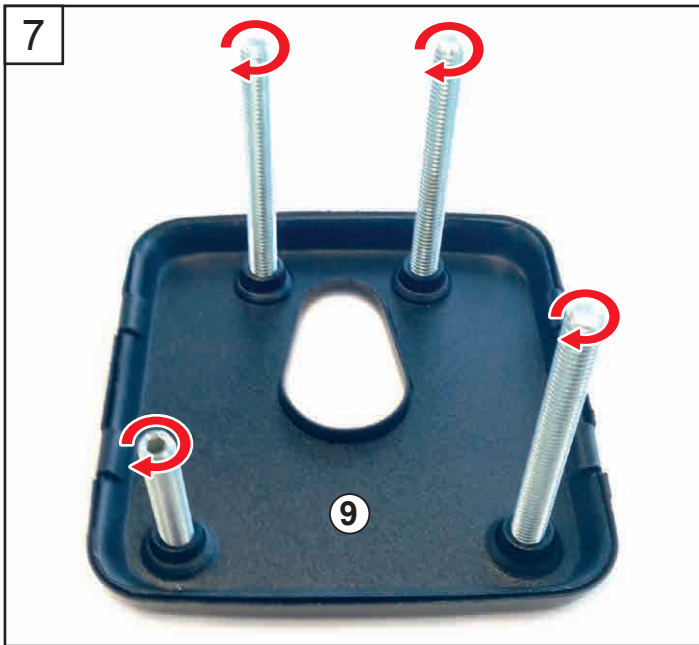

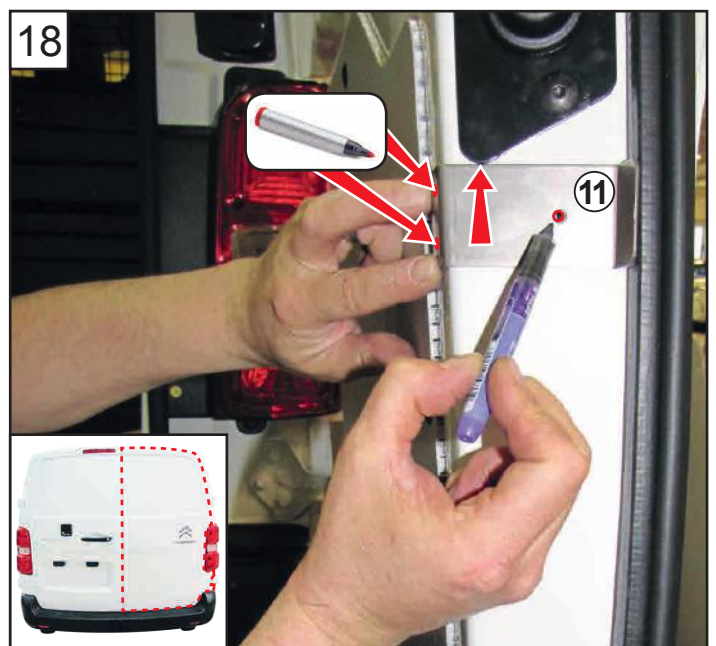
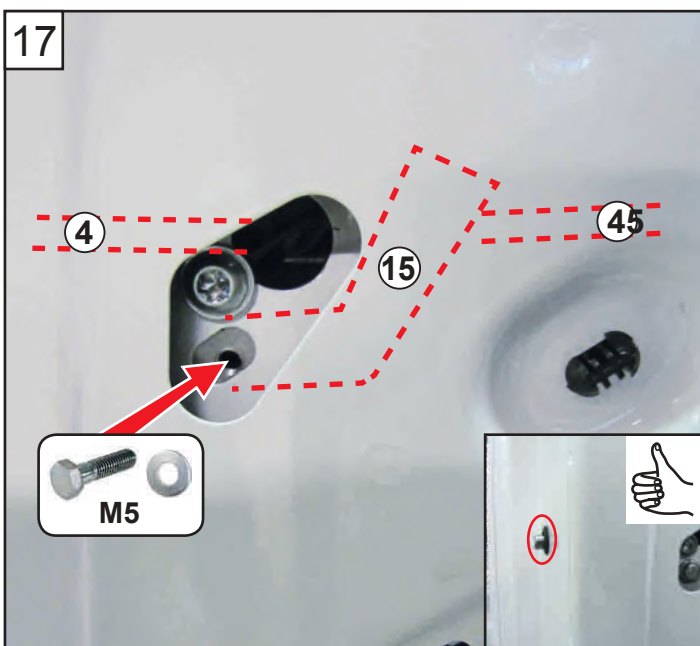
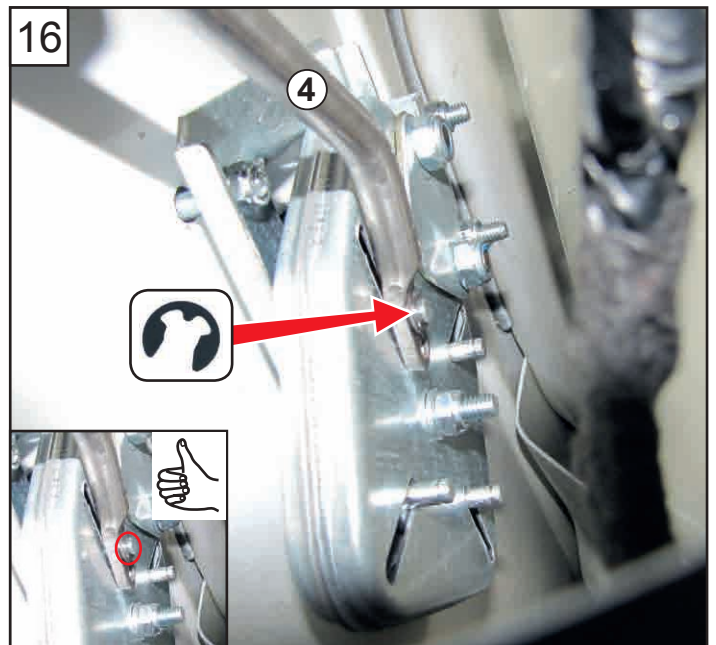
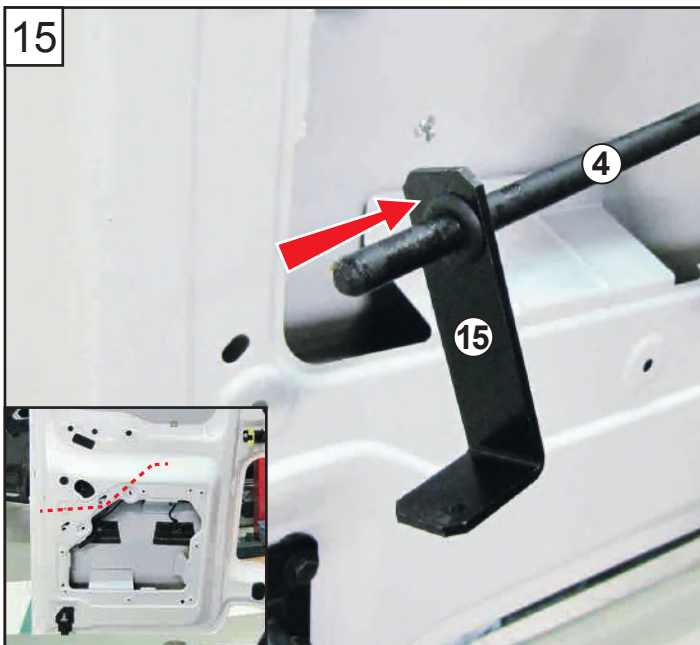
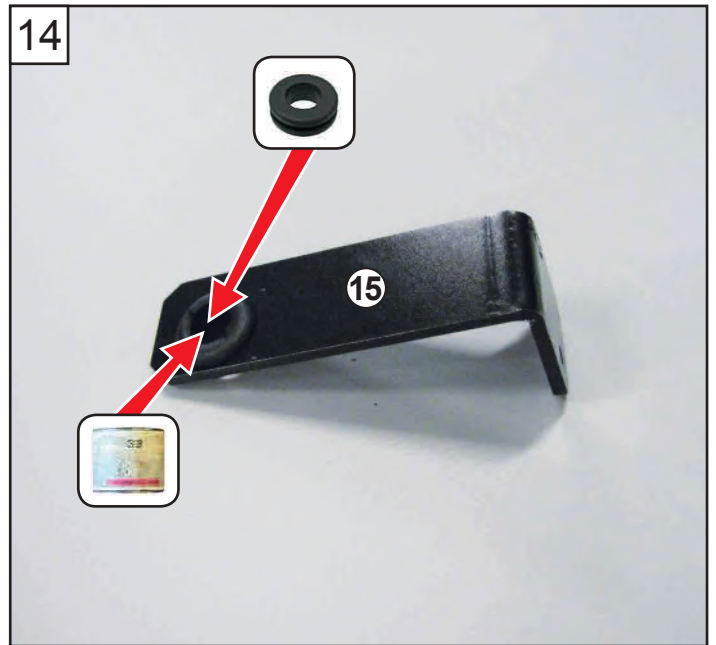
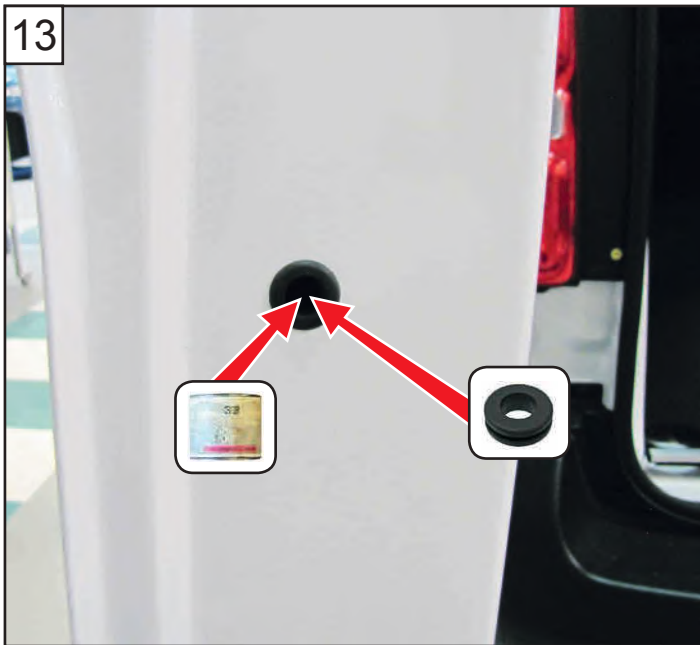

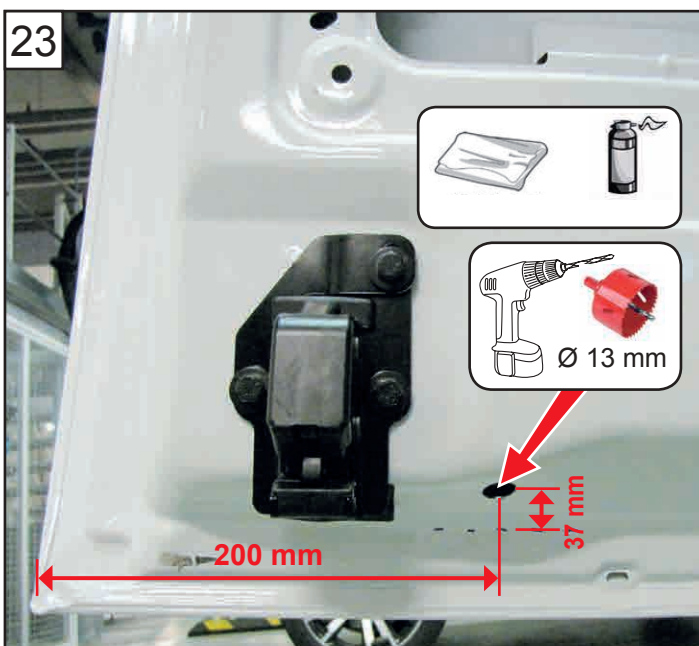
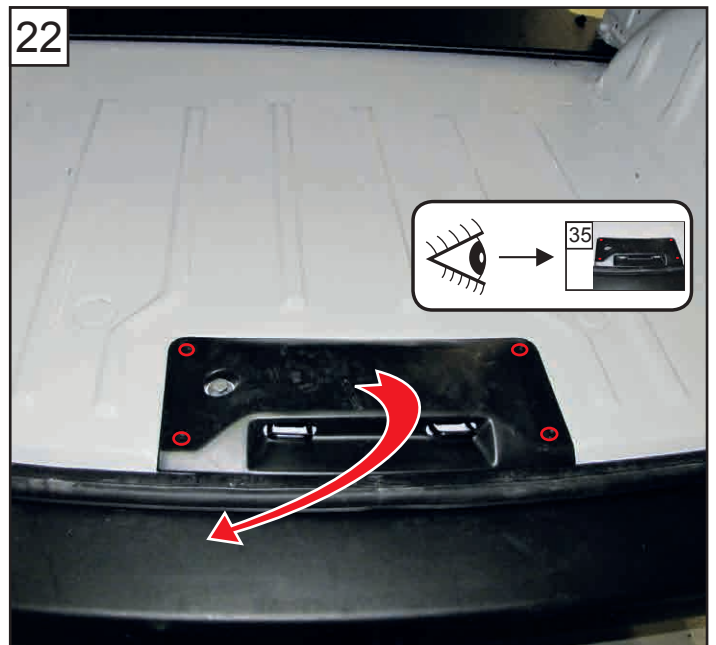
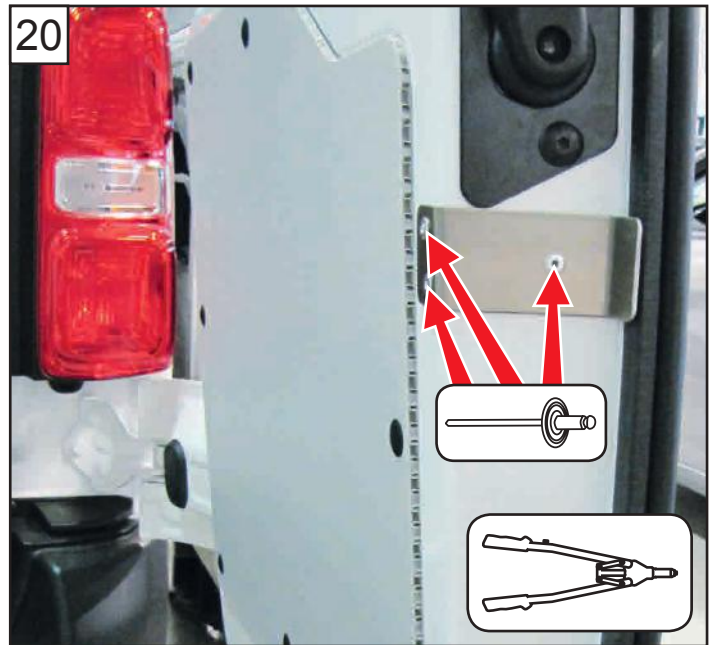
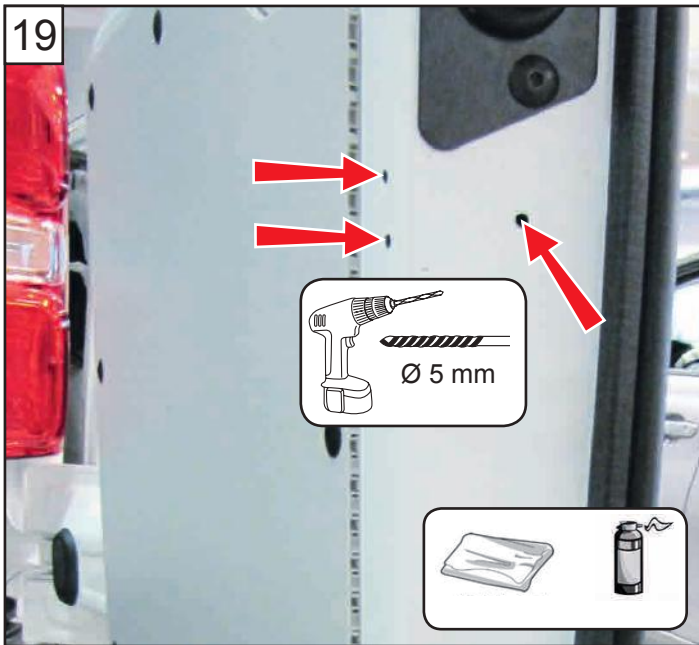

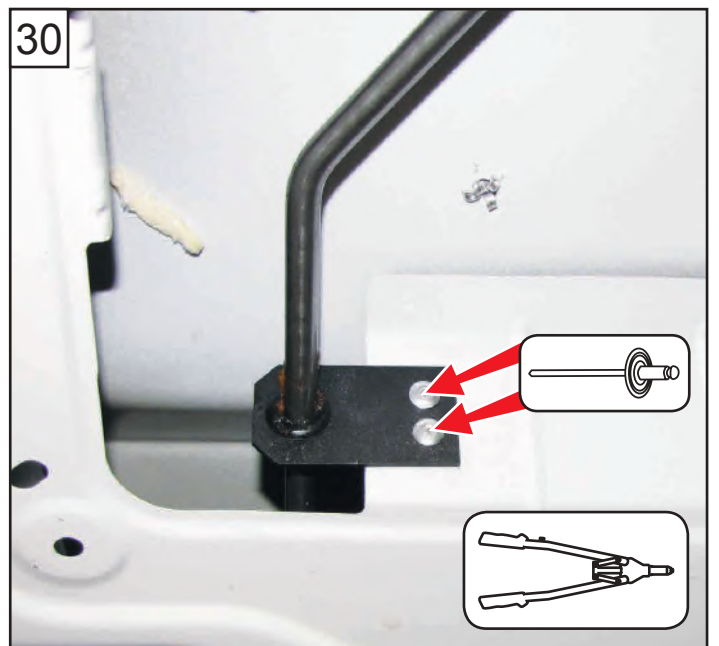
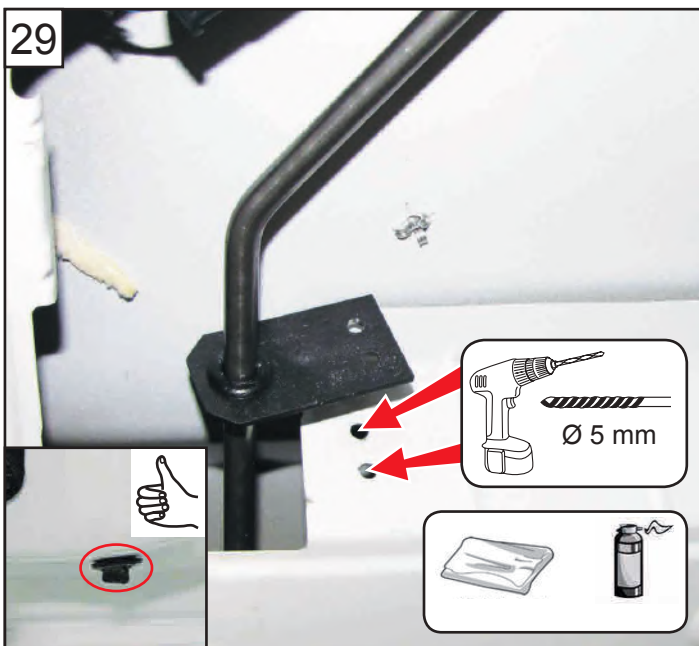
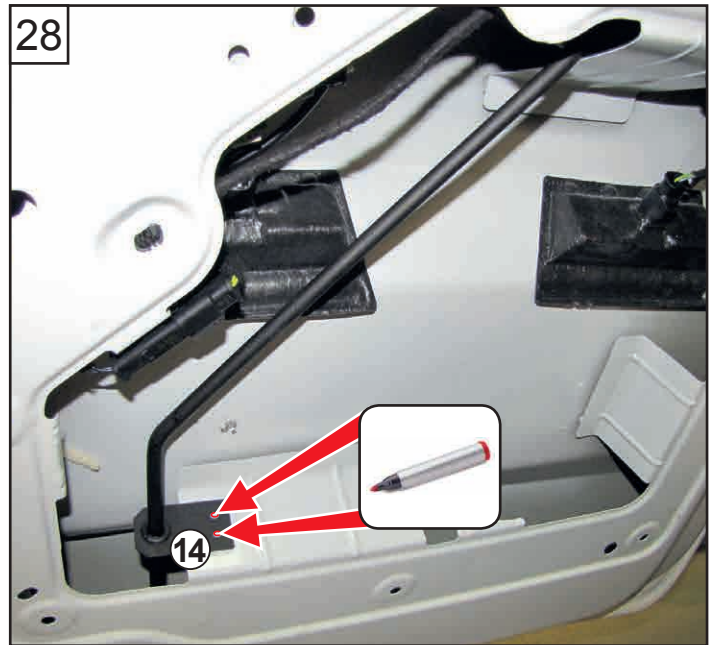
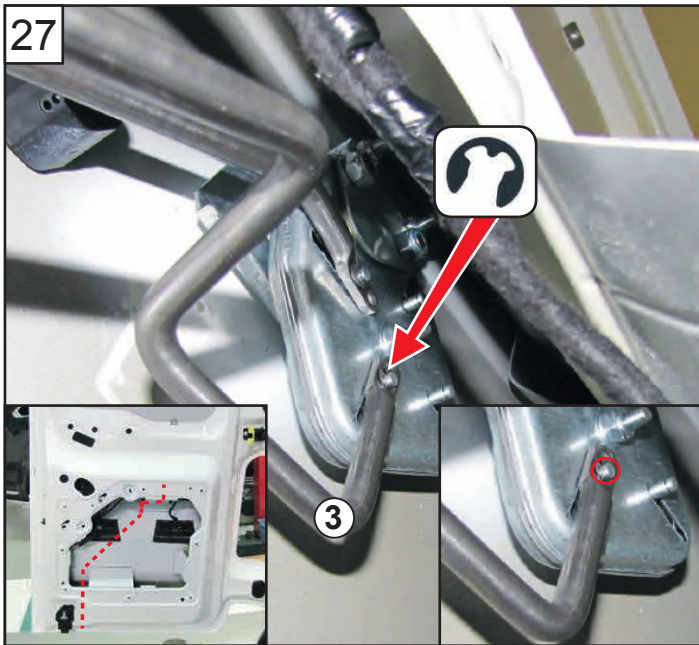
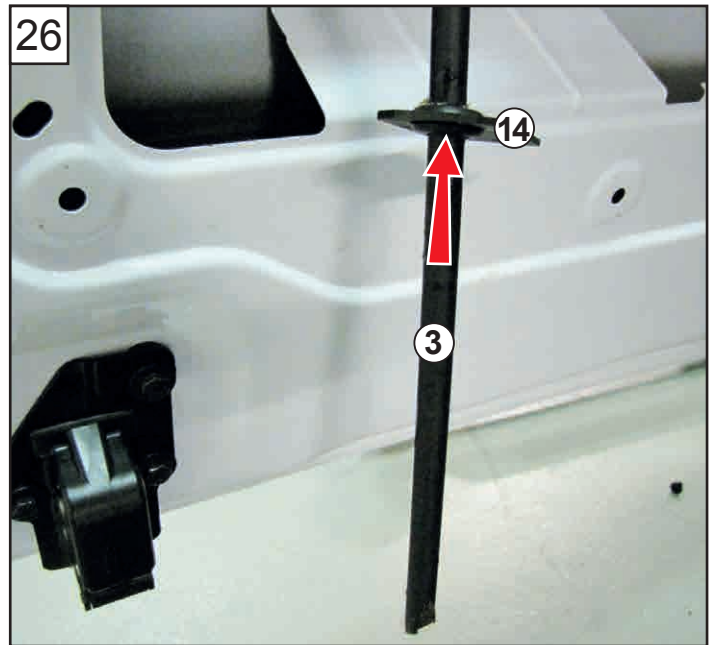
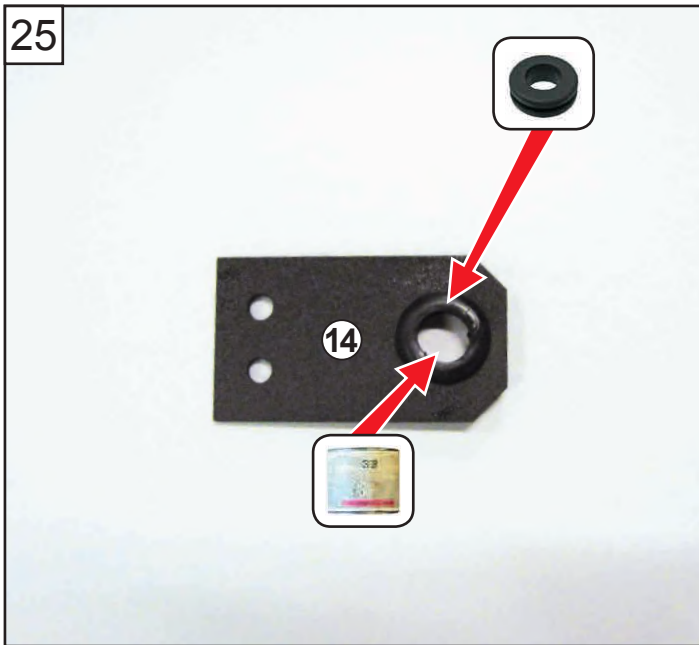

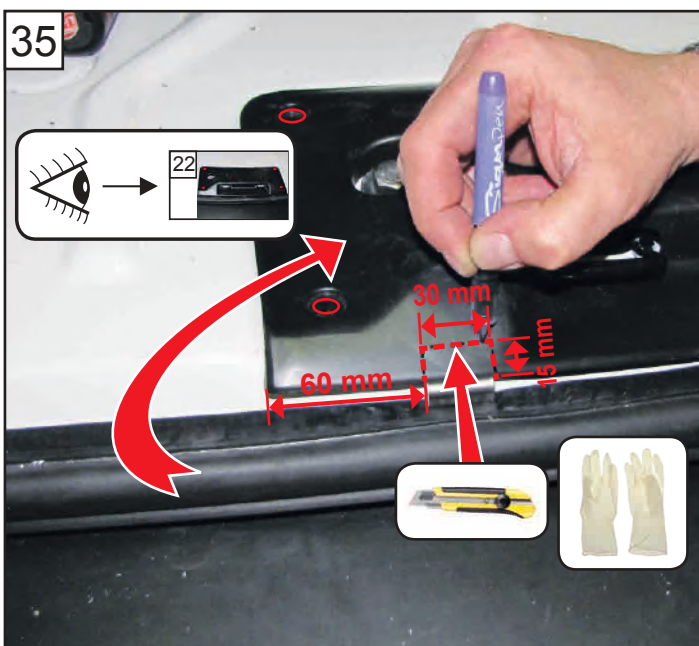
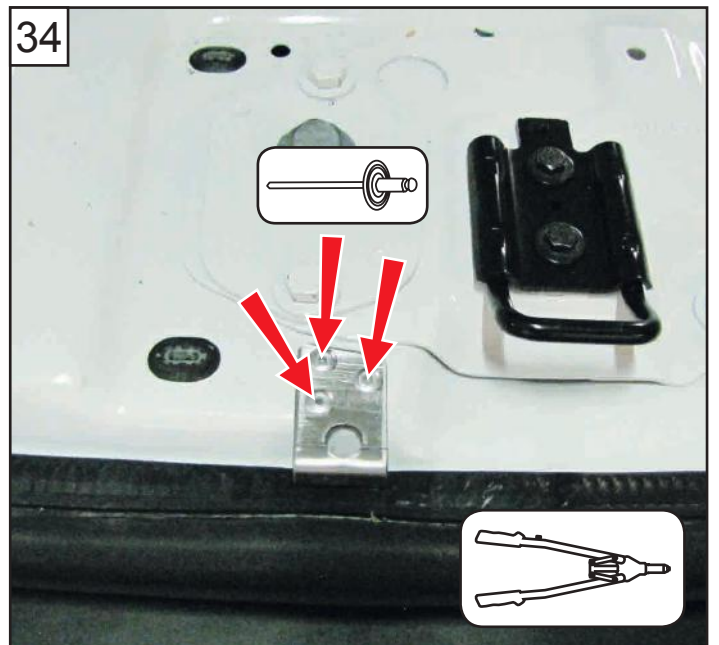
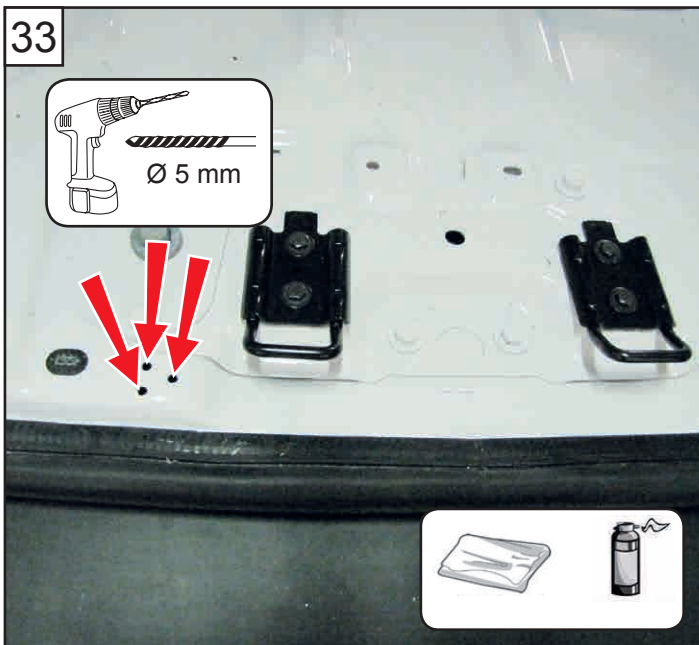
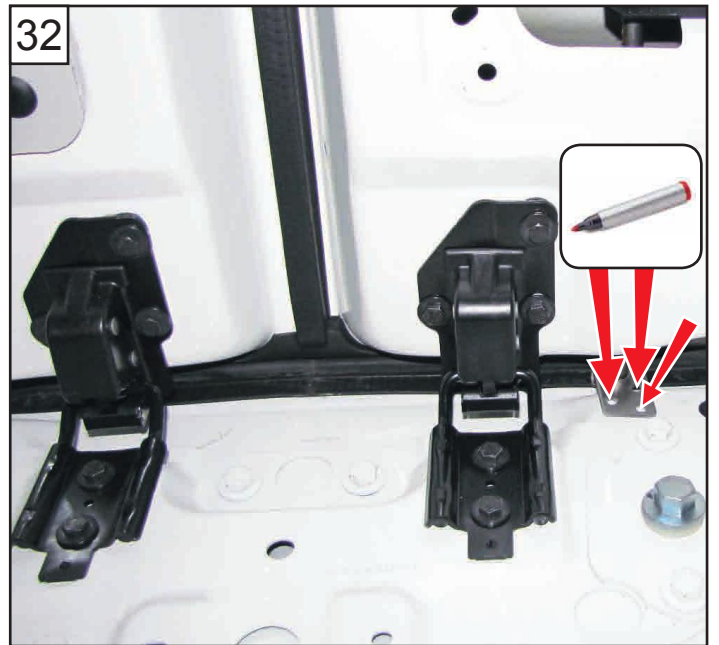
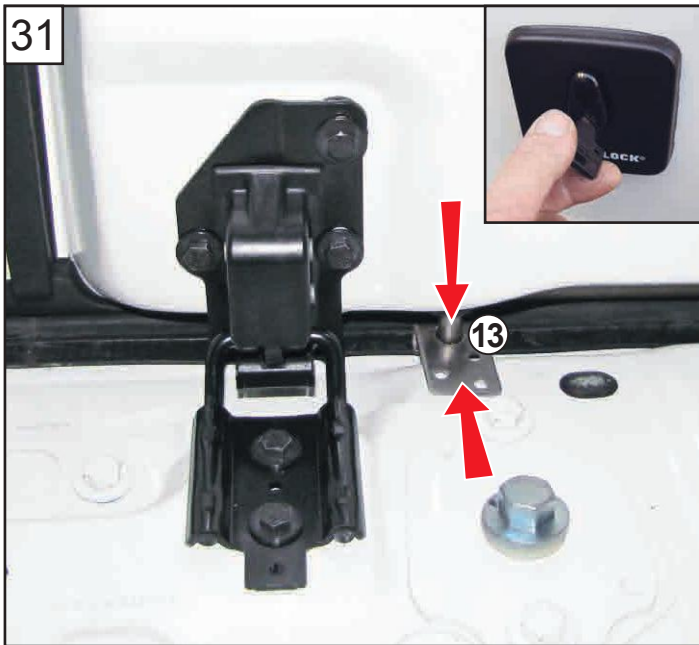



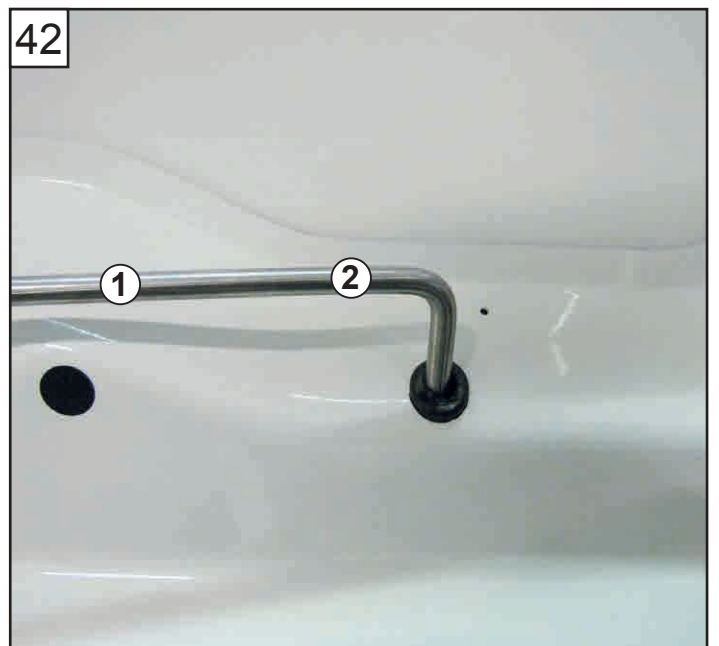
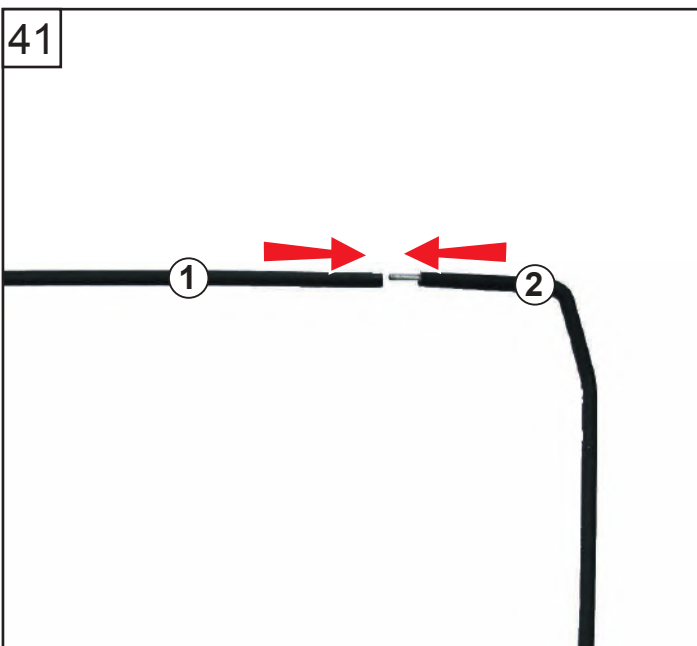
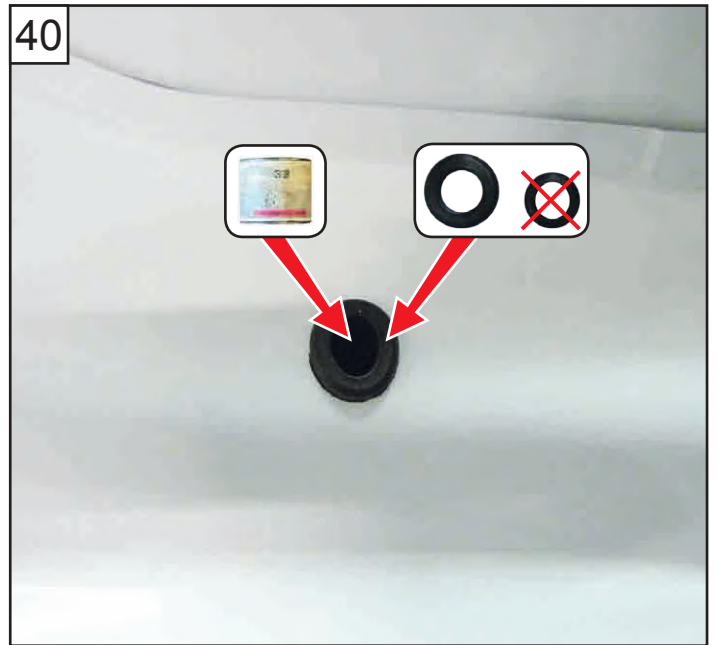
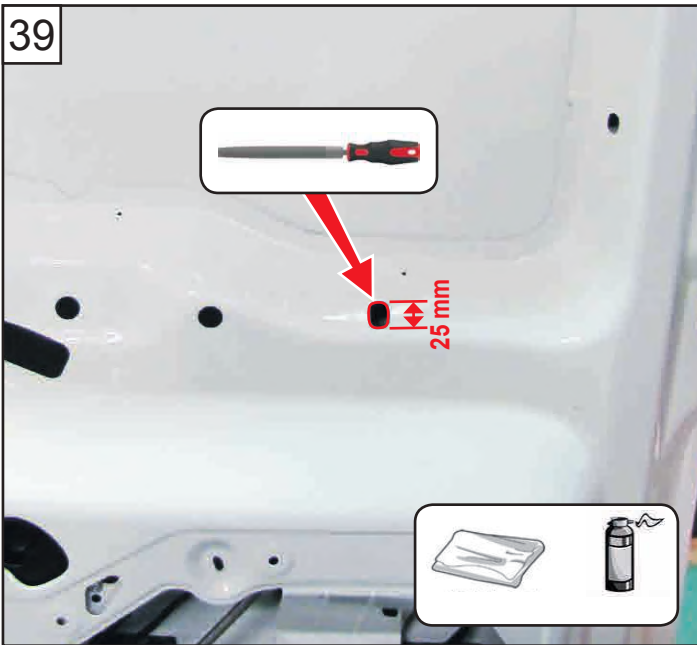
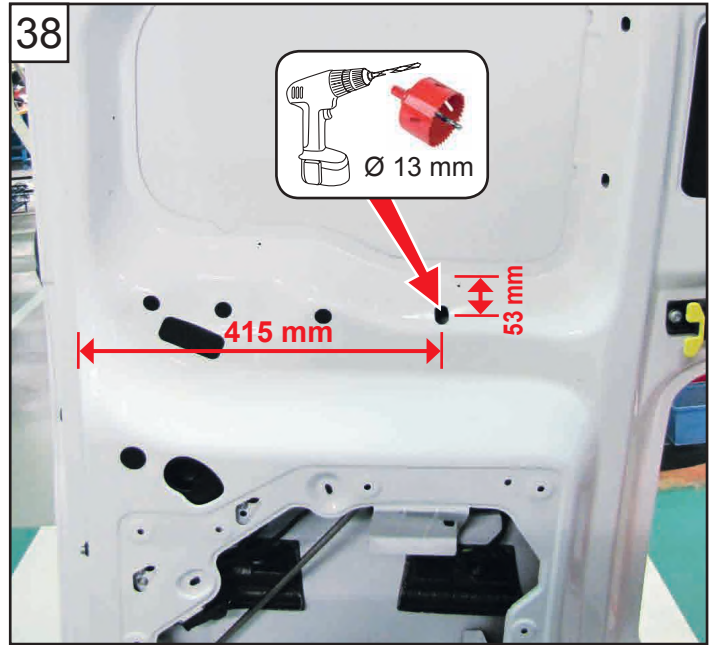

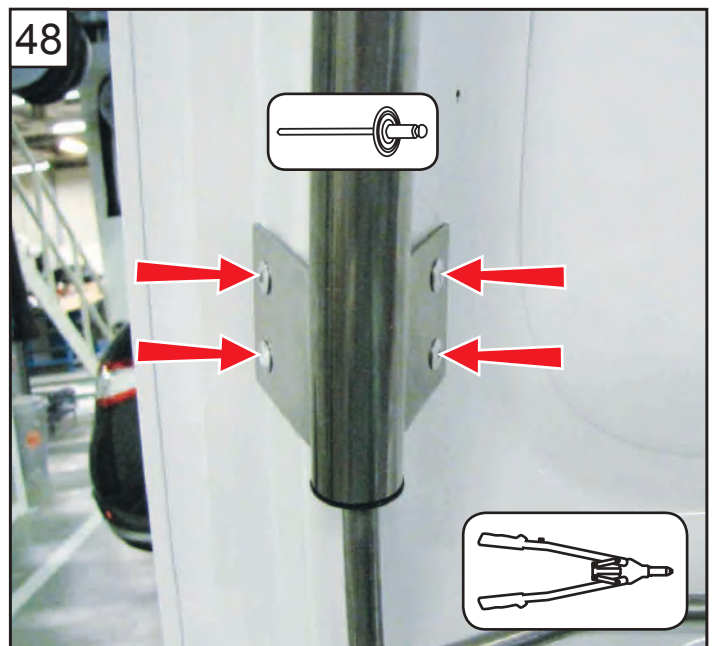
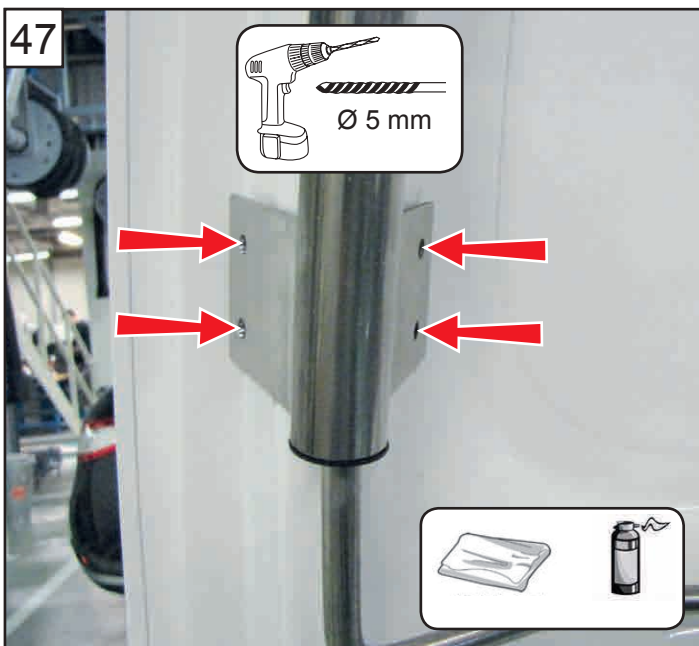
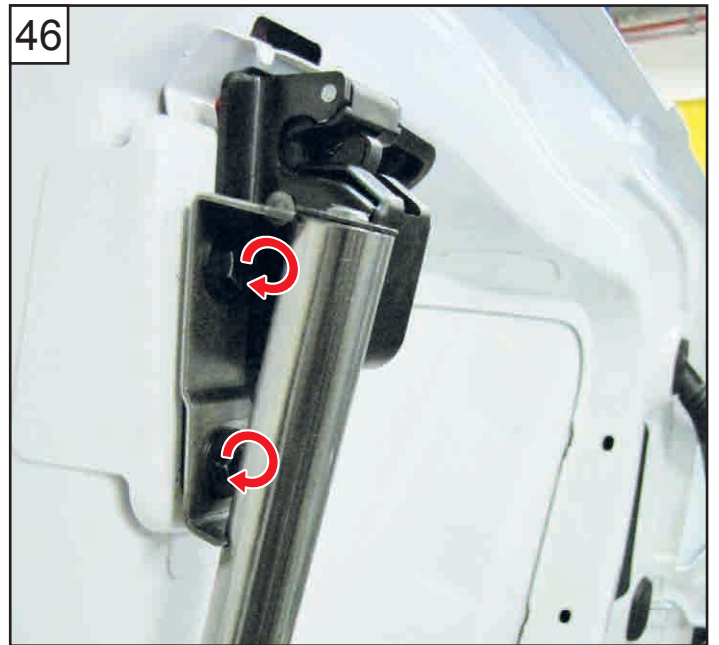
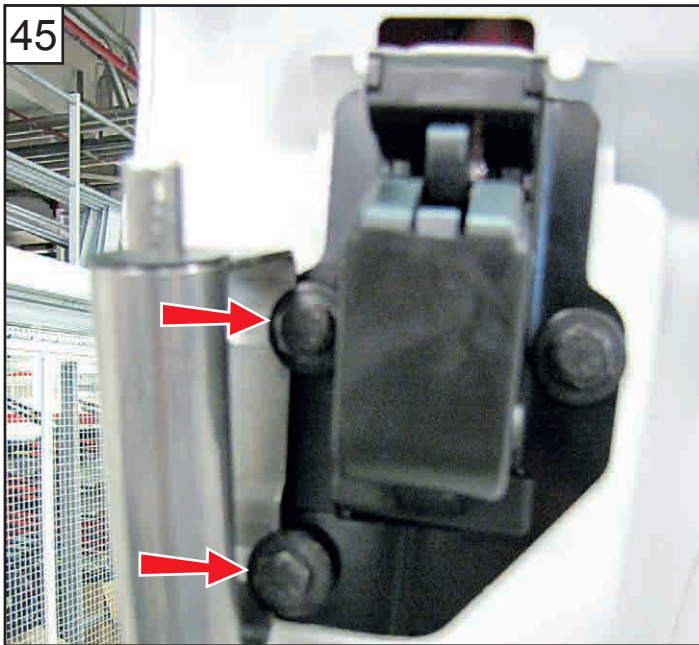
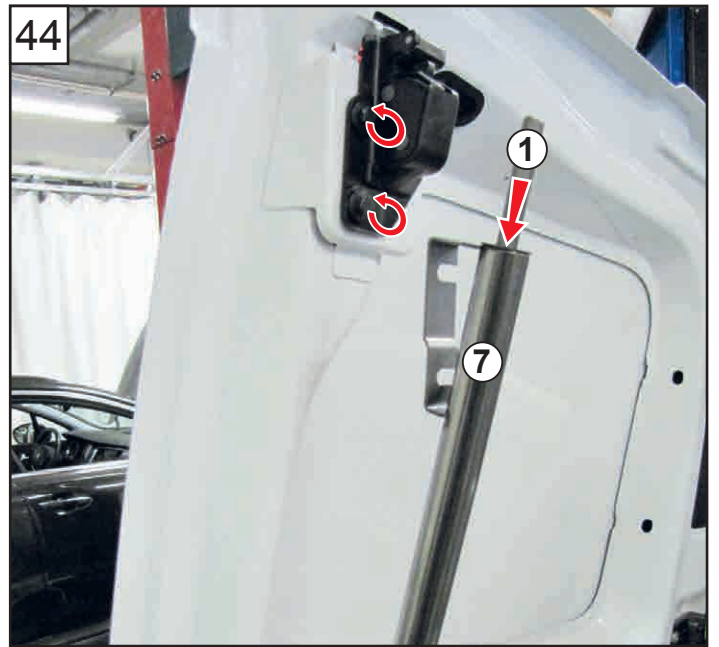
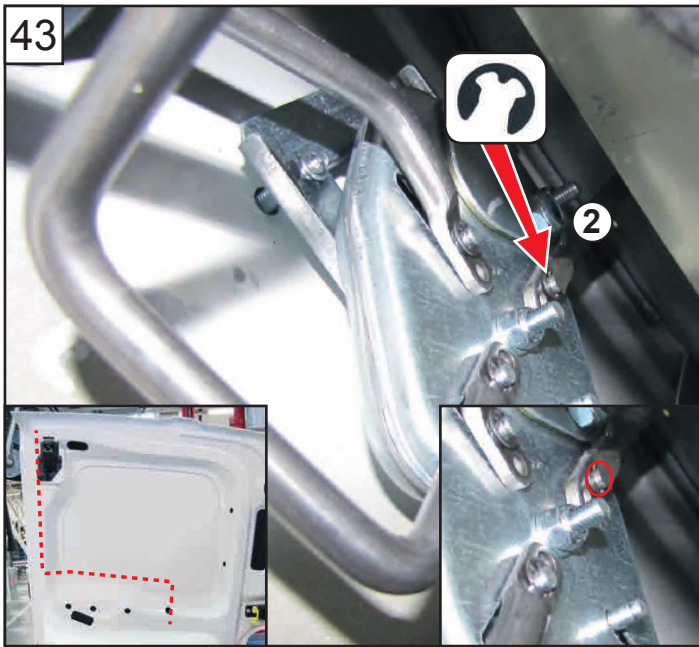

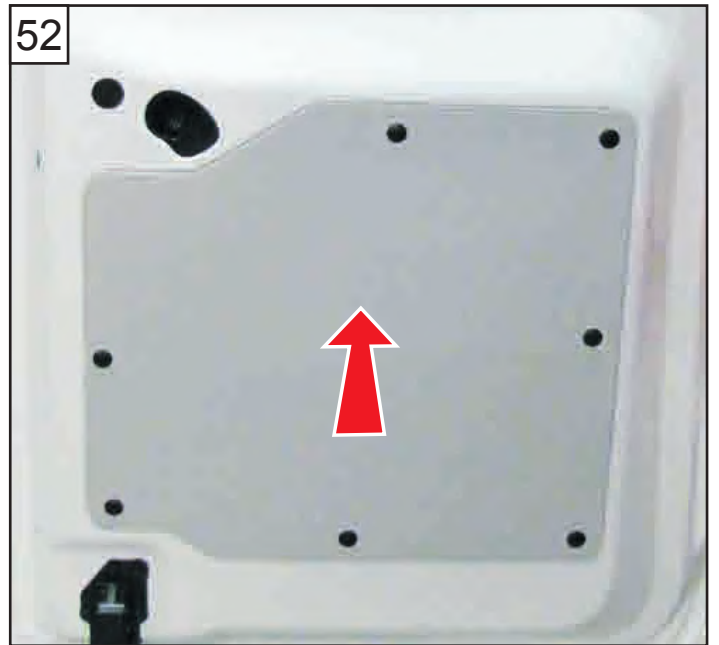
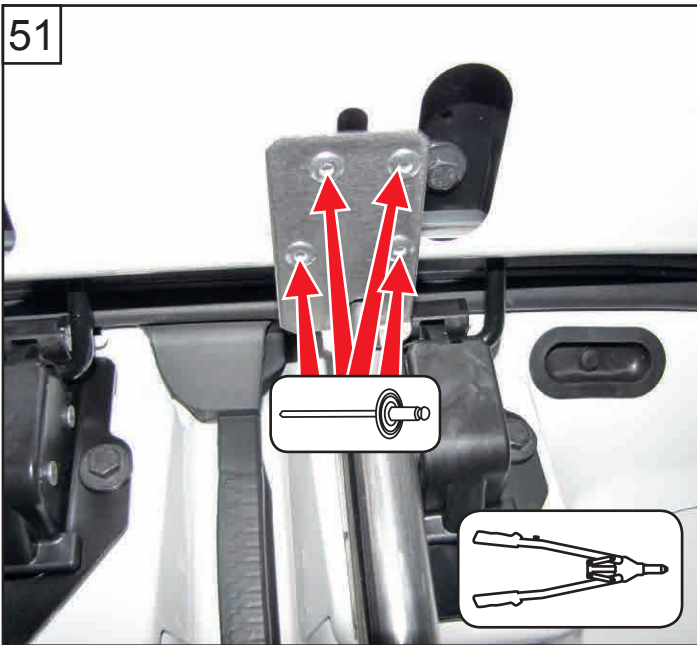
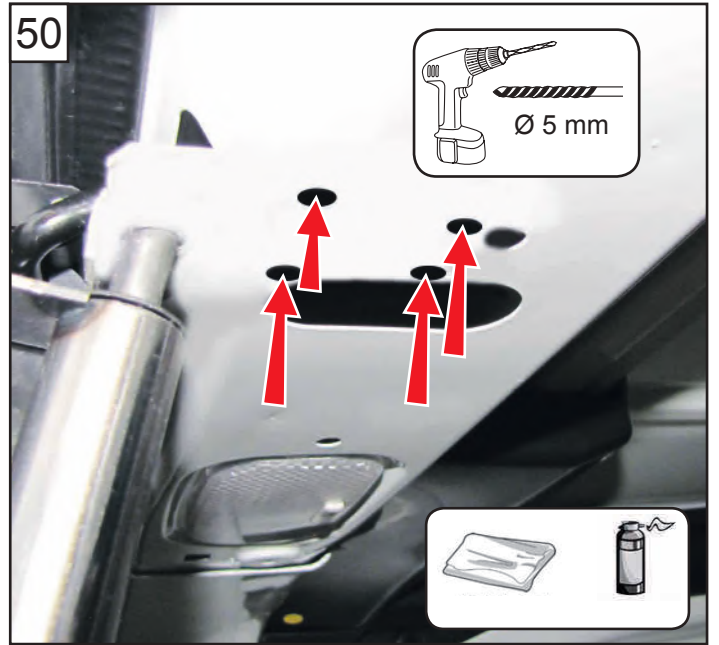
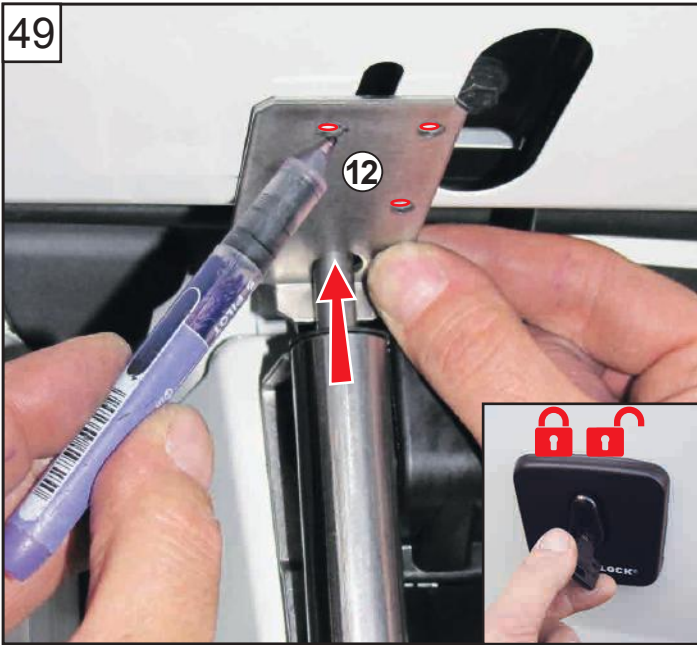

54

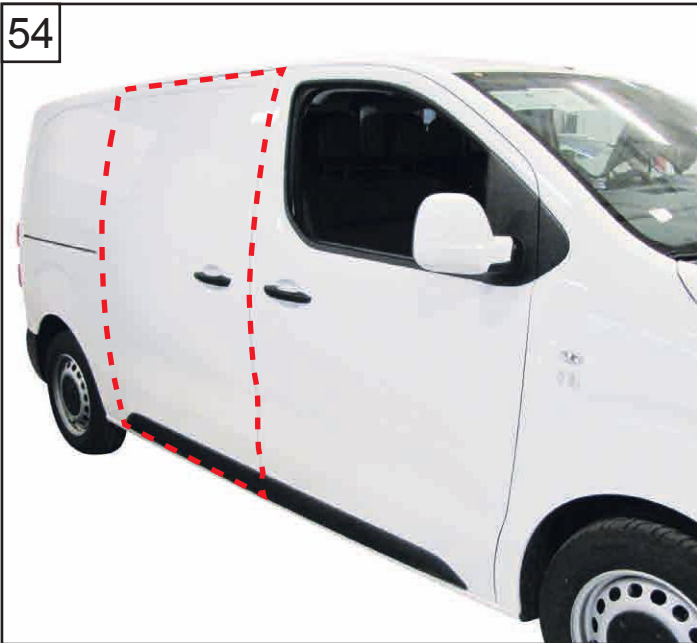

55



56

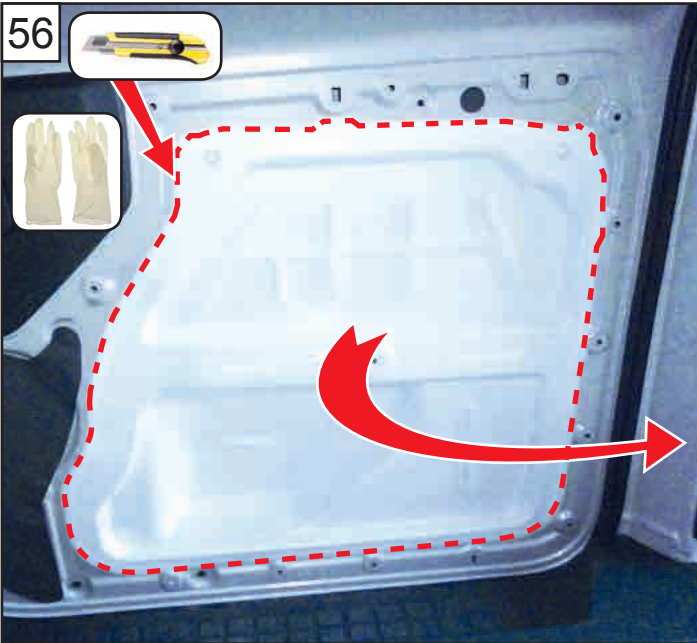

57

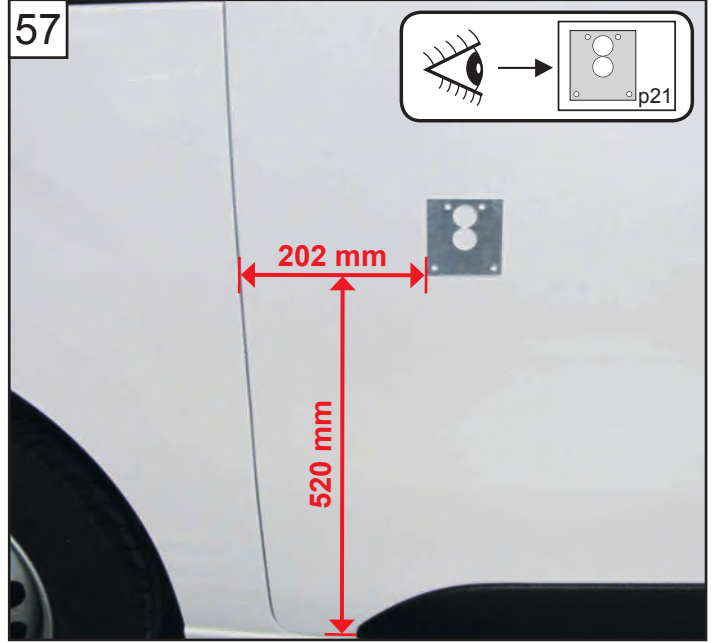

58

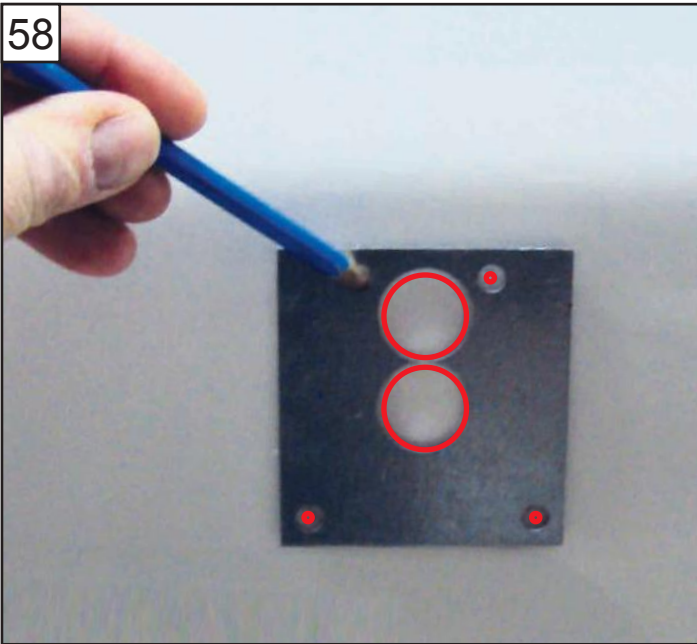

59

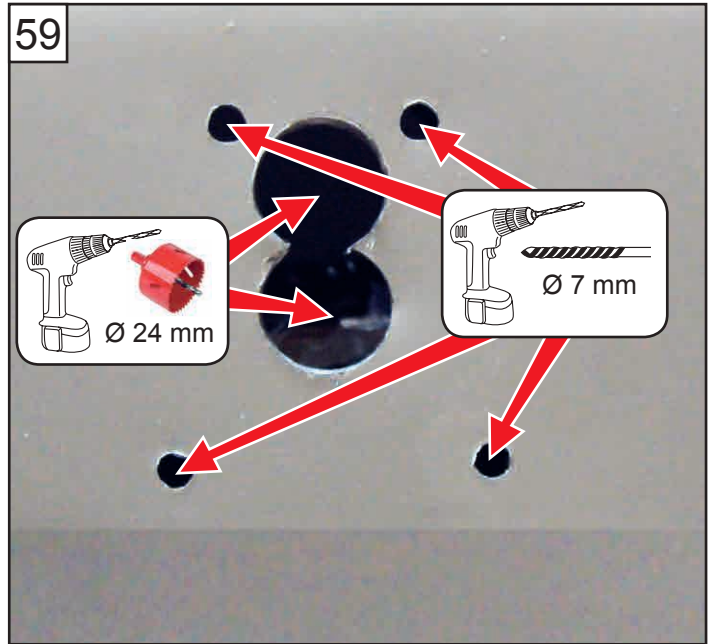

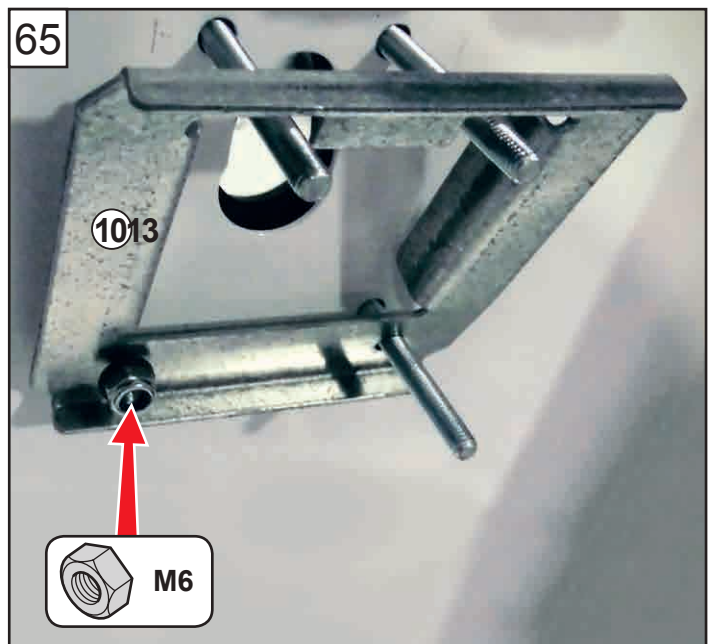
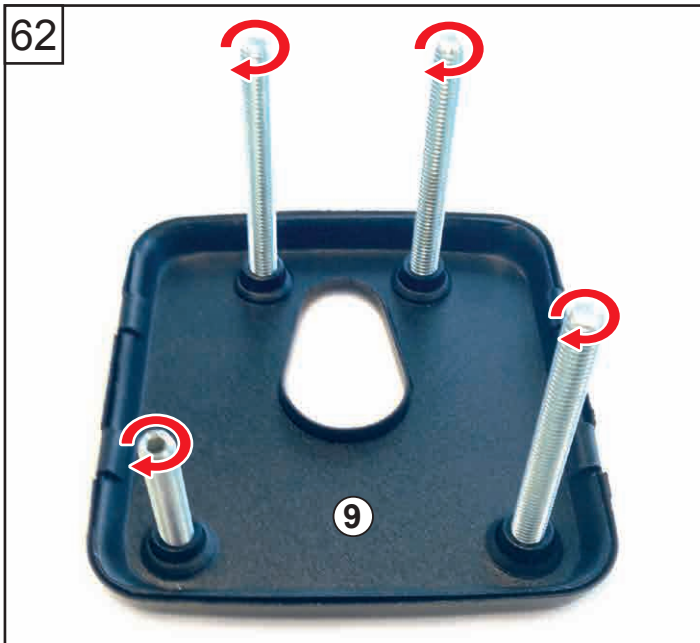
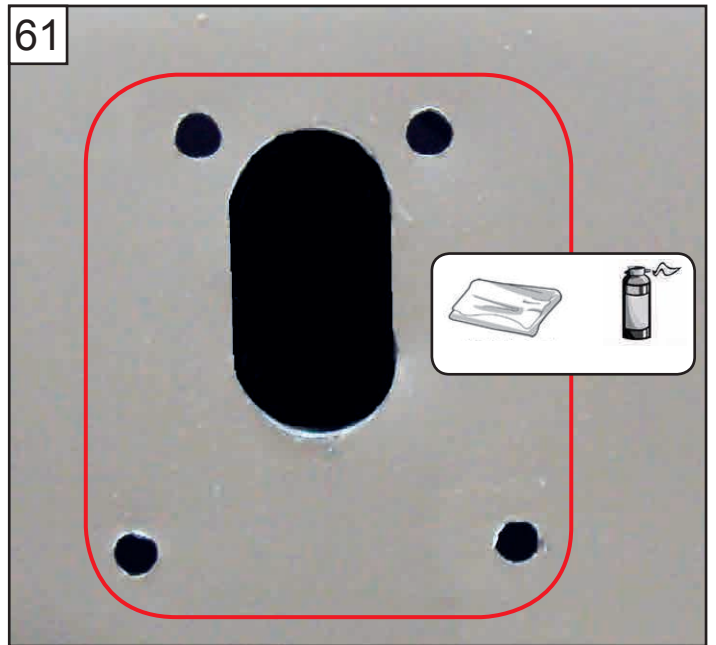
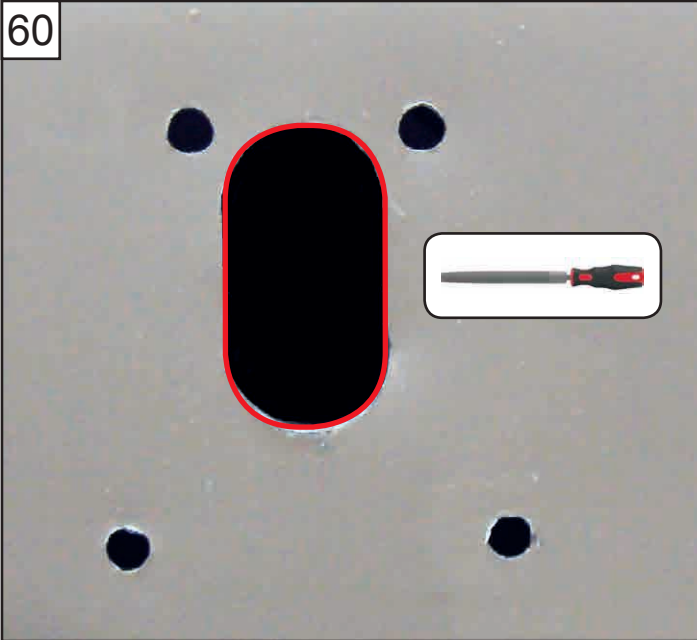

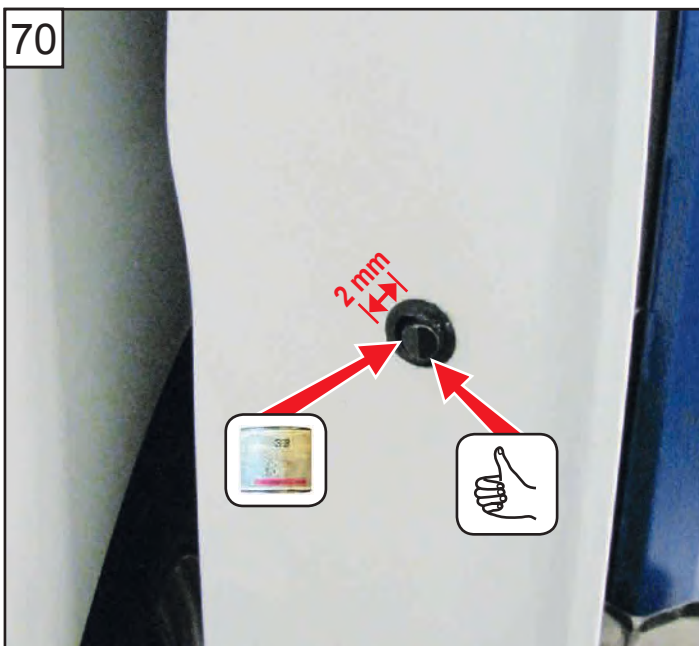
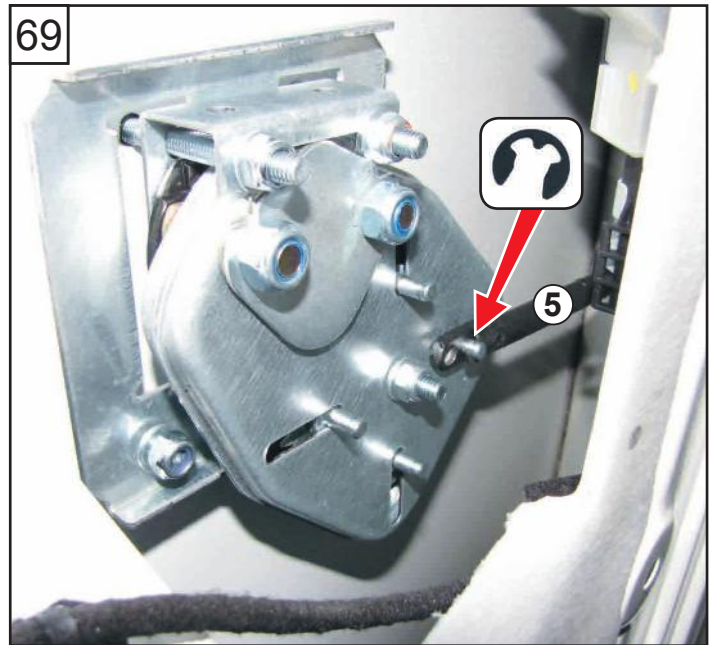
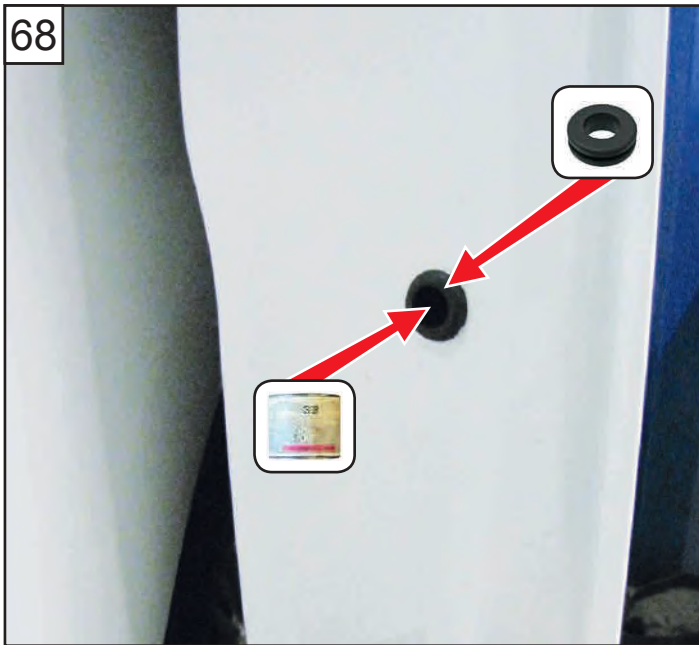
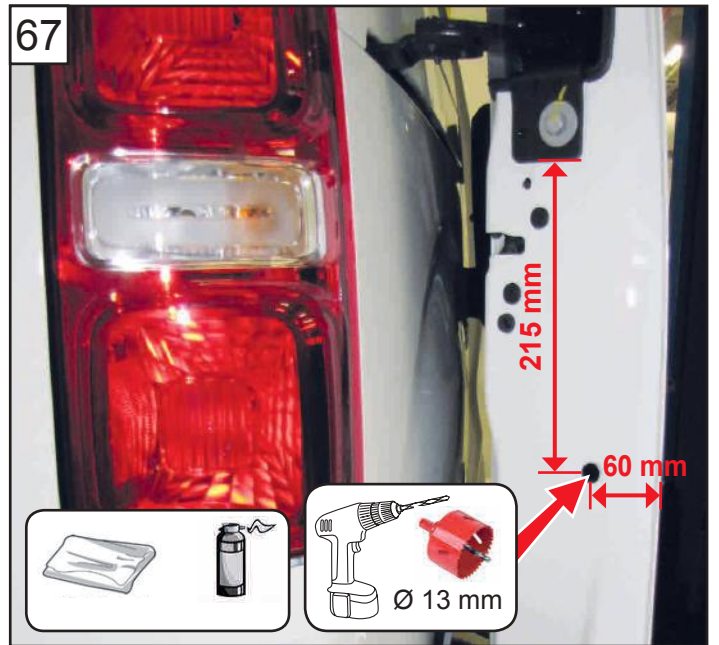
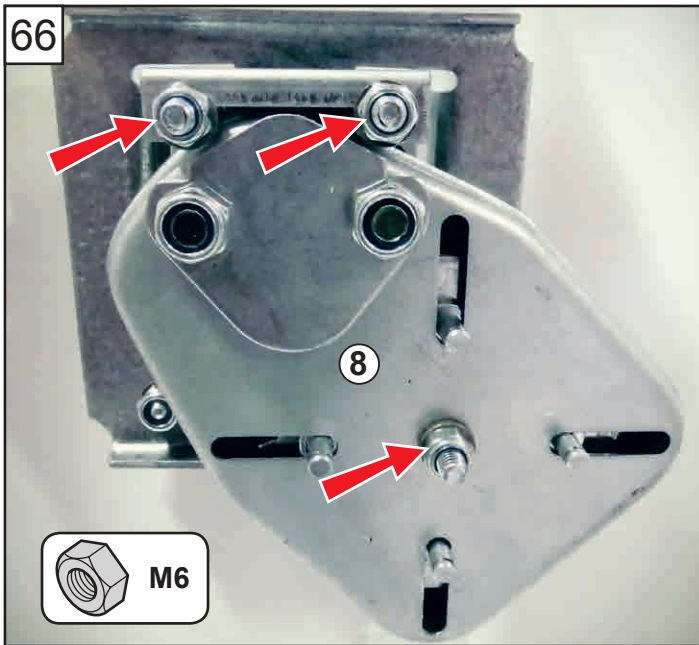

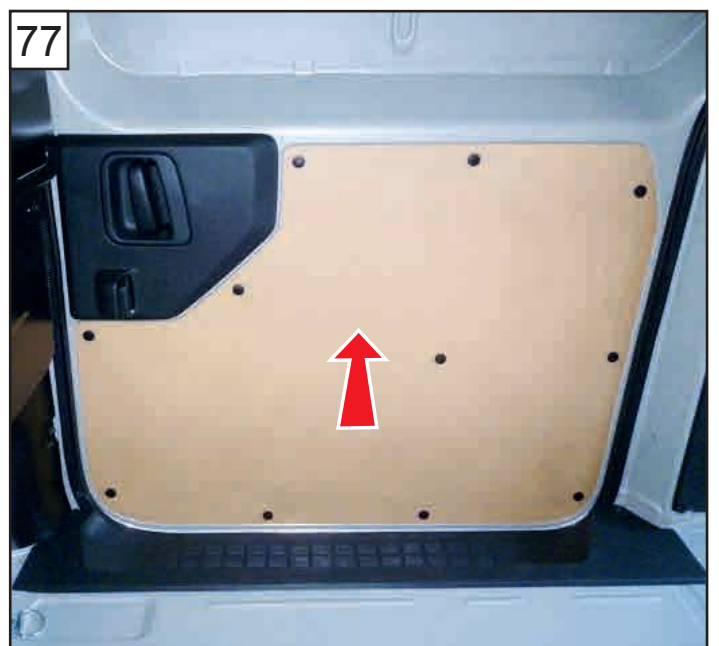
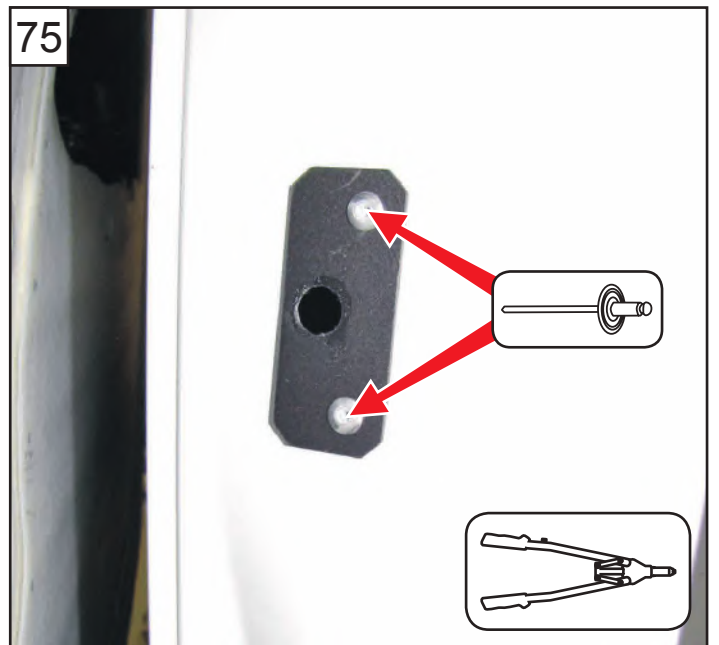
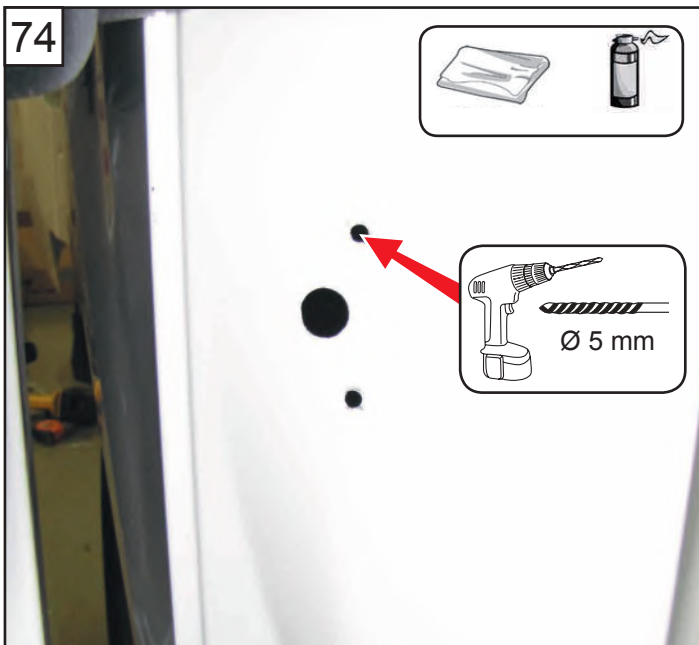
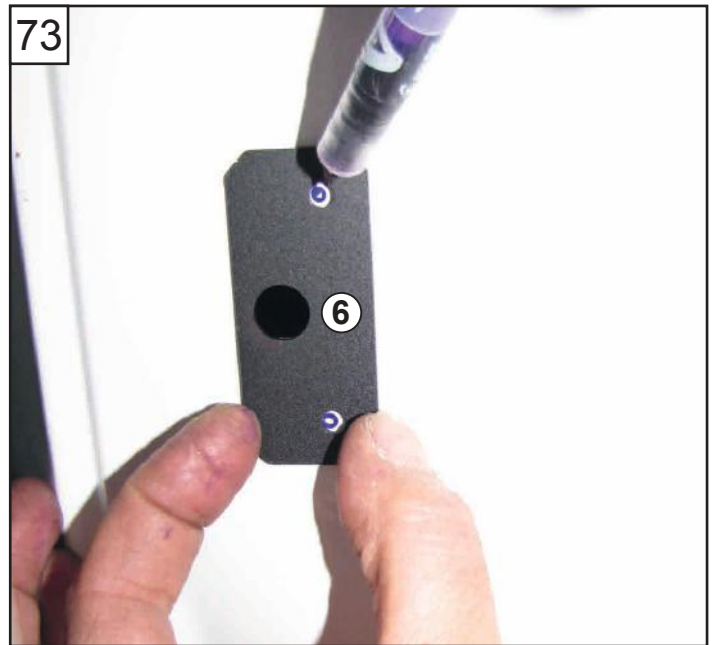
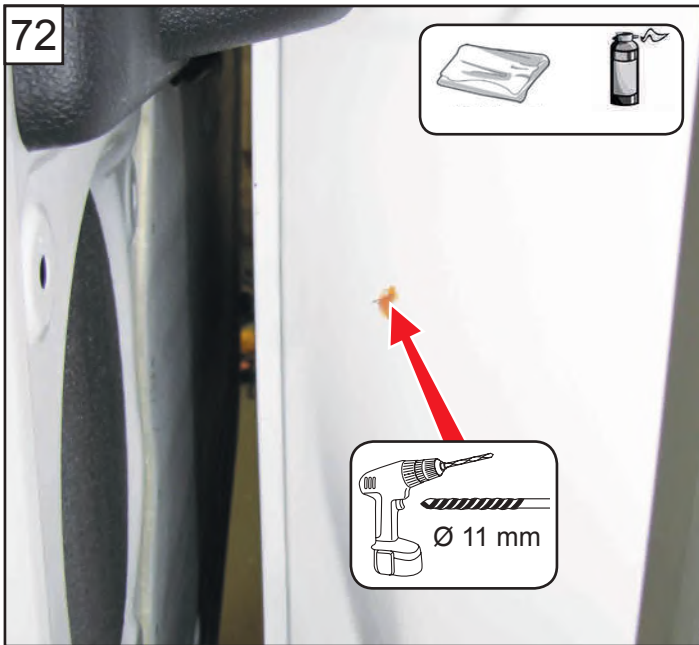

# MONTAGE DU KIT 1 POINT

78

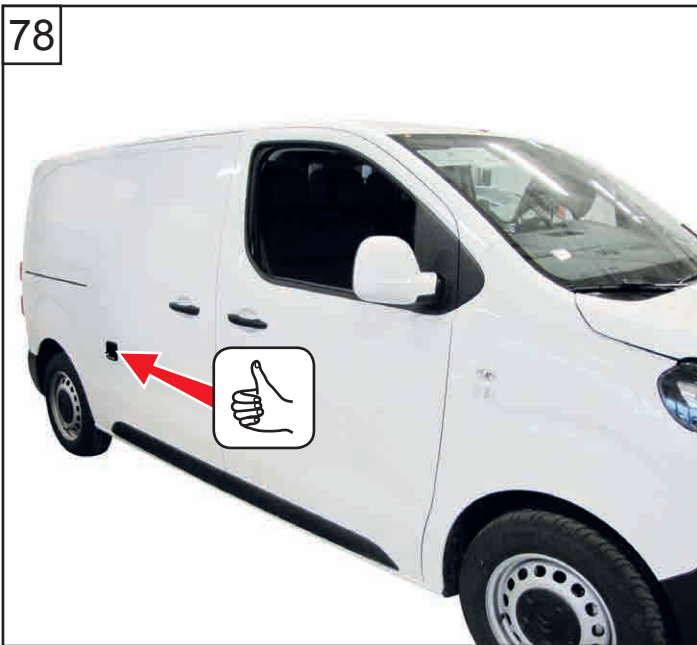

79

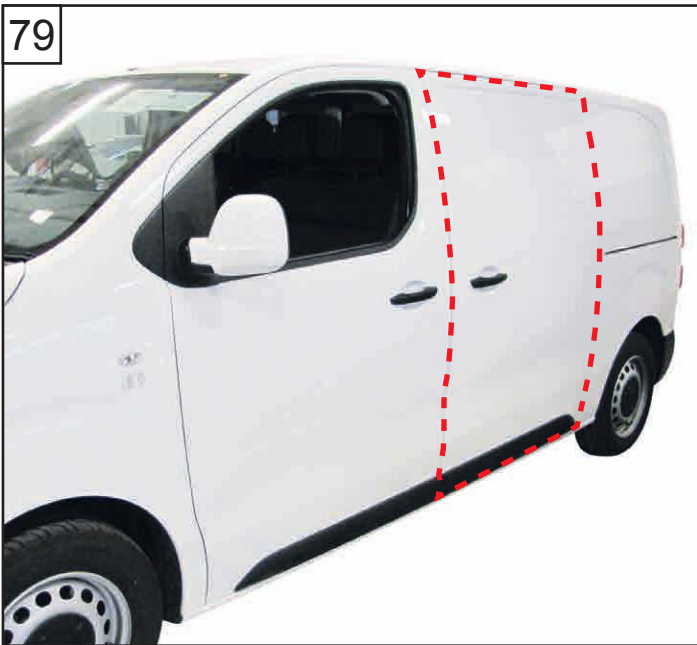

80

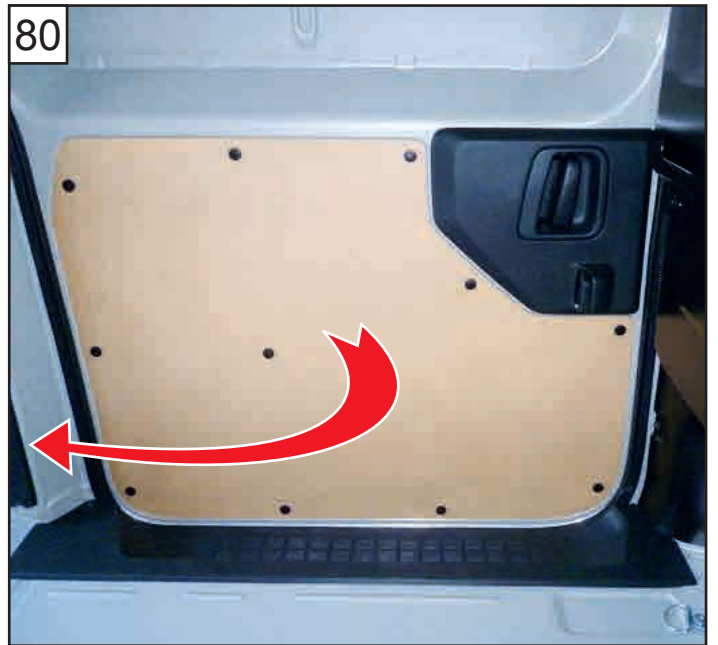

81

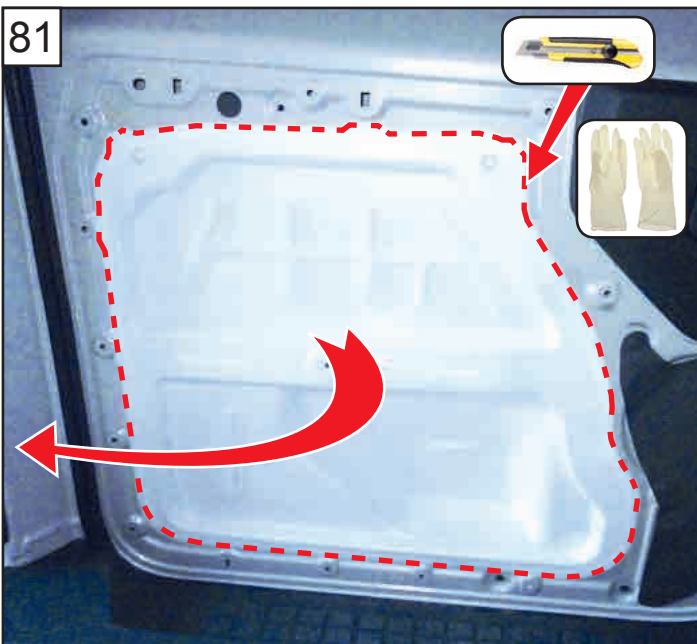

82

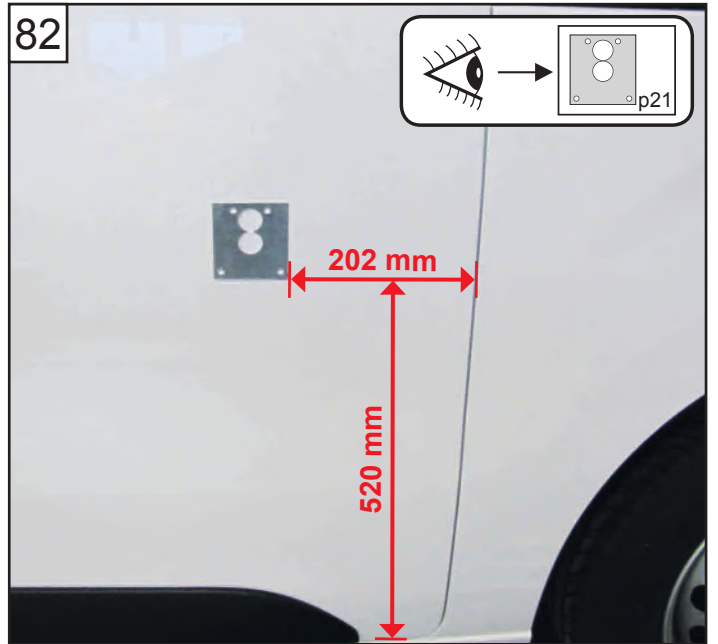



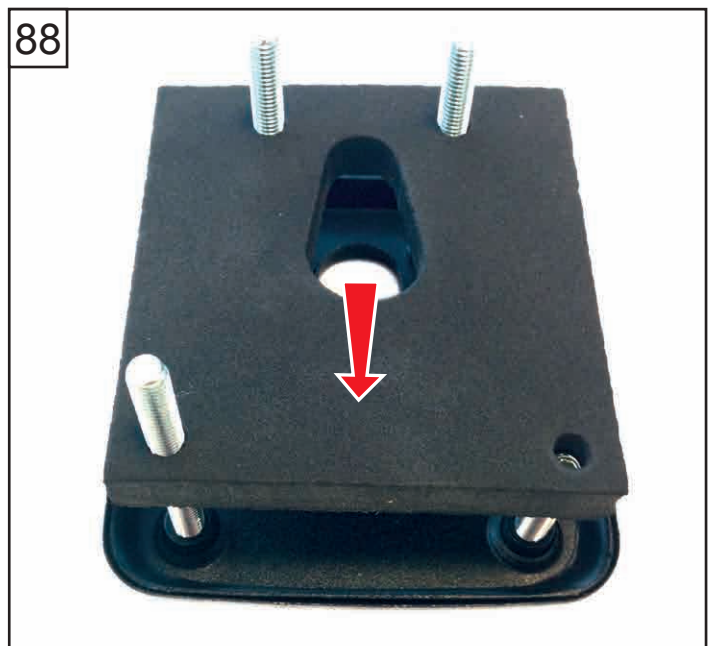
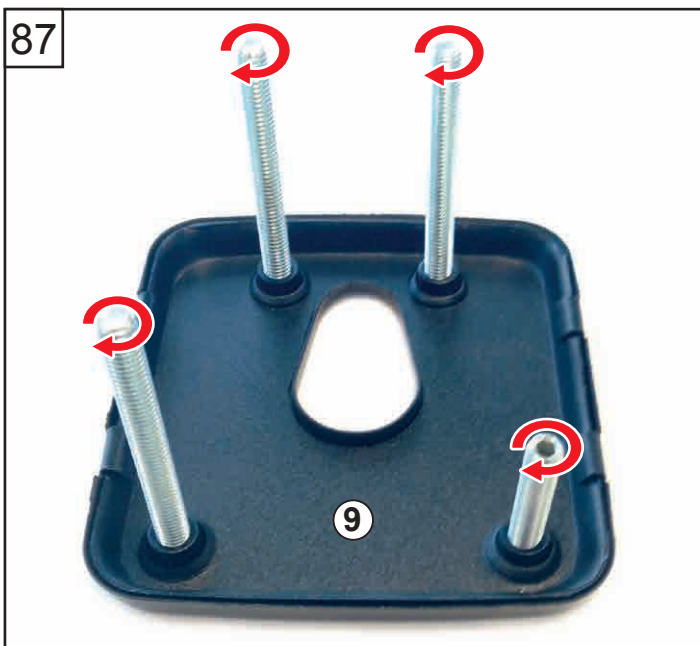
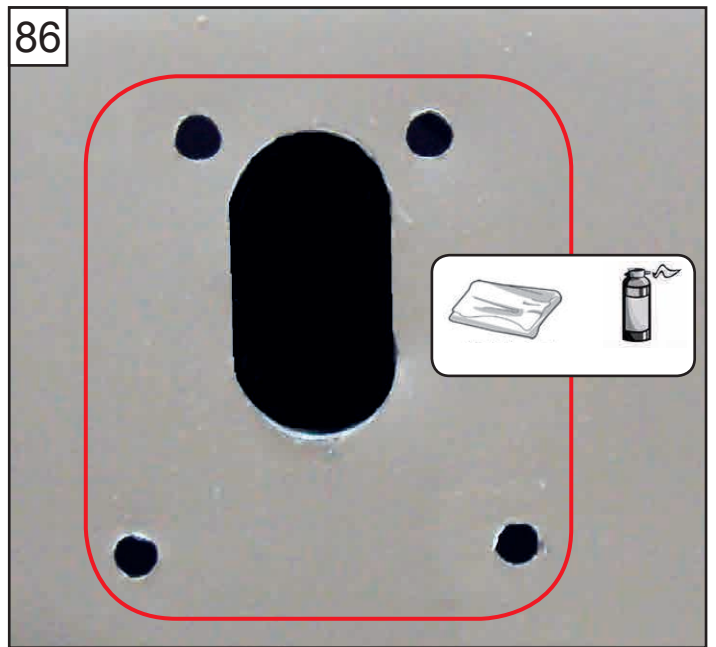
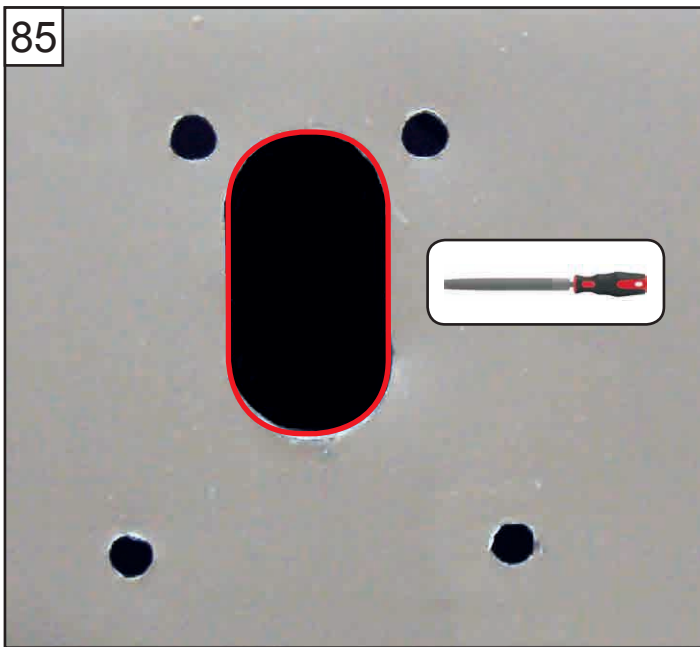
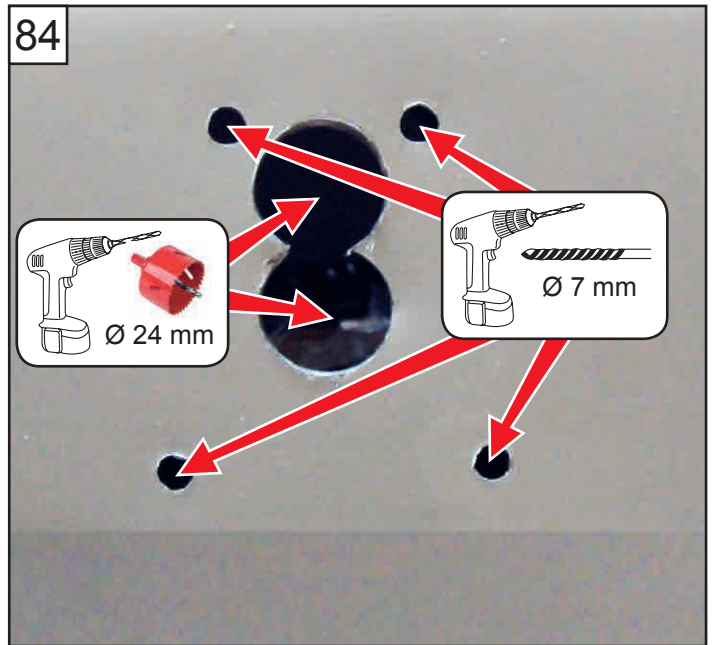
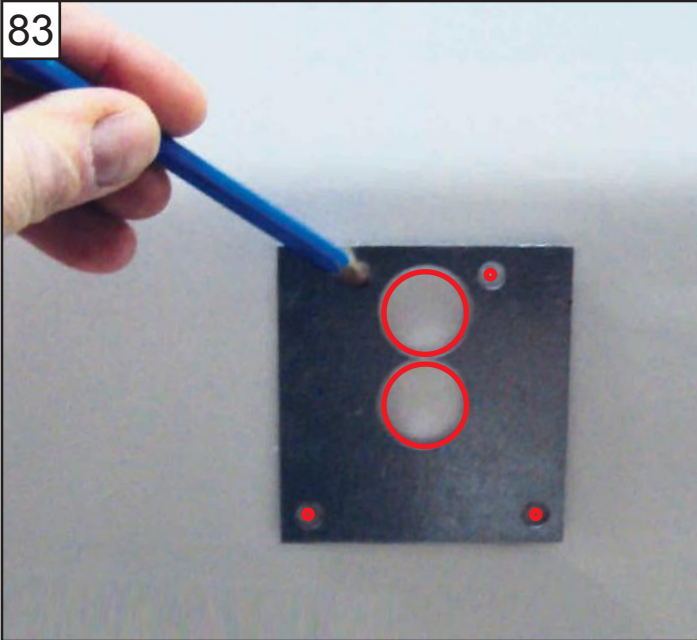

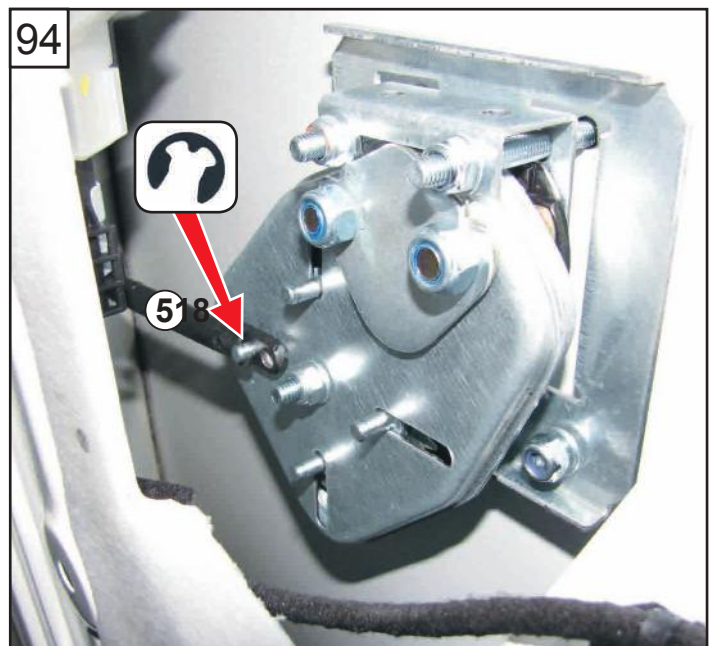
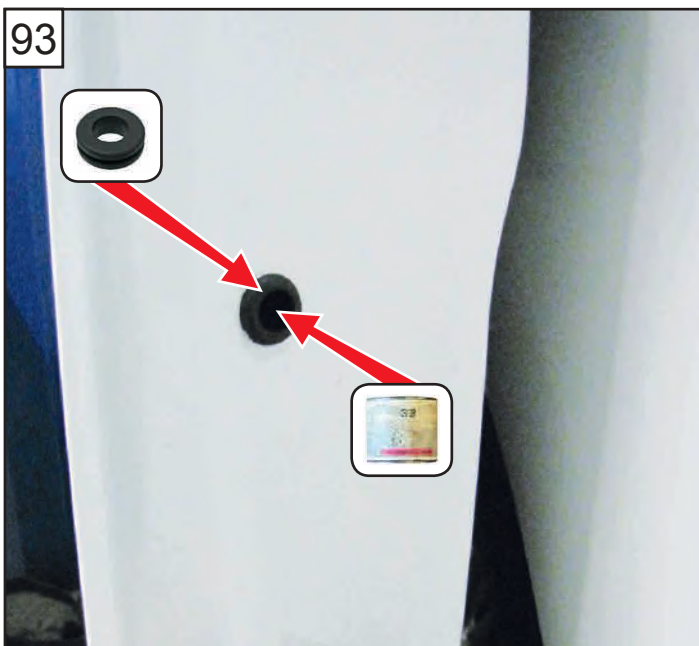
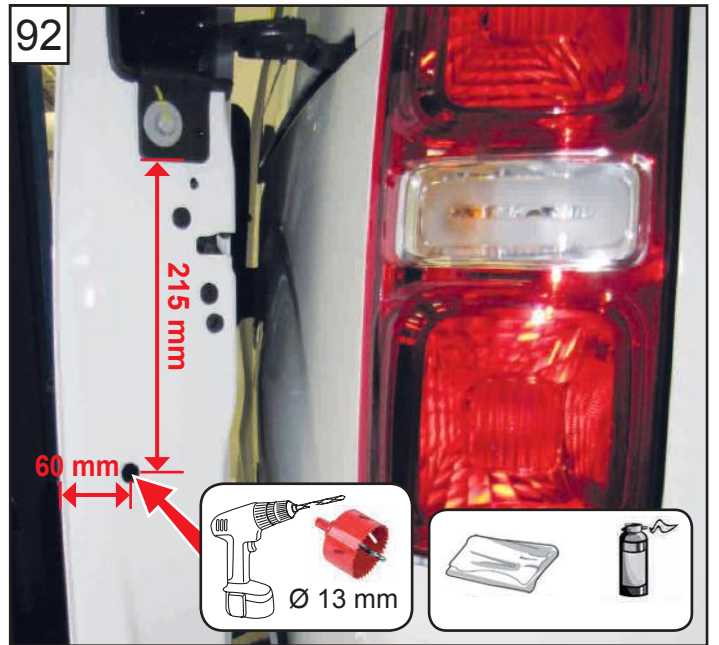
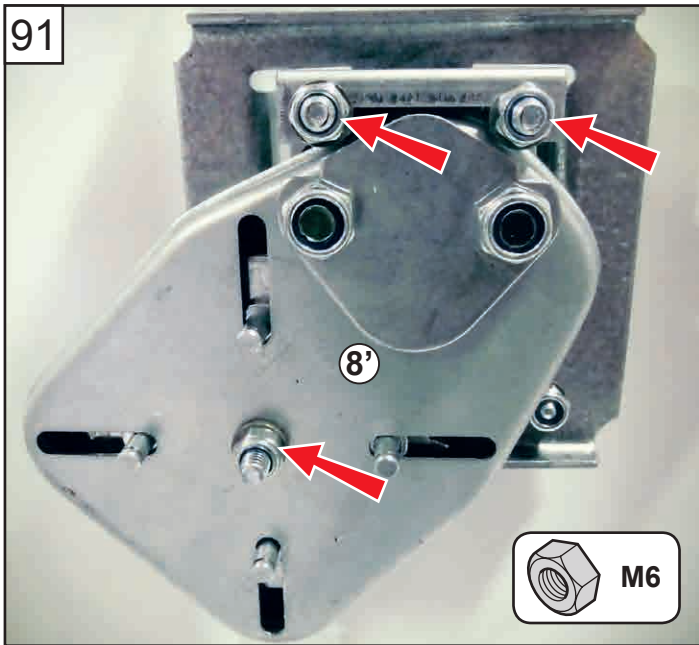
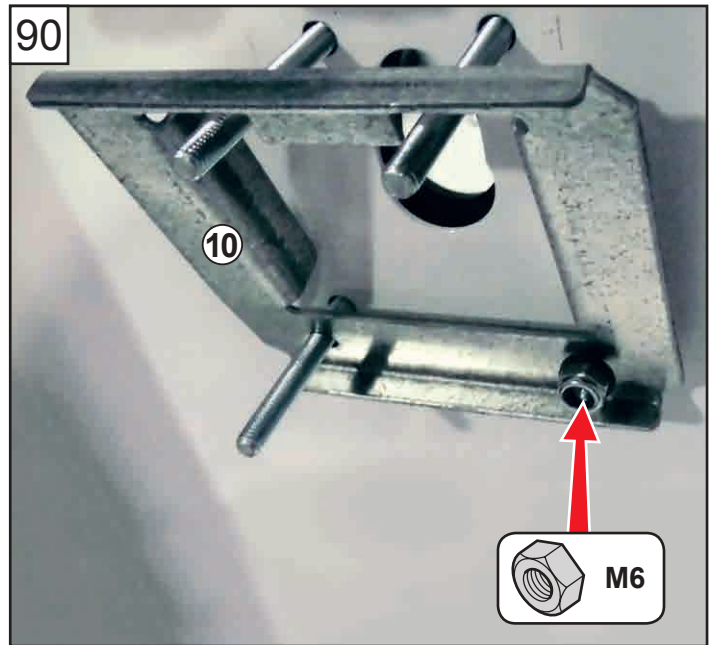

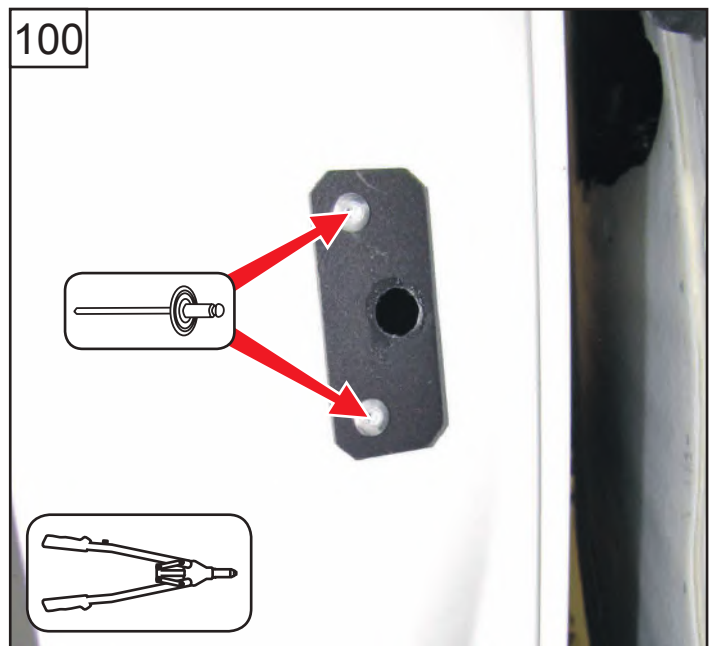
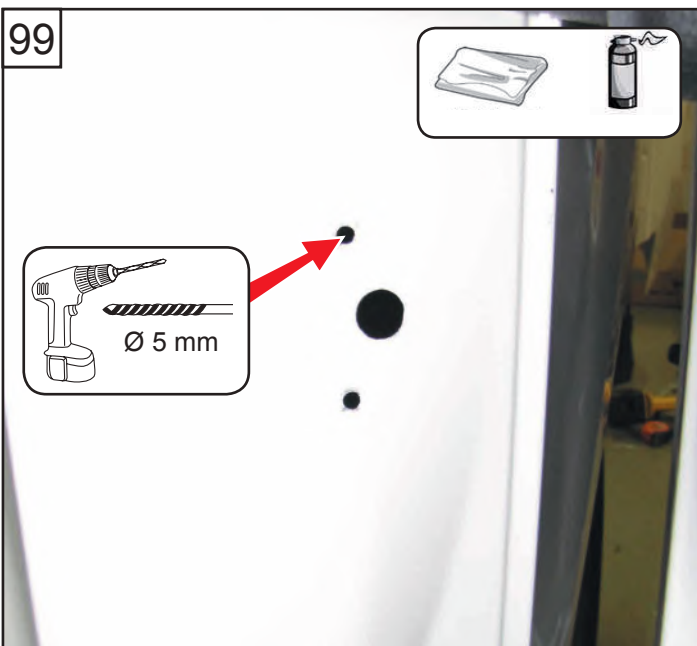
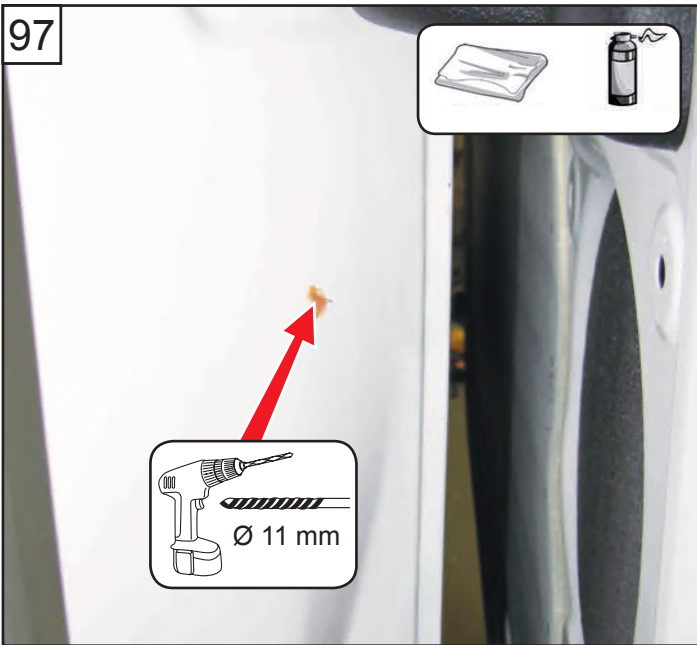
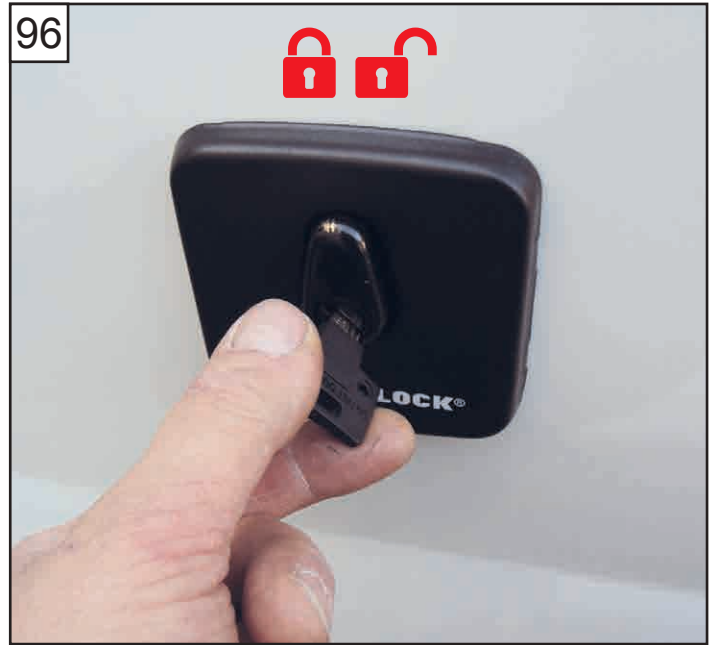
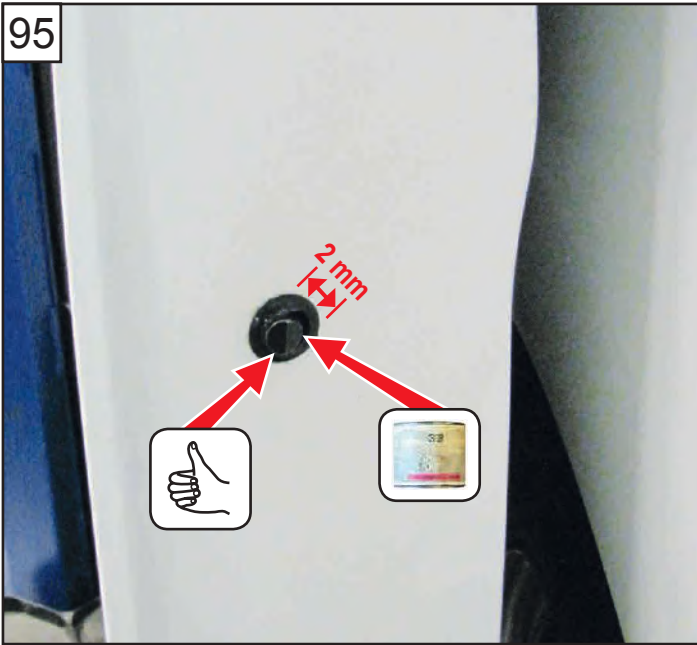

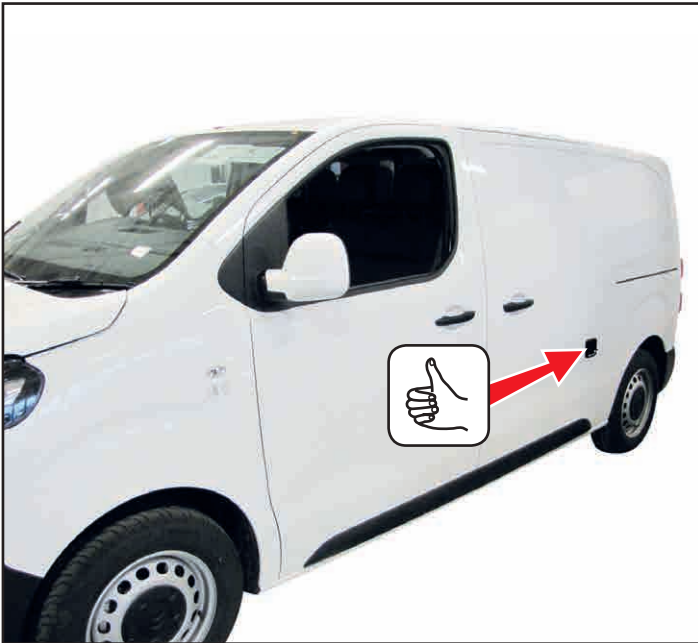
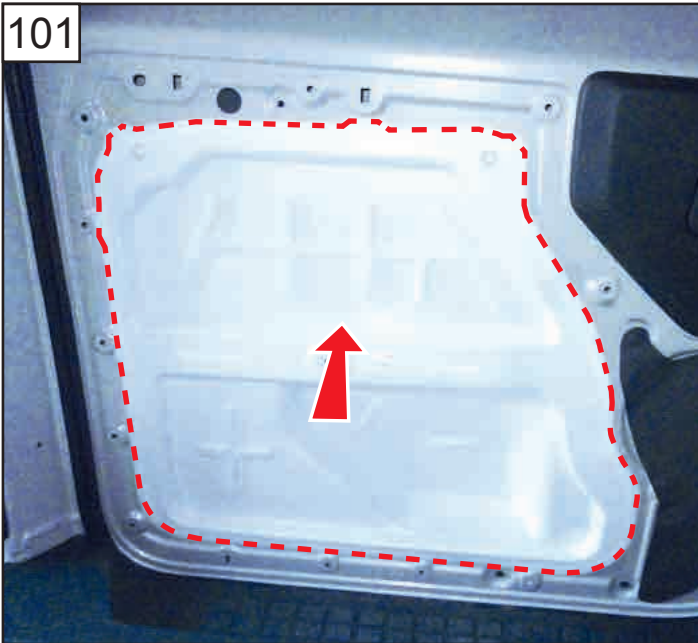

## GABARIT DE PERCAGE—SERRURE MUL-T-LOCK

- 1- Imprimer le Gabarit et vérifier l'échelle avant de l'utiliser
- 2- Découper le contour de la zone grise comme indiqué
- 3- Positionner le gabarit selon les indications de la notice
- 4- Repérer les points de perçage
- 5- Effectuer le perçage

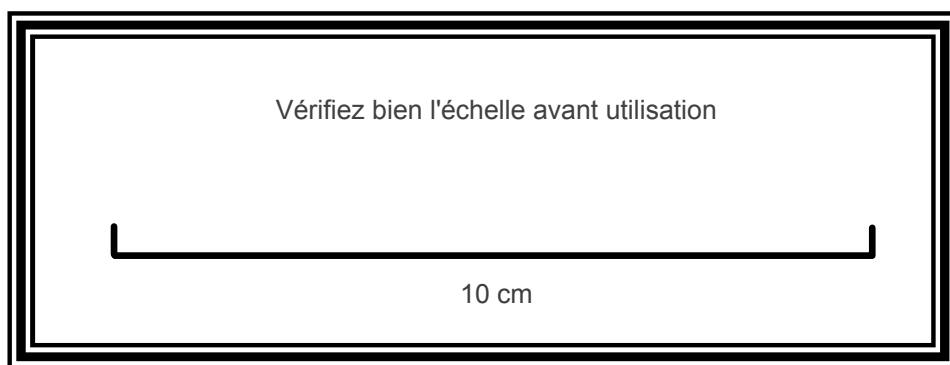
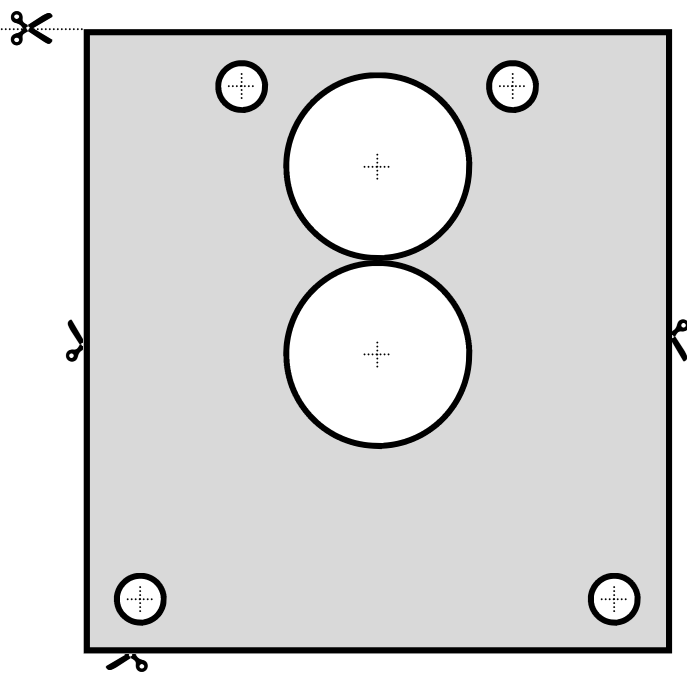





**DIVISION AUTOMOBILE MUL-T-LOCK**

**533 AVENUE DU GENERAL DE GAULLE**

**92140 CLAMART**

**Tél : 01 41 28 39 70**

**Fax : 01 69 53 01 85**

**[www.mul-t-lock.com](http://www.mul-t-lock.com)**

**Support commercial**

**01.41.28.39.70**

**[adv@mul-t-lock.fr](mailto:adv@mul-t-lock.fr)**

**Support technique**

**06.62.91.58.58**

**[automobile@mul-t-lock.fr](mailto:automobile@mul-t-lock.fr)**



Une marque du Groupe ASSA ABLOY

**ASSA ABLOY**

La marque Mul-T-Lock® et le logo "muscleman", et tout autre nom, marque ou logo utilisés par Mul-T-Lock® et signalés par l'un des symboles ® ou ™ sont enregistrés ou en passe de l'être en tant que marques déposées de Mul-T-Lock® Ltd. dans différents pays. Mul-T-Lock® se réserve le droit de procéder à des améliorations ou des modifications à ses produits sans aucun préavis. Mul-T-Lock® Technologies Ltd. 2016 ©